

SHEET 2 OF 3  
JOB NO. 06043-06

BOUNDARY AND TOPOGRAPHIC SURVEY  
PART OF RUSSIA TOWNSHIP ORIGINAL LOT NO. 86  
AND PART OF ORIGINAL PLATS OF OBERLIN AS  
RECORDED IN VOL. 1 P. 18 AND VOL. 5 P. 30  
CITY OF OBERLIN, COUNTY OF LORAIN, STATE OF OHIO

**KS**  
KS ASSOCIATES  
KS Associates, Inc.  
260 Burns Road, Suite 100  
Elyria, OH 44035  
P 440 365 4730  
F 440 365 4790  
www.ksassociates.com

DATE	DESCRIPTION	BY

NOTES:  
1. ALL WORK SHOWN IS BASED ON THE INFORMATION PROVIDED BY THE CLIENT.  
2. ALL WORK IS TO BE ACCORDING TO THE LATEST EDITION OF THE SURVEYING MANUAL.  
3. THE CLIENT IS RESPONSIBLE FOR OBTAINING ALL NECESSARY PERMITS.  
4. THE CLIENT IS RESPONSIBLE FOR OBTAINING ALL NECESSARY RECORDS.  
5. THE CLIENT IS RESPONSIBLE FOR OBTAINING ALL NECESSARY RECORDS.

SITE SURVEY DRAWING

C1.0

2012007

OBERLIN COLLEGE  
GATEWAY BUILDING

NO.	DATE	REVISION	BY

CONTRACT DOCUMENT  
PROGRESS SET  
03.31.14

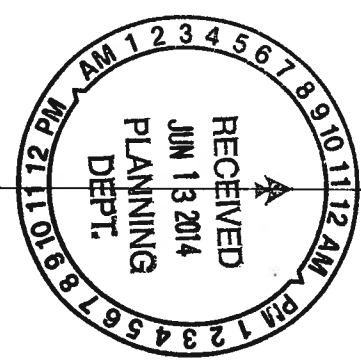

NEFF ASSOCIATES  
ARCHITECTURE PLANNING INTERIOR DESIGN  
Solomon Cowwell Buertz  
www.scb.com  
Office: 312.986.1100  
San Francisco: 415.718.2400

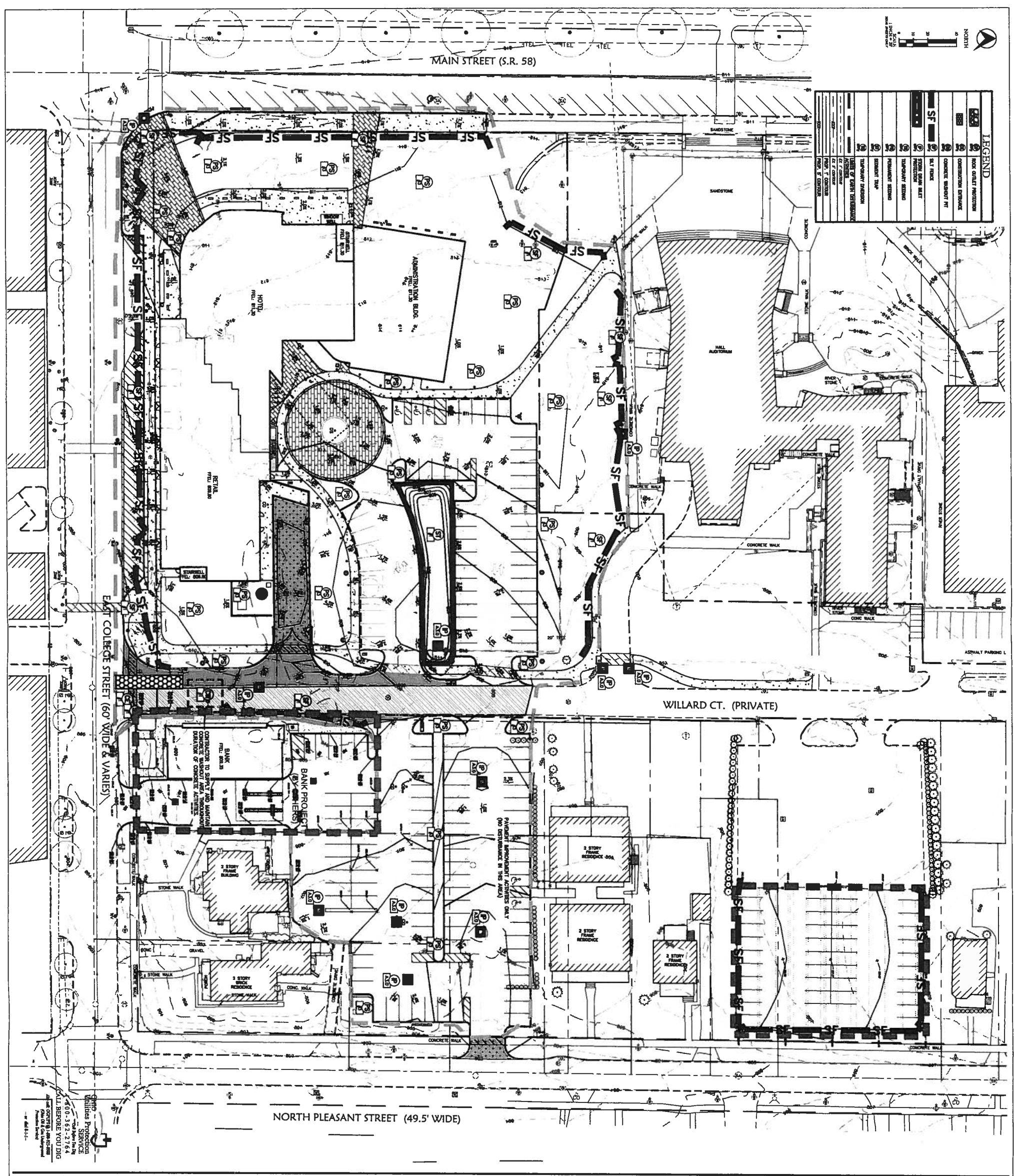

LEGEND	
[Symbol]	NOX GLEET PROVISION
[Symbol]	CONSTRUCTION MATERIAL
[Symbol]	CONCRETE SANDWICH PT
[Symbol]	AS TYPICAL
[Symbol]	STONE SLAB W/LET
[Symbol]	CONCRETE SANDWICH PT
[Symbol]	TEMPORARY SEASON
[Symbol]	PERMANENT SEASON
[Symbol]	SEASONAL TYP
[Symbol]	TEMPORARY DIVISION
[Symbol]	PERMANENT DIVISION
[Symbol]	EXISTING
[Symbol]	PROJ. 1 CONSTRUCTION
[Symbol]	PROJ. 2 CONSTRUCTION
[Symbol]	PROJ. 3 CONSTRUCTION
[Symbol]	PROJ. 4 CONSTRUCTION
[Symbol]	PROJ. 5 CONSTRUCTION



**SMP3 - EROSION & SED. CONTROL PLAN**

Drawn By: \_\_\_\_\_

Checked By: \_\_\_\_\_

Date: \_\_\_\_\_

Project Number: **2012007**

**C2.2**

**NEFF**  
ARCHITECTS

1140 Walnut Street, Suite 200  
Oberlin, Ohio 44872-2000  
Tel: 419.338.2100  
Fax: 419.338.2101  
www.neffarchitects.com

Architectural Planning Interior Design

NO.	DATE	DESCRIPTION
1	11/14/07	ISSUED FOR BIDDING PURPOSE
2	01/22/08	ISSUED FOR ADDENDUM NO. 1
3	02/12/08	CONTRACT PROVISIONS SET
4	02/27/08	ISSUED FOR PERMITS
5	03/11/08	ISSUED FOR PERMITS
6	03/11/08	ISSUED FOR PERMITS
7	03/11/08	ISSUED FOR PERMITS
8	03/11/08	ISSUED FOR PERMITS
9	03/11/08	ISSUED FOR PERMITS
10	03/11/08	ISSUED FOR PERMITS

Oberlin, Ohio  
 9 2012 Oberlin, Ohio  
**OBERLIN COLLEGE  
 GATEWAY BUILDING**



Temporary Sealing **(TS)**

Description

Temporary sealing methods are used to seal a structure or component for a period of time. Temporary sealing methods are used to seal a structure or component for a period of time. Temporary sealing methods are used to seal a structure or component for a period of time.

Table with columns: Sealing Method, Standard, Lb./1000 Sq. Ft., Lb./Line, and Remarks. Rows include 'Sealing with Gaskets', 'Sealing with Sealant', etc.

Table 1. Temporary Sealing Methods

- 1. Sealing methods are used to seal a structure or component for a period of time. Temporary sealing methods are used to seal a structure or component for a period of time.

(N)

- 1. Sealing methods are used to seal a structure or component for a period of time. Temporary sealing methods are used to seal a structure or component for a period of time.

Permanent Sealing **(PS)**

Description

Permanent sealing methods are used to seal a structure or component for a permanent period. Permanent sealing methods are used to seal a structure or component for a permanent period.

Table with columns: Sealing Method, Standard, Lb./1000 Sq. Ft., Lb./Line, and Remarks. Rows include 'Sealing with Gaskets', 'Sealing with Sealant', etc.

Logos and contact information for Solomon Cordwell Buenz and NEFF Architecture Planning Interiors Design.

Project details including 'OBERLIN COLLEGE GATEWAY BUILDING', 'Oberlin, Ohio', and 'SWP3 DETAILS'.

Ohio Utilities Protection Service logo and contact information.

Ohio Utilities Protection Service logo and contact information.

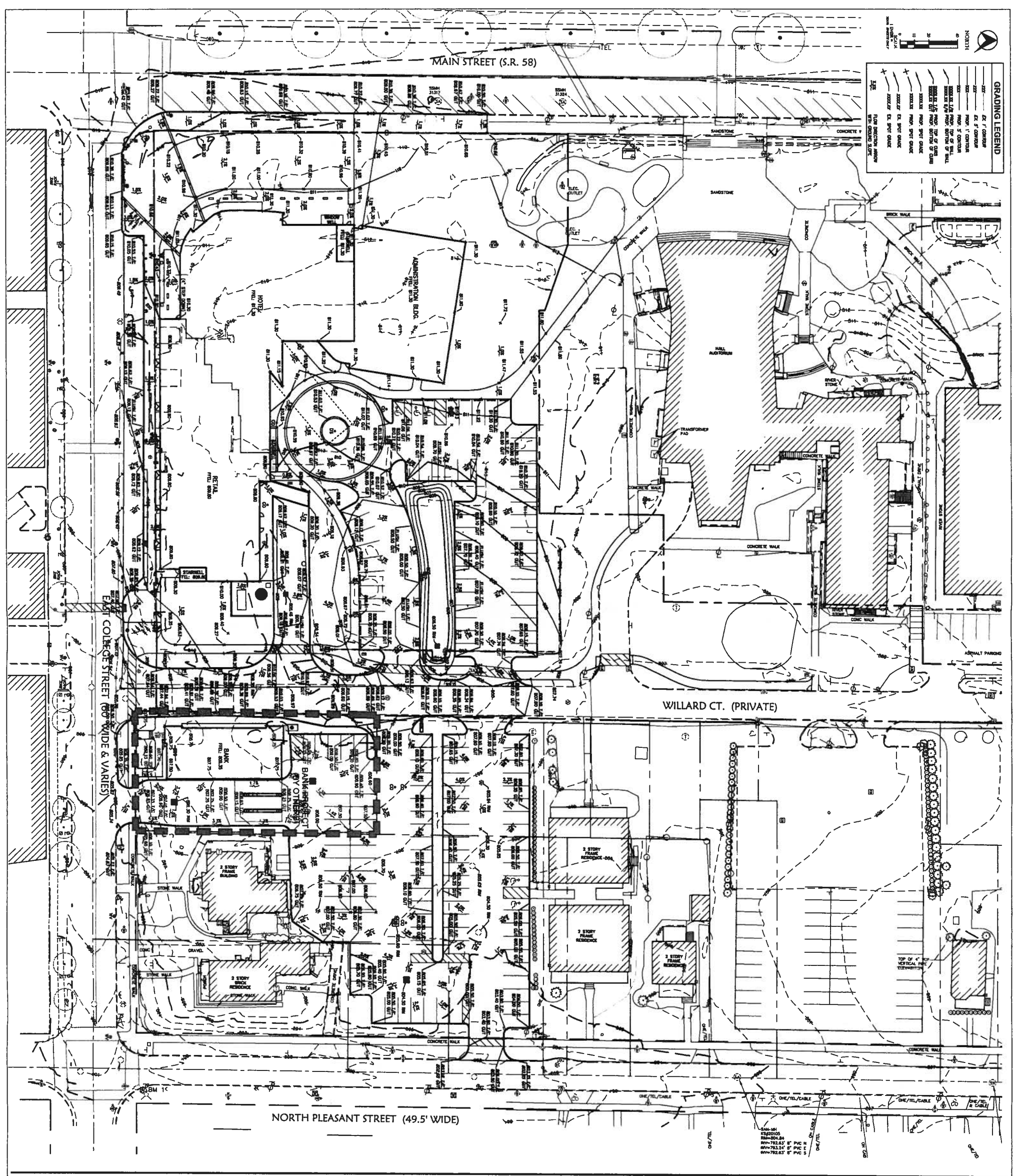

**GRADING LEGEND**

- 2" CONCRETE
- 4" CONCRETE
- 6" CONCRETE
- 8" CONCRETE
- SANDSTONE
- BRICK WALK
- CONCRETE WALK
- ASPHALT PARKING
- RETAINING WALL
- 12" SANDSTONE
- 18" SANDSTONE
- 24" SANDSTONE
- 30" SANDSTONE
- 36" SANDSTONE
- 42" SANDSTONE
- 48" SANDSTONE
- 54" SANDSTONE
- 60" SANDSTONE
- 66" SANDSTONE
- 72" SANDSTONE
- 78" SANDSTONE
- 84" SANDSTONE
- 90" SANDSTONE
- 96" SANDSTONE
- 102" SANDSTONE
- 108" SANDSTONE
- 114" SANDSTONE
- 120" SANDSTONE
- 126" SANDSTONE
- 132" SANDSTONE
- 138" SANDSTONE
- 144" SANDSTONE
- 150" SANDSTONE
- 156" SANDSTONE
- 162" SANDSTONE
- 168" SANDSTONE
- 174" SANDSTONE
- 180" SANDSTONE
- 186" SANDSTONE
- 192" SANDSTONE
- 198" SANDSTONE
- 204" SANDSTONE
- 210" SANDSTONE
- 216" SANDSTONE
- 222" SANDSTONE
- 228" SANDSTONE
- 234" SANDSTONE
- 240" SANDSTONE
- 246" SANDSTONE
- 252" SANDSTONE
- 258" SANDSTONE
- 264" SANDSTONE
- 270" SANDSTONE
- 276" SANDSTONE
- 282" SANDSTONE
- 288" SANDSTONE
- 294" SANDSTONE
- 300" SANDSTONE

**OBERLIN COLLEGE GATEWAY BUILDING**

Ohio, Ohio  
 0.871 Square Contained Area

**SITE GRADING PLAN**

Drawn By: [Name]  
 Checked By: [Name]  
 Project Number: 2012007

**C3.0**

**NEFF ASSOCIATES**  
 Architects, Planners, Interior Design  
 1111 Broadway, Suite 1100  
 San Francisco, CA 94103  
 415.775.2400

**Solomon Cordwell Buenz**  
 www.scb.com  
 Chicago 312.861.1100  
 San Francisco 415.775.2400

NO.	DATE	DESCRIPTION
1	11/15/07	ISSUED FOR PERMIT REVIEW
2	11/15/07	ISSUED FOR PERMIT REVIEW
3	11/15/07	ISSUED FOR PERMIT REVIEW
4	11/15/07	ISSUED FOR PERMIT REVIEW
5	11/15/07	ISSUED FOR PERMIT REVIEW
6	11/15/07	ISSUED FOR PERMIT REVIEW
7	11/15/07	ISSUED FOR PERMIT REVIEW
8	11/15/07	ISSUED FOR PERMIT REVIEW
9	11/15/07	ISSUED FOR PERMIT REVIEW
10	11/15/07	ISSUED FOR PERMIT REVIEW
11	11/15/07	ISSUED FOR PERMIT REVIEW
12	11/15/07	ISSUED FOR PERMIT REVIEW
13	11/15/07	ISSUED FOR PERMIT REVIEW
14	11/15/07	ISSUED FOR PERMIT REVIEW
15	11/15/07	ISSUED FOR PERMIT REVIEW
16	11/15/07	ISSUED FOR PERMIT REVIEW
17	11/15/07	ISSUED FOR PERMIT REVIEW
18	11/15/07	ISSUED FOR PERMIT REVIEW
19	11/15/07	ISSUED FOR PERMIT REVIEW
20	11/15/07	ISSUED FOR PERMIT REVIEW
21	11/15/07	ISSUED FOR PERMIT REVIEW
22	11/15/07	ISSUED FOR PERMIT REVIEW
23	11/15/07	ISSUED FOR PERMIT REVIEW
24	11/15/07	ISSUED FOR PERMIT REVIEW
25	11/15/07	ISSUED FOR PERMIT REVIEW
26	11/15/07	ISSUED FOR PERMIT REVIEW
27	11/15/07	ISSUED FOR PERMIT REVIEW
28	11/15/07	ISSUED FOR PERMIT REVIEW
29	11/15/07	ISSUED FOR PERMIT REVIEW
30	11/15/07	ISSUED FOR PERMIT REVIEW
31	11/15/07	ISSUED FOR PERMIT REVIEW
32	11/15/07	ISSUED FOR PERMIT REVIEW
33	11/15/07	ISSUED FOR PERMIT REVIEW
34	11/15/07	ISSUED FOR PERMIT REVIEW
35	11/15/07	ISSUED FOR PERMIT REVIEW
36	11/15/07	ISSUED FOR PERMIT REVIEW
37	11/15/07	ISSUED FOR PERMIT REVIEW
38	11/15/07	ISSUED FOR PERMIT REVIEW
39	11/15/07	ISSUED FOR PERMIT REVIEW
40	11/15/07	ISSUED FOR PERMIT REVIEW
41	11/15/07	ISSUED FOR PERMIT REVIEW
42	11/15/07	ISSUED FOR PERMIT REVIEW
43	11/15/07	ISSUED FOR PERMIT REVIEW
44	11/15/07	ISSUED FOR PERMIT REVIEW
45	11/15/07	ISSUED FOR PERMIT REVIEW
46	11/15/07	ISSUED FOR PERMIT REVIEW
47	11/15/07	ISSUED FOR PERMIT REVIEW
48	11/15/07	ISSUED FOR PERMIT REVIEW
49	11/15/07	ISSUED FOR PERMIT REVIEW
50	11/15/07	ISSUED FOR PERMIT REVIEW





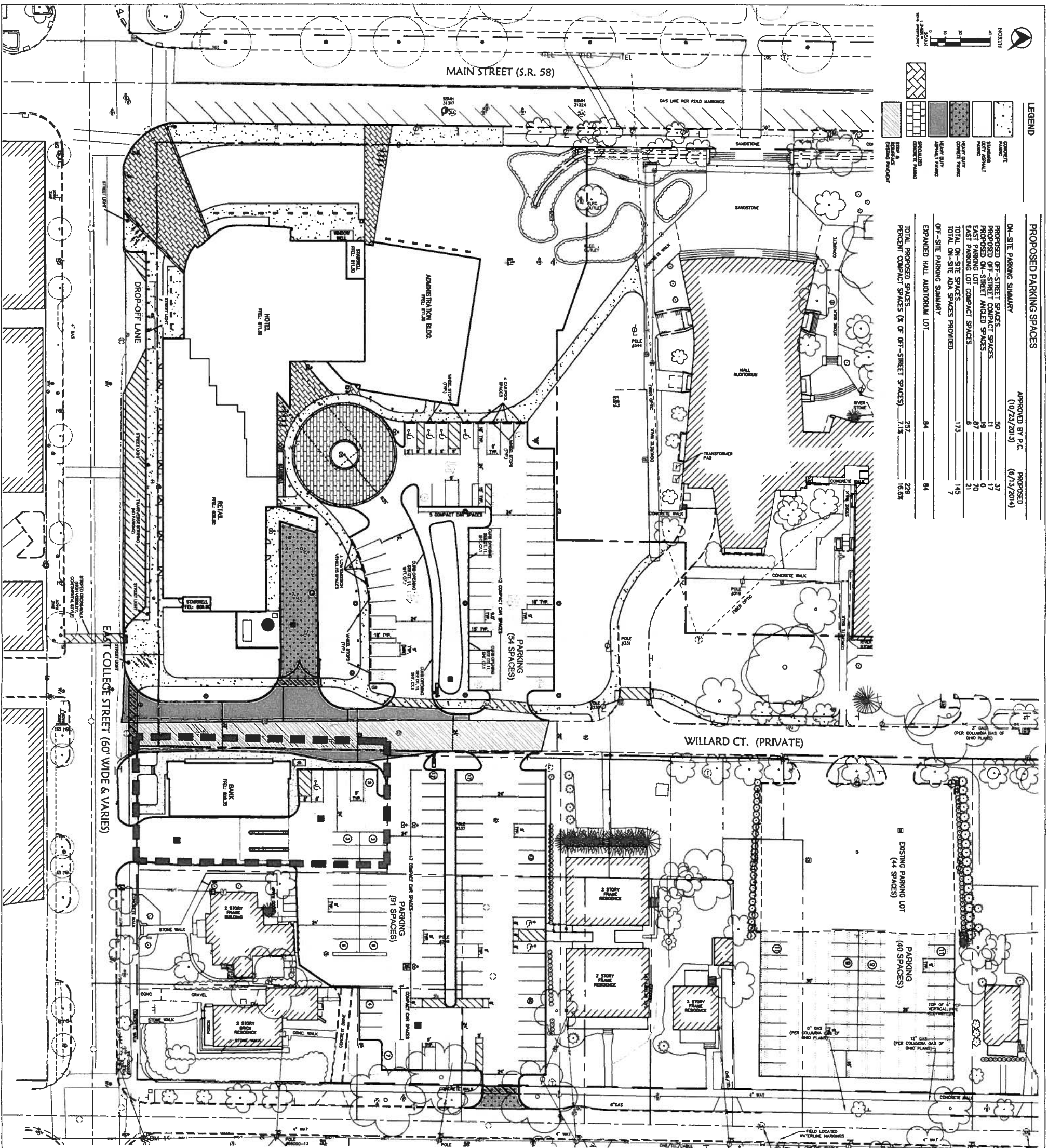

**LEGEND**

- CONCRETE
- ASPHALT
- GRAVEL
- PAVING
- LANDSCAPE
- CONCRETE
- PAVING
- LANDSCAPE
- CONCRETE
- PAVING
- LANDSCAPE
- CONCRETE
- PAVING
- LANDSCAPE

**PROPOSED PARKING SPACES**

APPROVED BY P.C. (10/23/2013) PROPOSED (6/13/2014)

ON-SITE PARKING SUMMARY	PROPOSED	PROPOSED
PROPOSED OFF-STREET COMPACT SPACES	50	37
PROPOSED ON-STREET ANGLED SPACES	19	0
EAST PARKING LOT	87	20
TOTAL ON-SITE SPACES	156	57
TOTAL ON-SITE ADA SPACES PROVIDED	173	145
OFF-SITE PARKING SUMMARY		
EXPANDED HALL AUDITORIUM LOT	84	84
TOTAL PROPOSED SPACES (% OF OFF-STREET SPACES)	257	229
PERCENT COMPACT SPACES (% OF OFF-STREET SPACES)	11%	16.5%

**SITE LAYOUT PLAN**

**OBERLIN COLLEGE GATEWAY BUILDING**

Channah, Ohio

© 2012 Oberlin College

**NEFF ASSOCIATES**

Architecture Planning Interiors Design

312.886.1100  
415.218.2460

**SCB Solomon Cordwell Buenz**

www.scb.com  
Chicago  
312.886.1100  
San Francisco  
415.218.2460

Drawn By: JSD  
Checked By: JSD  
Project Number: 2012007

Sheet Number: **C5.0**



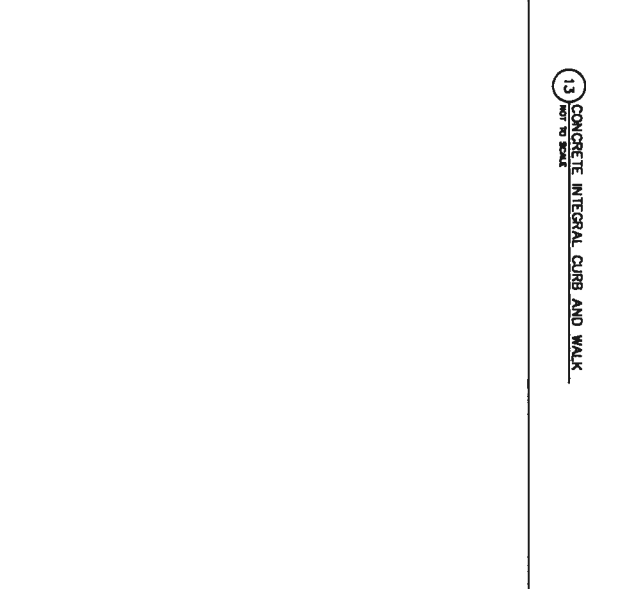
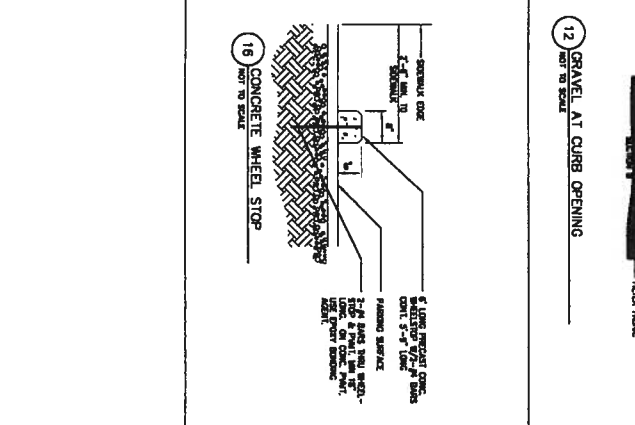
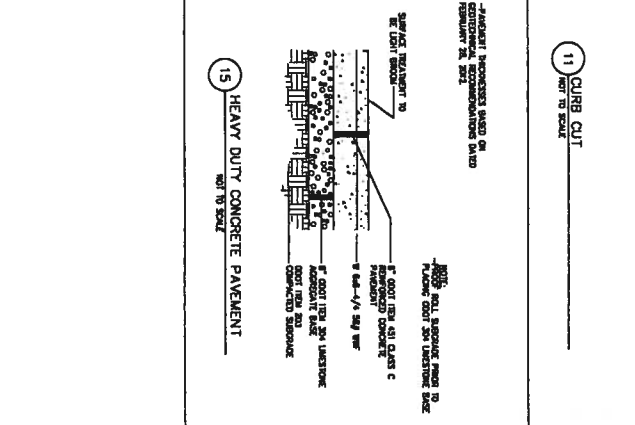
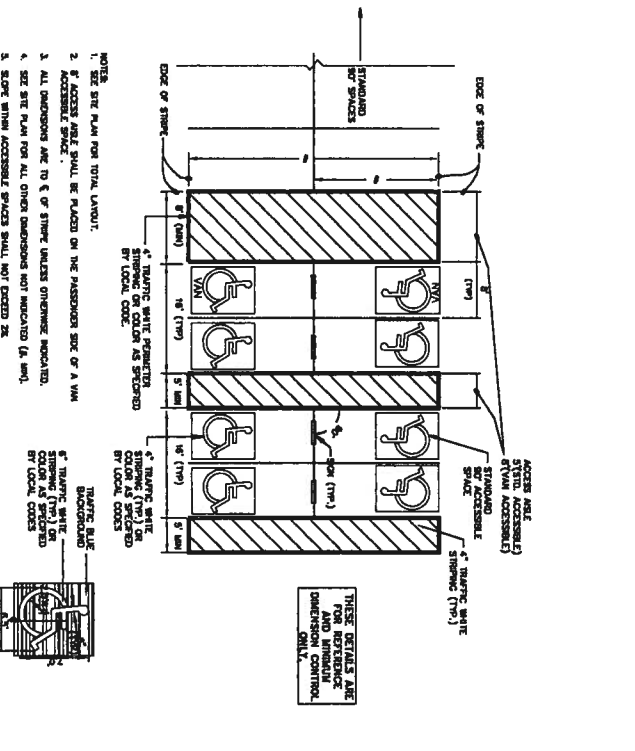
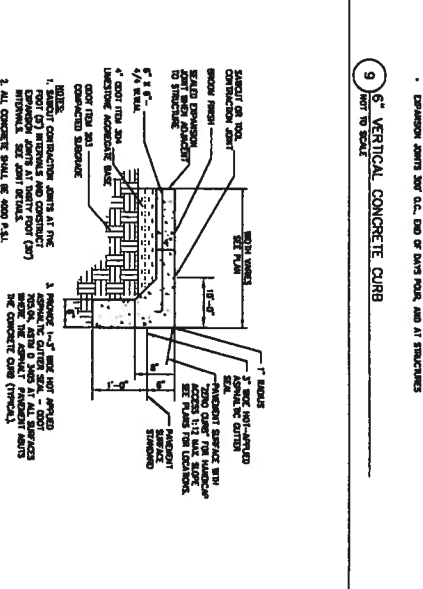
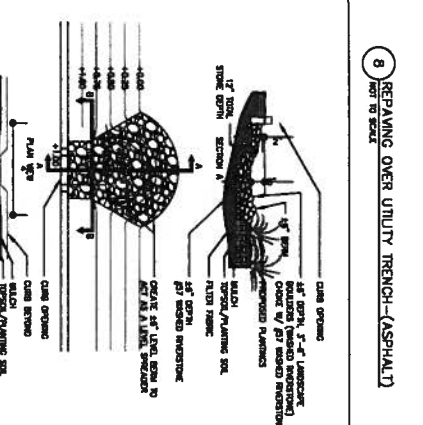
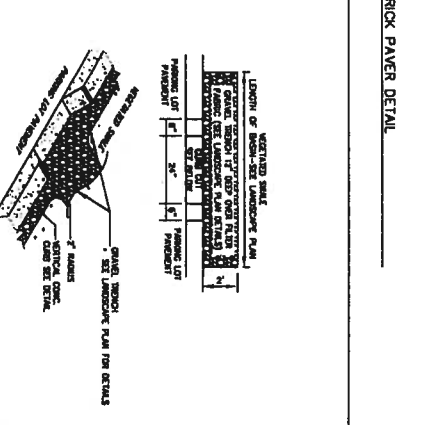
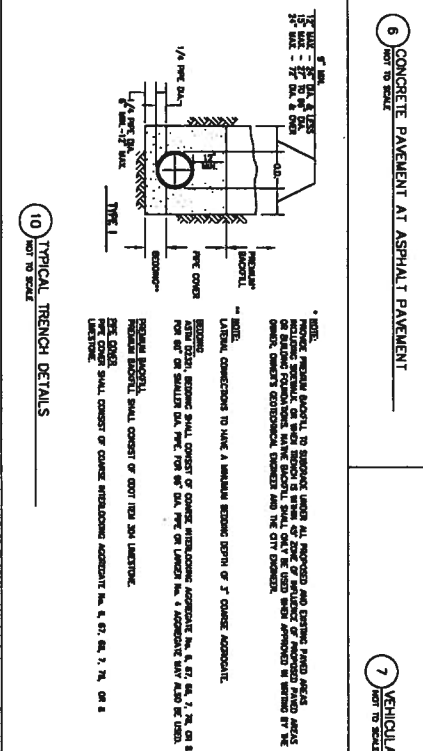
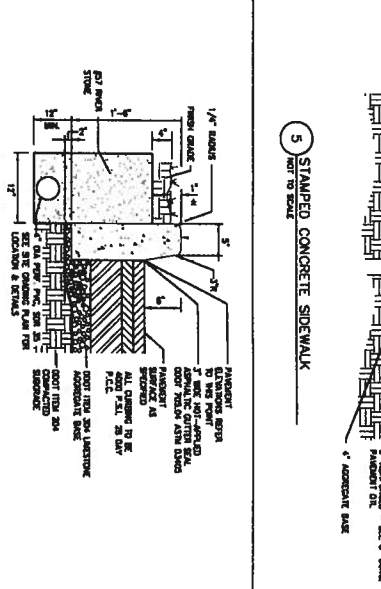
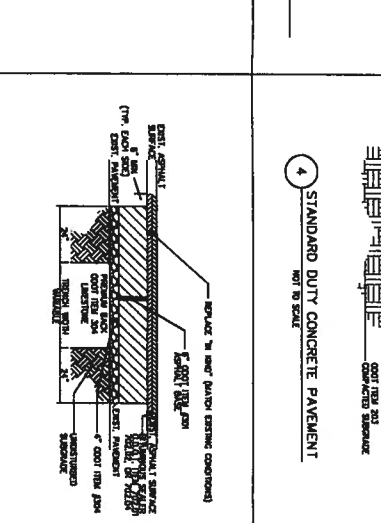
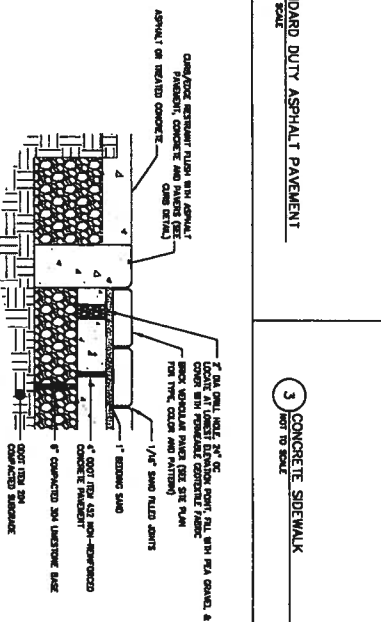
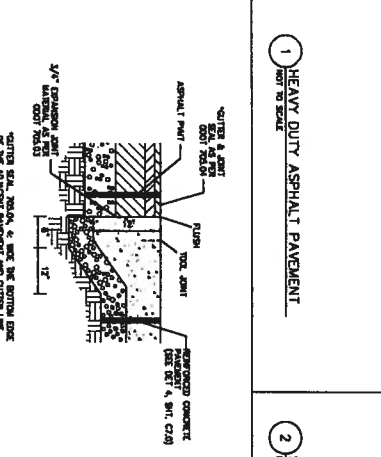
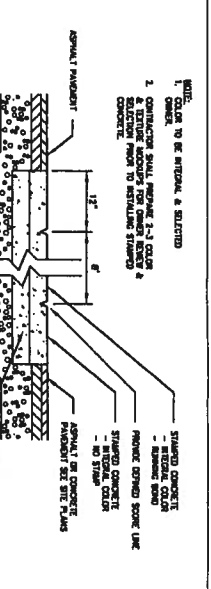
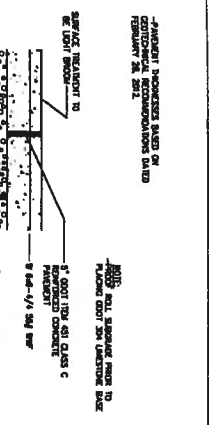
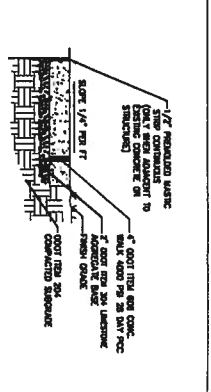
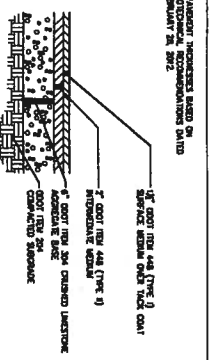
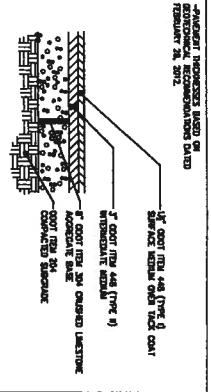

**SCB**  
Solomon  
Cordwell  
Buenz  
www.scb.com

**NERFF**  
NATIONAL ENGINEERING  
RESEARCH & FLOORING  
ASSOCIATES  
Chicago  
312.666.1100  
San Francisco  
415.713.2500  
Architecture Planning Interior Design

**SITE DETAILS**

Drawn By:	250	Sheet Number:	C7.0
Checked By:	250	Project Number:	2012007
Project Number:	2012007		

Charlottesville, Ohio  
© 2012 Solomon Cordwell Buenz

**OVERLIN COLLEGE  
GATEWAY BUILDING**

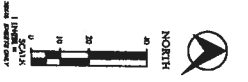

AREA TO BE PROTECTED

KEY	BOTANICAL NAME	COMMON NAME	SIZE	QTY
CA AC	CALLUNA VULGARIS	HEATH	4' x 4'	250
CA AP	CAEREA JAPONICA	HEATH	4' x 4'	250
HE QU	HEMOCALLIS 'MURRAY' RETIC.	HEATH	3" x 3"	1000
HE QU	HEMOCALLIS 'MURRAY' RETIC.	HEATH	3" x 3"	75
HE QU	HEMOCALLIS 'MURRAY' RETIC.	HEATH	3" x 3"	270
U SP	UNIDENTIFIED	UNIDENTIFIED	UNIDENTIFIED	UNIDENTIFIED
U SP	UNIDENTIFIED	UNIDENTIFIED	UNIDENTIFIED	UNIDENTIFIED
U SP	UNIDENTIFIED	UNIDENTIFIED	UNIDENTIFIED	UNIDENTIFIED
U SP	UNIDENTIFIED	UNIDENTIFIED	UNIDENTIFIED	UNIDENTIFIED
U SP	UNIDENTIFIED	UNIDENTIFIED	UNIDENTIFIED	UNIDENTIFIED
U SP	UNIDENTIFIED	UNIDENTIFIED	UNIDENTIFIED	UNIDENTIFIED
U SP	UNIDENTIFIED	UNIDENTIFIED	UNIDENTIFIED	UNIDENTIFIED
U SP	UNIDENTIFIED	UNIDENTIFIED	UNIDENTIFIED	UNIDENTIFIED
U SP	UNIDENTIFIED	UNIDENTIFIED	UNIDENTIFIED	UNIDENTIFIED
U SP	UNIDENTIFIED	UNIDENTIFIED	UNIDENTIFIED	UNIDENTIFIED
U SP	UNIDENTIFIED	UNIDENTIFIED	UNIDENTIFIED	UNIDENTIFIED
U SP	UNIDENTIFIED	UNIDENTIFIED	UNIDENTIFIED	UNIDENTIFIED
U SP	UNIDENTIFIED	UNIDENTIFIED	UNIDENTIFIED	UNIDENTIFIED
U SP	UNIDENTIFIED	UNIDENTIFIED	UNIDENTIFIED	UNIDENTIFIED
U SP	UNIDENTIFIED	UNIDENTIFIED	UNIDENTIFIED	UNIDENTIFIED
U SP	UNIDENTIFIED	UNIDENTIFIED	UNIDENTIFIED	UNIDENTIFIED
U SP	UNIDENTIFIED	UNIDENTIFIED	UNIDENTIFIED	UNIDENTIFIED
U SP	UNIDENTIFIED	UNIDENTIFIED	UNIDENTIFIED	UNIDENTIFIED
U SP	UNIDENTIFIED	UNIDENTIFIED	UNIDENTIFIED	UNIDENTIFIED
U SP	UNIDENTIFIED	UNIDENTIFIED	UNIDENTIFIED	UNIDENTIFIED
U SP	UNIDENTIFIED	UNIDENTIFIED	UNIDENTIFIED	UNIDENTIFIED
U SP	UNIDENTIFIED	UNIDENTIFIED	UNIDENTIFIED	UNIDENTIFIED
U SP	UNIDENTIFIED	UNIDENTIFIED	UNIDENTIFIED	UNIDENTIFIED
U SP	UNIDENTIFIED	UNIDENTIFIED	UNIDENTIFIED	UNIDENTIFIED
U SP	UNIDENTIFIED	UNIDENTIFIED </tr		

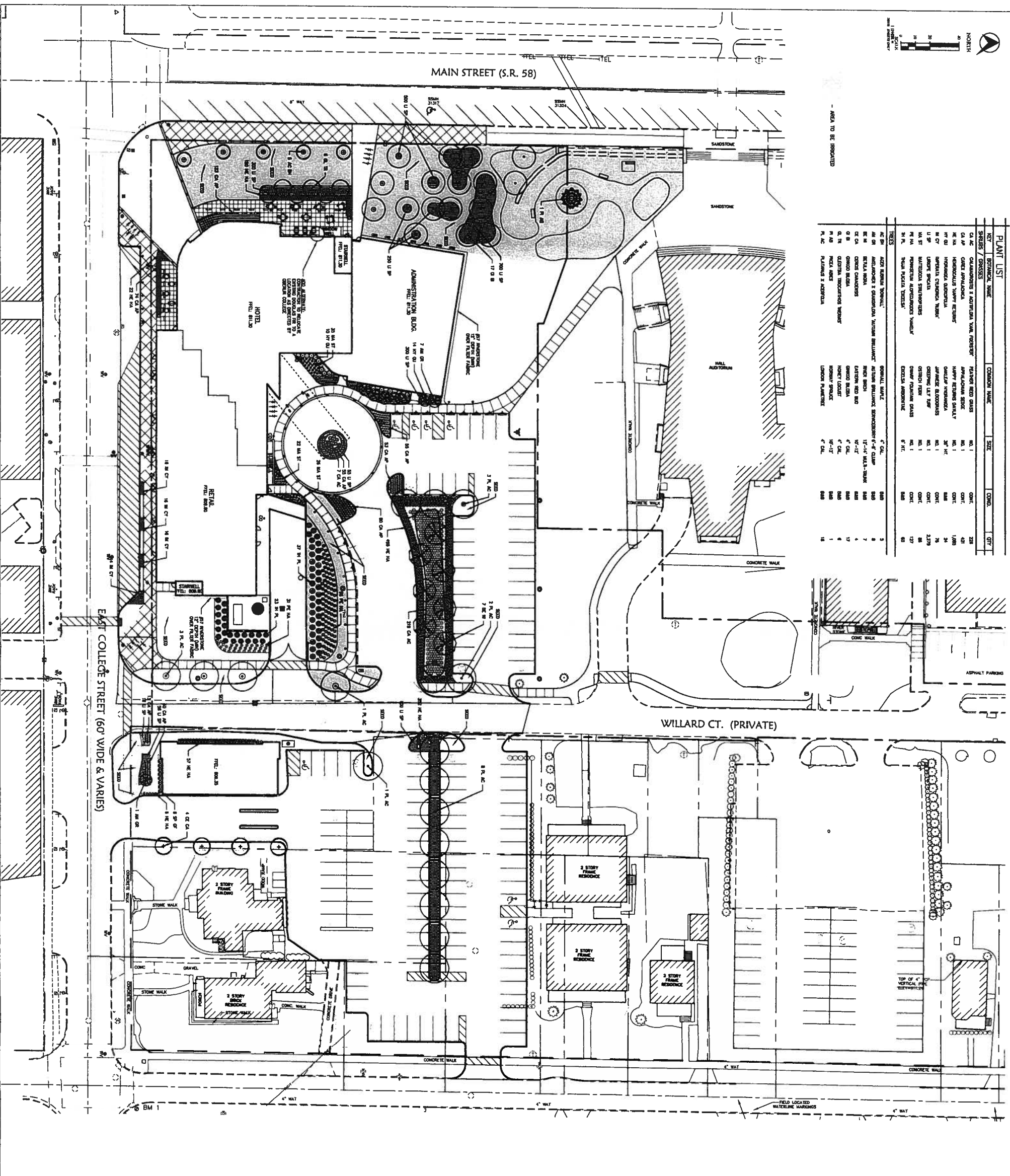

**Solomon Cortwell Blenz**  
www.scblenz.com  
Chicago 312.888.1100  
San Francisco 415.215.8240

**NEFF ASSOCIATES**  
ARCHITECTS

**OBERLIN COLLEGE GATEWAY BUILDING**

Obertlin, Ohio  
© 2011 Soloman Cortwell Blenz

**SITE LANDSCAPE PLAN**

Drawn By: [Name]  
Checked By: [Name]  
Date: [Date]  
Project Number: 20112007

**C6.0**

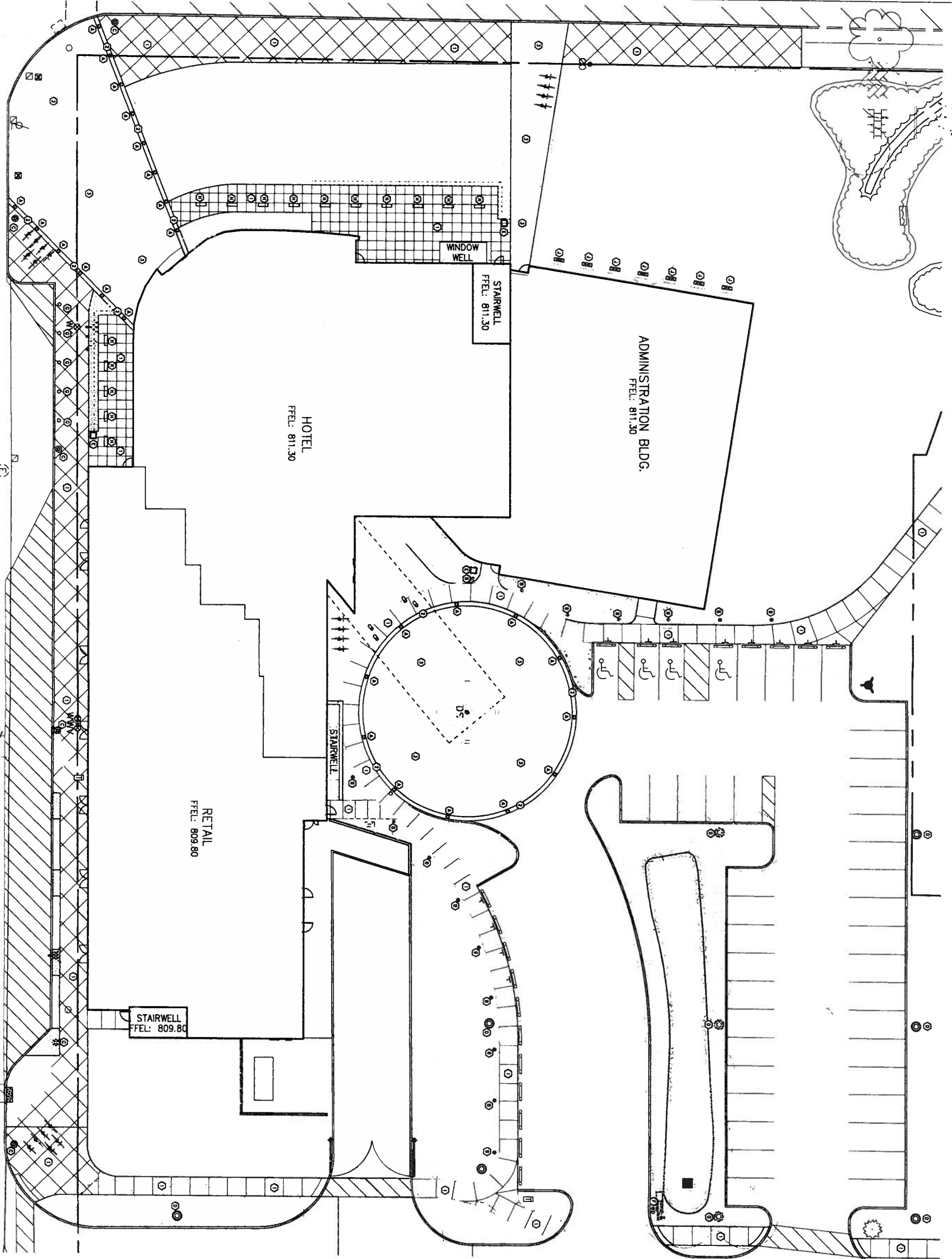
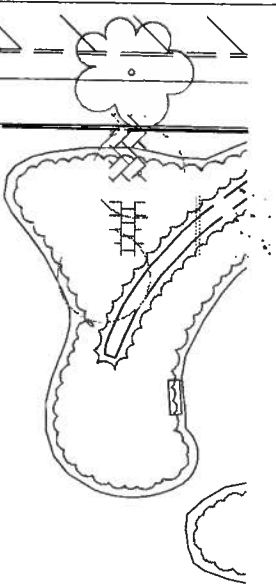

1 SITE PLAN ENLARGEMENT  
SCALE: 1" = 10'

**KEY NOTES**

- ① CONCRETE FINISHMENT WITH SCENE LIGHTS AS SHOWN
- ② 1/2" CONCRETE SAND WITH GROUND MOUNTED LIGHTS
- ③ STUMPED CONCRETE
- ④ COLOR, SMOOTH, FINISH AS SHOWN (NEW DAVIS COLOR)
- ⑤ PATIOL, SMOOTH, FINISH AS SHOWN
- ⑥ SUNLIT MOUNTED UP LIGHTS, REFER TO ELECTRICAL PLANS
- ⑦ LIGHTING SCULPTURE, REFER TO ELECTRICAL PLANS
- ⑧ CITY STANDARD LIGHT FIXTURE, REFER TO ELECTRICAL PLANS
- ⑨ SQUARE PAVEMENT LIGHT, REFER TO ELECTRICAL PLANS
- ⑩ SQUARE PAVEMENT LIGHT, REFER TO ELECTRICAL PLANS
- ⑪ SQUARE PAVEMENT LIGHT, REFER TO ELECTRICAL PLANS
- ⑫ SQUARE PAVEMENT LIGHT, REFER TO ELECTRICAL PLANS
- ⑬ SQUARE PAVEMENT LIGHT, REFER TO ELECTRICAL PLANS
- ⑭ SQUARE PAVEMENT LIGHT, REFER TO ELECTRICAL PLANS
- ⑮ SQUARE PAVEMENT LIGHT, REFER TO ELECTRICAL PLANS
- ⑯ SQUARE PAVEMENT LIGHT, REFER TO ELECTRICAL PLANS
- ⑰ SQUARE PAVEMENT LIGHT, REFER TO ELECTRICAL PLANS
- ⑱ SQUARE PAVEMENT LIGHT, REFER TO ELECTRICAL PLANS
- ⑲ SQUARE PAVEMENT LIGHT, REFER TO ELECTRICAL PLANS
- ⑳ SQUARE PAVEMENT LIGHT, REFER TO ELECTRICAL PLANS
- ㉑ SQUARE PAVEMENT LIGHT, REFER TO ELECTRICAL PLANS
- ㉒ SQUARE PAVEMENT LIGHT, REFER TO ELECTRICAL PLANS
- ㉓ SQUARE PAVEMENT LIGHT, REFER TO ELECTRICAL PLANS
- ㉔ SQUARE PAVEMENT LIGHT, REFER TO ELECTRICAL PLANS
- ㉕ SQUARE PAVEMENT LIGHT, REFER TO ELECTRICAL PLANS
- ㉖ SQUARE PAVEMENT LIGHT, REFER TO ELECTRICAL PLANS
- ㉗ SQUARE PAVEMENT LIGHT, REFER TO ELECTRICAL PLANS
- ㉘ SQUARE PAVEMENT LIGHT, REFER TO ELECTRICAL PLANS
- ㉙ SQUARE PAVEMENT LIGHT, REFER TO ELECTRICAL PLANS
- ㉚ SQUARE PAVEMENT LIGHT, REFER TO ELECTRICAL PLANS
- ㉛ SQUARE PAVEMENT LIGHT, REFER TO ELECTRICAL PLANS
- ㉜ SQUARE PAVEMENT LIGHT, REFER TO ELECTRICAL PLANS
- ㉝ SQUARE PAVEMENT LIGHT, REFER TO ELECTRICAL PLANS
- ㉞ SQUARE PAVEMENT LIGHT, REFER TO ELECTRICAL PLANS
- ㉟ SQUARE PAVEMENT LIGHT, REFER TO ELECTRICAL PLANS
- ㊱ SQUARE PAVEMENT LIGHT, REFER TO ELECTRICAL PLANS
- ㊲ SQUARE PAVEMENT LIGHT, REFER TO ELECTRICAL PLANS
- ㊳ SQUARE PAVEMENT LIGHT, REFER TO ELECTRICAL PLANS
- ㊴ SQUARE PAVEMENT LIGHT, REFER TO ELECTRICAL PLANS
- ㊵ SQUARE PAVEMENT LIGHT, REFER TO ELECTRICAL PLANS
- ㊶ SQUARE PAVEMENT LIGHT, REFER TO ELECTRICAL PLANS
- ㊷ SQUARE PAVEMENT LIGHT, REFER TO ELECTRICAL PLANS
- ㊸ SQUARE PAVEMENT LIGHT, REFER TO ELECTRICAL PLANS
- ㊹ SQUARE PAVEMENT LIGHT, REFER TO ELECTRICAL PLANS
- ㊺ SQUARE PAVEMENT LIGHT, REFER TO ELECTRICAL PLANS
- ㊻ SQUARE PAVEMENT LIGHT, REFER TO ELECTRICAL PLANS
- ㊼ SQUARE PAVEMENT LIGHT, REFER TO ELECTRICAL PLANS
- ㊽ SQUARE PAVEMENT LIGHT, REFER TO ELECTRICAL PLANS
- ㊾ SQUARE PAVEMENT LIGHT, REFER TO ELECTRICAL PLANS
- ㊿ SQUARE PAVEMENT LIGHT, REFER TO ELECTRICAL PLANS

SCP  
Solomon  
Cordwell  
Bluenz  
www.scp.com  
Chicago  
312.661.1100  
San Francisco  
415.773.2000

Architectural Planning Interior Design

NEFF  
NASSCO, LLC  
100 West Lake Street, Suite 200  
Chicago, IL 60601  
312.467.4400



NO.	DATE	DESCRIPTION
1	11/21/2007	ISSUED FOR ADOPTION AND 1.
2	12/21/2007	CONTRACT PROVISIONS MET
3	12/21/2007	REVISIONS TO SITE PLAN REVIEW
4	01/21/2008	ISSUED FOR PERMITS
5	02/15/2008	ISSUED FOR PERMITS
6	03/15/2008	ISSUED FOR PERMITS
7	04/15/2008	ISSUED FOR PERMITS
8	05/15/2008	ISSUED FOR PERMITS
9	06/15/2008	ISSUED FOR PERMITS
10	07/15/2008	ISSUED FOR PERMITS

OBERLIN COLLEGE  
GATEWAY BUILDING

Darwin, Ohio

SITE LANDSCAPE  
ENLARGEMENTS

Drawn By: [Blank]  
Checked By: DM  
Project Number: 2012007  
Sheet Number: C6.1

SCE  
**Solomon**  
**Cordwell**  
**Blumiz**

Chicago  
312.281.1100  
San Francisco  
415.213.2450

Architects Planning Interior Design



**DATE** \_\_\_\_\_

**DESCRIPTION**

**BY**

**CHECKED**

**DATE**

**PROJECT**

**CLIENT**

**NO.**

Oberlin, Ohio  
2375 Madison Church Lane  
Oberlin College  
GATEWAY BUILDING

Drawn By: JAO  
Checked By: JAO  
Project Number: 2012007  
Sheet Number: C7.1

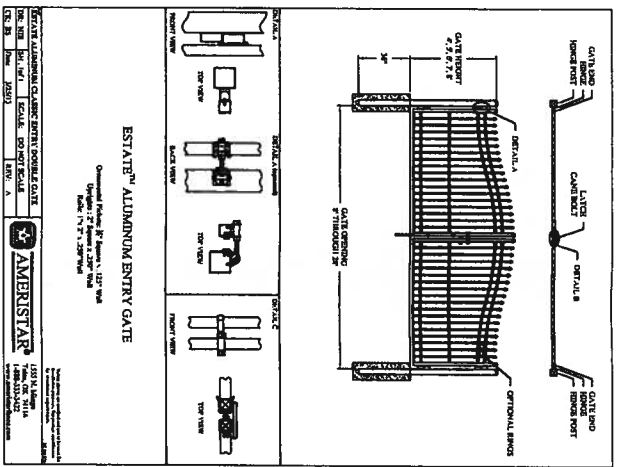

2 SWING GATE  
NOT TO SCALE  
PRELIMINARY

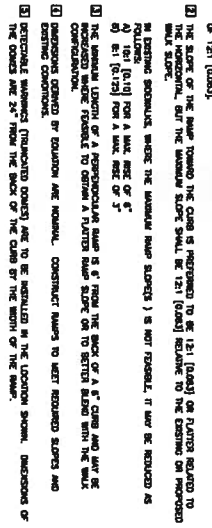
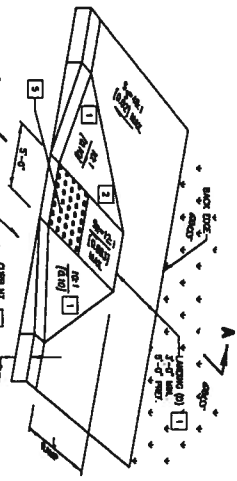
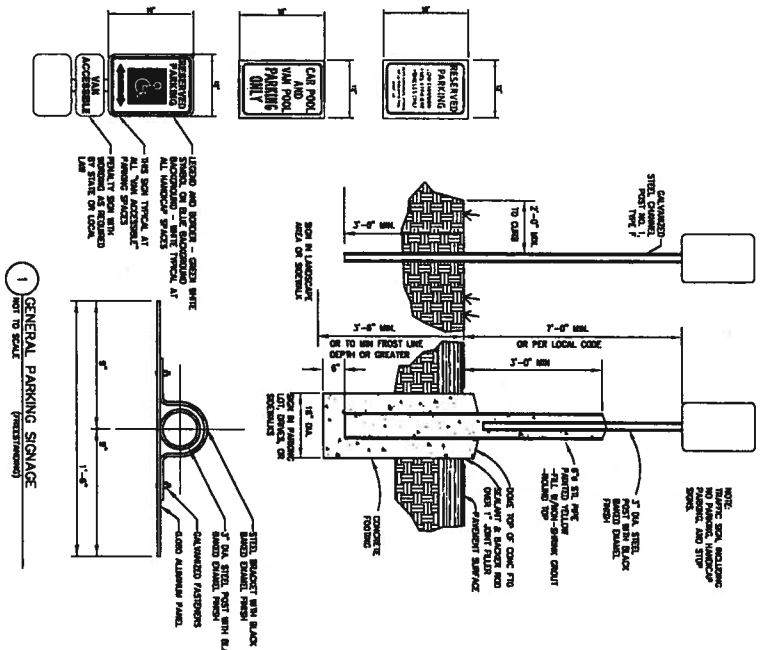

**NOTES:**

1. ALL SURFACE FINISHES SHALL BE DETERMINED BY CONCRETE AND ASPHALT CONTRACTORS. CONTRACTORS SHALL BE RESPONSIBLE FOR OBTAINING ALL NECESSARY PERMITS AND APPROVALS FROM LOCAL AGENCIES AND AGENCIES.
2. ALL FINISHES SHALL BE DETERMINED BY LOCAL CODES. CONTRACTORS SHALL BE RESPONSIBLE FOR OBTAINING ALL NECESSARY PERMITS AND APPROVALS FROM LOCAL AGENCIES AND AGENCIES.
3. ALL FINISHES SHALL BE DETERMINED BY LOCAL CODES. CONTRACTORS SHALL BE RESPONSIBLE FOR OBTAINING ALL NECESSARY PERMITS AND APPROVALS FROM LOCAL AGENCIES AND AGENCIES.
4. ALL FINISHES SHALL BE DETERMINED BY LOCAL CODES. CONTRACTORS SHALL BE RESPONSIBLE FOR OBTAINING ALL NECESSARY PERMITS AND APPROVALS FROM LOCAL AGENCIES AND AGENCIES.
5. ALL FINISHES SHALL BE DETERMINED BY LOCAL CODES. CONTRACTORS SHALL BE RESPONSIBLE FOR OBTAINING ALL NECESSARY PERMITS AND APPROVALS FROM LOCAL AGENCIES AND AGENCIES.
6. ALL FINISHES SHALL BE DETERMINED BY LOCAL CODES. CONTRACTORS SHALL BE RESPONSIBLE FOR OBTAINING ALL NECESSARY PERMITS AND APPROVALS FROM LOCAL AGENCIES AND AGENCIES.
7. ALL FINISHES SHALL BE DETERMINED BY LOCAL CODES. CONTRACTORS SHALL BE RESPONSIBLE FOR OBTAINING ALL NECESSARY PERMITS AND APPROVALS FROM LOCAL AGENCIES AND AGENCIES.
8. ALL FINISHES SHALL BE DETERMINED BY LOCAL CODES. CONTRACTORS SHALL BE RESPONSIBLE FOR OBTAINING ALL NECESSARY PERMITS AND APPROVALS FROM LOCAL AGENCIES AND AGENCIES.
9. ALL FINISHES SHALL BE DETERMINED BY LOCAL CODES. CONTRACTORS SHALL BE RESPONSIBLE FOR OBTAINING ALL NECESSARY PERMITS AND APPROVALS FROM LOCAL AGENCIES AND AGENCIES.
10. ALL FINISHES SHALL BE DETERMINED BY LOCAL CODES. CONTRACTORS SHALL BE RESPONSIBLE FOR OBTAINING ALL NECESSARY PERMITS AND APPROVALS FROM LOCAL AGENCIES AND AGENCIES.

1. ALL FINISHES SHALL BE DETERMINED BY LOCAL CODES. CONTRACTORS SHALL BE RESPONSIBLE FOR OBTAINING ALL NECESSARY PERMITS AND APPROVALS FROM LOCAL AGENCIES AND AGENCIES.

2. ALL FINISHES SHALL BE DETERMINED BY LOCAL CODES. CONTRACTORS SHALL BE RESPONSIBLE FOR OBTAINING ALL NECESSARY PERMITS AND APPROVALS FROM LOCAL AGENCIES AND AGENCIES.

3. ALL FINISHES SHALL BE DETERMINED BY LOCAL CODES. CONTRACTORS SHALL BE RESPONSIBLE FOR OBTAINING ALL NECESSARY PERMITS AND APPROVALS FROM LOCAL AGENCIES AND AGENCIES.

4. ALL FINISHES SHALL BE DETERMINED BY LOCAL CODES. CONTRACTORS SHALL BE RESPONSIBLE FOR OBTAINING ALL NECESSARY PERMITS AND APPROVALS FROM LOCAL AGENCIES AND AGENCIES.

5. ALL FINISHES SHALL BE DETERMINED BY LOCAL CODES. CONTRACTORS SHALL BE RESPONSIBLE FOR OBTAINING ALL NECESSARY PERMITS AND APPROVALS FROM LOCAL AGENCIES AND AGENCIES.

6. ALL FINISHES SHALL BE DETERMINED BY LOCAL CODES. CONTRACTORS SHALL BE RESPONSIBLE FOR OBTAINING ALL NECESSARY PERMITS AND APPROVALS FROM LOCAL AGENCIES AND AGENCIES.

7. ALL FINISHES SHALL BE DETERMINED BY LOCAL CODES. CONTRACTORS SHALL BE RESPONSIBLE FOR OBTAINING ALL NECESSARY PERMITS AND APPROVALS FROM LOCAL AGENCIES AND AGENCIES.

8. ALL FINISHES SHALL BE DETERMINED BY LOCAL CODES. CONTRACTORS SHALL BE RESPONSIBLE FOR OBTAINING ALL NECESSARY PERMITS AND APPROVALS FROM LOCAL AGENCIES AND AGENCIES.

9. ALL FINISHES SHALL BE DETERMINED BY LOCAL CODES. CONTRACTORS SHALL BE RESPONSIBLE FOR OBTAINING ALL NECESSARY PERMITS AND APPROVALS FROM LOCAL AGENCIES AND AGENCIES.

10. ALL FINISHES SHALL BE DETERMINED BY LOCAL CODES. CONTRACTORS SHALL BE RESPONSIBLE FOR OBTAINING ALL NECESSARY PERMITS AND APPROVALS FROM LOCAL AGENCIES AND AGENCIES.

4 SURFACE RESTORATION STANDARDS - 2 OF 2  
NOT TO SCALE

**SERVICE CONNECTION**  
Refer to any necessary standards

1. NEW VALVE BOXES SHALL BE CONSTRUCTED OF CAST IRON OR STEEL AND SHALL BE APPROVED BY THE CITY ENGINEER.
2. THE VALVE BOX SHALL BE CONSTRUCTED TO WITHSTAND A MINIMUM OF 100 PSI OF WATER PRESSURE.
3. THE VALVE BOX SHALL BE CONSTRUCTED TO WITHSTAND A MINIMUM OF 100 PSI OF AIR PRESSURE.
4. THE VALVE BOX SHALL BE CONSTRUCTED TO WITHSTAND A MINIMUM OF 100 PSI OF VACUUM PRESSURE.

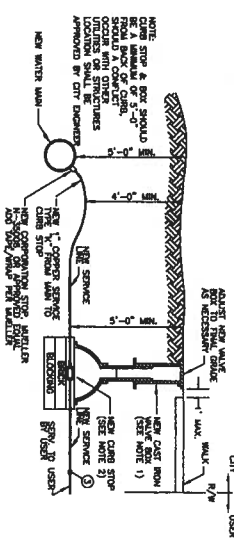

**1 WATER SERVICE CONNECTION**  
(CITY OF GERRARD DETAIL)

**OPERATION OF SERVICE LINES**

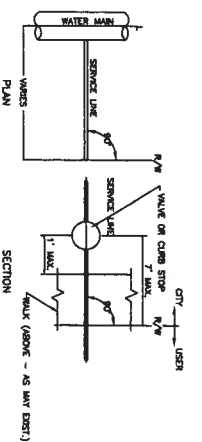

**2 OPERATION OF WATER SERVICE LINES**  
(CITY OF GERRARD DETAIL)

**INDUSTRIAL/COMMERCIAL SERVICE TAP**

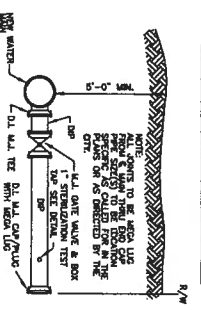

**3 INDUSTRIAL/COMMERCIAL WATER SERVICE TAP**  
(CITY OF GERRARD DETAIL)

**TRENCH & BEDDING DETAILS**

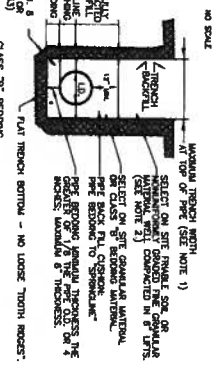

**4 WATERLINE TRENCH & BEDDING**  
(CITY OF GERRARD DETAIL)

**HYDRANT ASSEMBLY DETAIL**

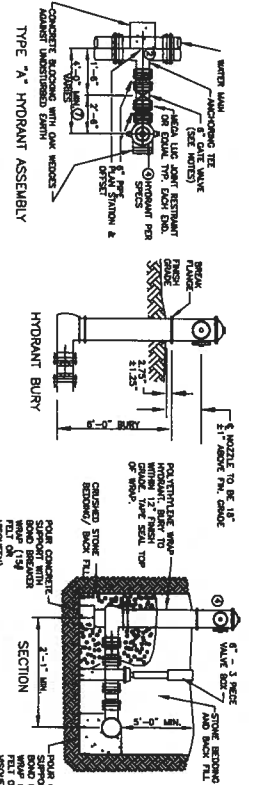

**6 HYDRANT ASSEMBLY**  
(CITY OF GERRARD DETAIL)

**WATERLINE TIE-INS TYPICAL PROCEDURES**

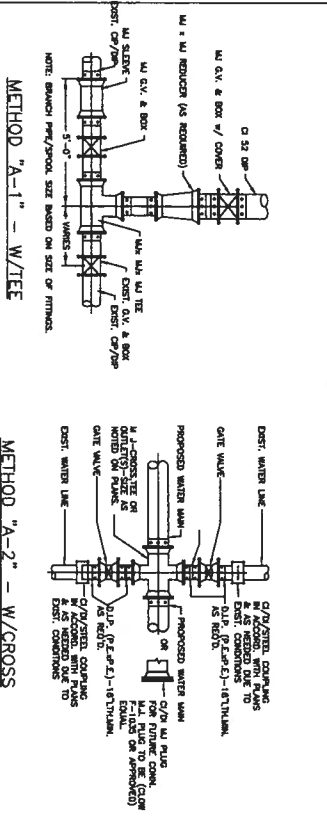

**5 WATER CONNECTION PROCEDURES - METHOD A**  
(CITY OF GERRARD DETAIL)

**MINIMUM HORIZONTAL W/L CLEARANCE**

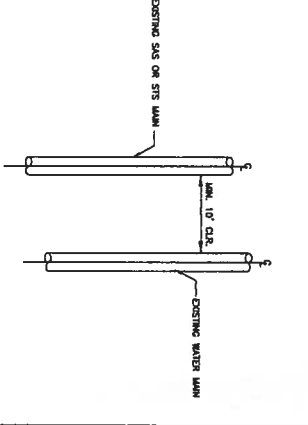

**WATER DISTRIBUTION MATERIAL SPECIFICATIONS**

THE ENGINEER'S REQUIREMENTS SHALL BE CONSIDERED BY THE MANUFACTURER AND REFERRED TO AS THE "SPECIFICATIONS". THE MANUFACTURER SHALL HAVE A NEW INSPECTION REPORT FOR EACH YEAR OF PRODUCTION. ALL WATER MAINS SHALL BE CONSTRUCTED OF DUCTILE IRON PIPE WITH A MINIMUM WALL THICKNESS OF 0.1875 INCHES. ALL SERVICE LINES SHALL BE CONSTRUCTED OF DUCTILE IRON PIPE WITH A MINIMUM WALL THICKNESS OF 0.1562 INCHES. ALL VALVE BOXES SHALL BE CONSTRUCTED OF CAST IRON OR STEEL AND SHALL BE APPROVED BY THE CITY ENGINEER. THE VALVE BOX SHALL BE CONSTRUCTED TO WITHSTAND A MINIMUM OF 100 PSI OF WATER PRESSURE. THE VALVE BOX SHALL BE CONSTRUCTED TO WITHSTAND A MINIMUM OF 100 PSI OF AIR PRESSURE. THE VALVE BOX SHALL BE CONSTRUCTED TO WITHSTAND A MINIMUM OF 100 PSI OF VACUUM PRESSURE.

**7 MISCELLANEOUS WATER LINE NOTES**  
(CITY OF GERRARD DETAIL)

**TRENCH & BEDDING DETAILS**

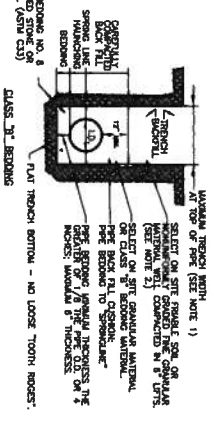

**8 SANITARY TRENCH & BEDDING**  
(CITY OF GERRARD DETAIL)

**SANITARY STANDARD NOTES**

Length of Service Line	8	10	12	15	18	21	24
1.00% <td>3.00</td> <td>3.00</td> <td>3.00</td> <td>3.00</td> <td>3.00</td> <td>3.00</td> <td>3.00</td>	3.00	3.00	3.00	3.00	3.00	3.00	3.00
2.00% <td>4.00</td> <td>4.00</td> <td>4.00</td> <td>4.00</td> <td>4.00</td> <td>4.00</td> <td>4.00</td>	4.00	4.00	4.00	4.00	4.00	4.00	4.00
3.00% <td>5.00</td> <td>5.00</td> <td>5.00</td> <td>5.00</td> <td>5.00</td> <td>5.00</td> <td>5.00</td>	5.00	5.00	5.00	5.00	5.00	5.00	5.00
4.00% <td>6.00</td> <td>6.00</td> <td>6.00</td> <td>6.00</td> <td>6.00</td> <td>6.00</td> <td>6.00</td>	6.00	6.00	6.00	6.00	6.00	6.00	6.00
5.00% <td>7.00</td> <td>7.00</td> <td>7.00</td> <td>7.00</td> <td>7.00</td> <td>7.00</td> <td>7.00</td>	7.00	7.00	7.00	7.00	7.00	7.00	7.00
6.00% <td>8.00</td> <td>8.00</td> <td>8.00</td> <td>8.00</td> <td>8.00</td> <td>8.00</td> <td>8.00</td>	8.00	8.00	8.00	8.00	8.00	8.00	8.00
7.00% <td>9.00</td> <td>9.00</td> <td>9.00</td> <td>9.00</td> <td>9.00</td> <td>9.00</td> <td>9.00</td>	9.00	9.00	9.00	9.00	9.00	9.00	9.00
8.00% <td>10.00</td> <td>10.00</td> <td>10.00</td> <td>10.00</td> <td>10.00</td> <td>10.00</td> <td>10.00</td>	10.00	10.00	10.00	10.00	10.00	10.00	10.00
9.00% <td>11.00</td> <td>11.00</td> <td>11.00</td> <td>11.00</td> <td>11.00</td> <td>11.00</td> <td>11.00</td>	11.00	11.00	11.00	11.00	11.00	11.00	11.00
10.00% <td>12.00</td> <td>12.00</td> <td>12.00</td> <td>12.00</td> <td>12.00</td> <td>12.00</td> <td>12.00</td>	12.00	12.00	12.00	12.00	12.00	12.00	12.00

**9 SANITARY STANDARD NOTES**  
(CITY OF GERRARD DETAIL)

**SCE**  
**Solomon Cordwell Buenz**  
 www.scb.com  
 Chicago 312.686.1100  
 San Francisco 415.218.2400  
 Architecture Planning Interior Design

**NEFF**  
 ASSOCIATES  
 1111 WEST WASHINGTON STREET  
 CHICAGO, ILLINOIS 60604  
 TEL: 312.427.1000  
 FAX: 312.427.1001  
 WWW.NEFFASSOCIATES.COM



**UTILITY DETAILS**

Drawn By: ASB  
 Checked By: DJM  
 Date: 02/11/2007  
 Project Number: 2012007

Sheet Number: **C7.2**

**OBERLIN COLLEGE GATEWAY BUILDING**  
 Oberlin, Ohio  
 © 2007 Solomon Cordwell Buenz



**Bega In-Ground  
LED Light**



**Lithonia Lumark  
Site Luminaire**



**Lithonia MRP-LED1  
Site Luminaire**



**Surface Mounted  
Floodlight**



**Lighted Stainless  
Steel Bollard**



**City of Oberlin  
Standard Post Light**



**In-grade Linear  
Floodlight**

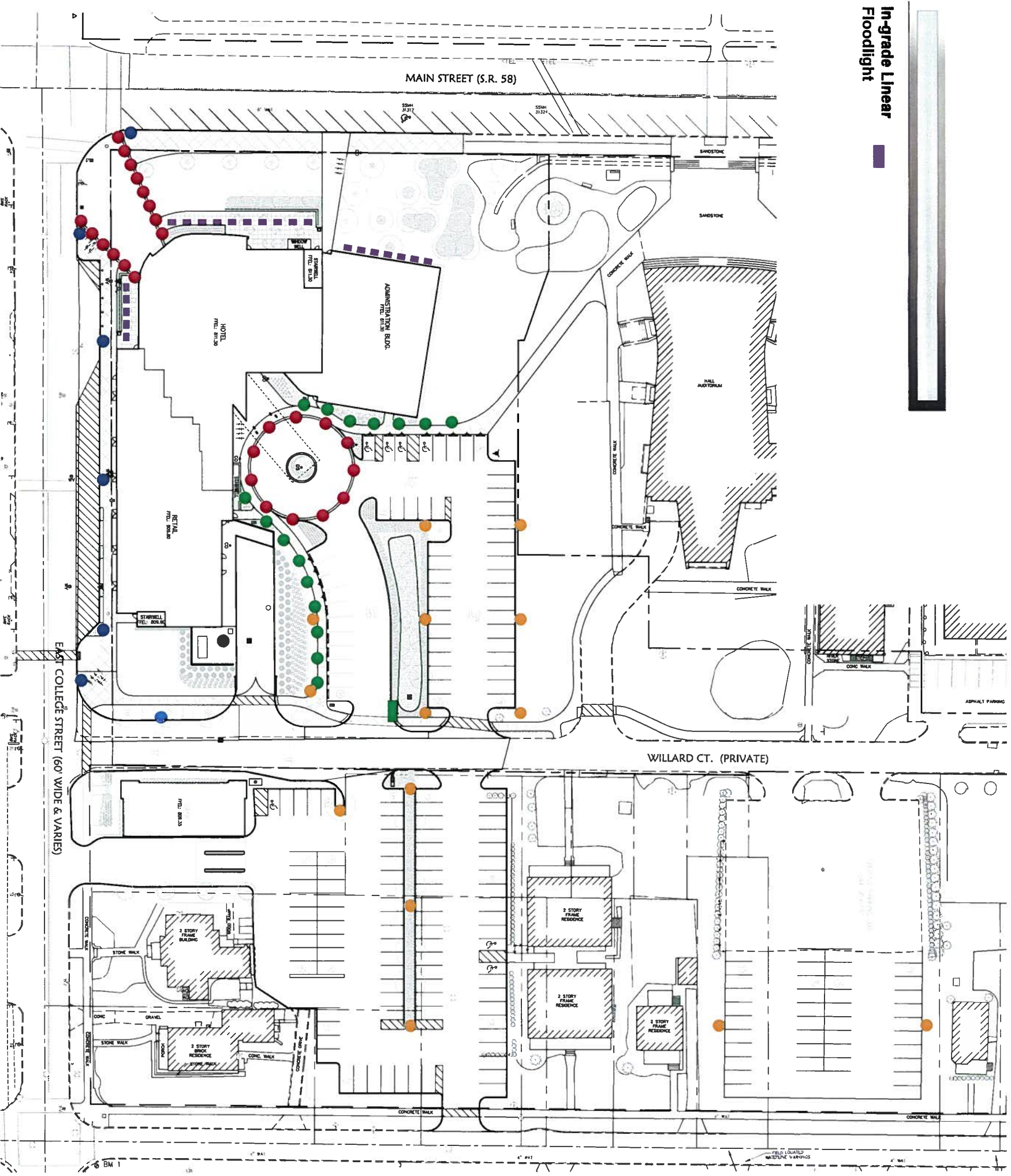







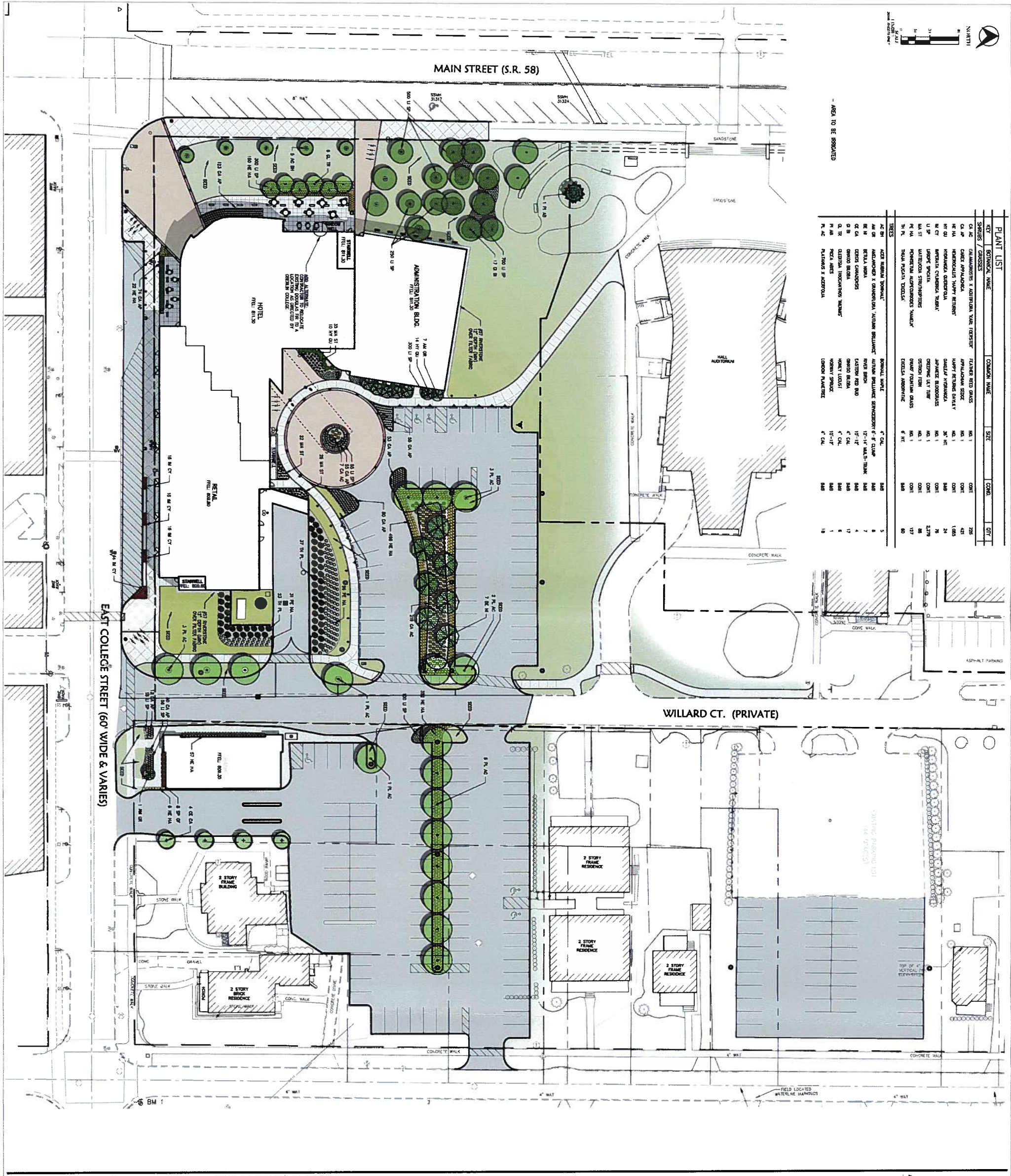

AREA TO BE REGRADED

PLANT LIST	SYMBOLOGY	COMMON NAME	SIZE	QTY
CA 4C	CALLUNA V. ADONIS	FLAME TREE	NO. 1	226
CA 4D	CALLUNA V. ADONIS	FLAME TREE	NO. 1	423
CA 4E	CALLUNA V. ADONIS	FLAME TREE	NO. 1	1583
CA 4F	CALLUNA V. ADONIS	FLAME TREE	NO. 1	24
CA 4G	CALLUNA V. ADONIS	FLAME TREE	NO. 1	279
CA 4H	CALLUNA V. ADONIS	FLAME TREE	NO. 1	88
CA 4I	CALLUNA V. ADONIS	FLAME TREE	NO. 1	17
CA 4J	CALLUNA V. ADONIS	FLAME TREE	NO. 1	60
CA 4K	CALLUNA V. ADONIS	FLAME TREE	NO. 1	18
CA 4L	CALLUNA V. ADONIS	FLAME TREE	NO. 1	18
CA 4M	CALLUNA V. ADONIS	FLAME TREE	NO. 1	18
CA 4N	CALLUNA V. ADONIS	FLAME TREE	NO. 1	18
CA 4O	CALLUNA V. ADONIS	FLAME TREE	NO. 1	18
CA 4P	CALLUNA V. ADONIS	FLAME TREE	NO. 1	18
CA 4Q	CALLUNA V. ADONIS	FLAME TREE	NO. 1	18
CA 4R	CALLUNA V. ADONIS	FLAME TREE	NO. 1	18
CA 4S	CALLUNA V. ADONIS	FLAME TREE	NO. 1	18
CA 4T	CALLUNA V. ADONIS	FLAME TREE	NO. 1	18
CA 4U	CALLUNA V. ADONIS	FLAME TREE	NO. 1	18
CA 4V	CALLUNA V. ADONIS	FLAME TREE	NO. 1	18
CA 4W	CALLUNA V. ADONIS	FLAME TREE	NO. 1	18
CA 4X	CALLUNA V. ADONIS	FLAME TREE	NO. 1	18
CA 4Y	CALLUNA V. ADONIS	FLAME TREE	NO. 1	18
CA 4Z	CALLUNA V. ADONIS	FLAME TREE	NO. 1	18
CA 5A	CALLUNA V. ADONIS	FLAME TREE	NO. 1	18
CA 5B	CALLUNA V. ADONIS	FLAME TREE	NO. 1	18
CA 5C	CALLUNA V. ADONIS	FLAME TREE	NO. 1	18
CA 5D	CALLUNA V. ADONIS	FLAME TREE	NO. 1	18
CA 5E	CALLUNA V. ADONIS	FLAME TREE	NO. 1	18
CA 5F	CALLUNA V. ADONIS	FLAME TREE	NO. 1	18
CA 5G	CALLUNA V. ADONIS	FLAME TREE	NO. 1	18
CA 5H	CALLUNA V. ADONIS	FLAME TREE	NO. 1	18
CA 5I	CALLUNA V. ADONIS	FLAME TREE	NO. 1	18
CA 5J	CALLUNA V. ADONIS	FLAME TREE	NO. 1	18
CA 5K	CALLUNA V. ADONIS	FLAME TREE	NO. 1	18
CA 5L	CALLUNA V. ADONIS	FLAME TREE	NO. 1	18
CA 5M	CALLUNA V. ADONIS	FLAME TREE	NO. 1	18
CA 5N	CALLUNA V. ADONIS	FLAME TREE	NO. 1	18
CA 5O	CALLUNA V. ADONIS	FLAME TREE	NO. 1	18
CA 5P	CALLUNA V. ADONIS	FLAME TREE	NO. 1	18
CA 5Q	CALLUNA V. ADONIS	FLAME TREE	NO. 1	18
CA 5R	CALLUNA V. ADONIS	FLAME TREE	NO. 1	18
CA 5S	CALLUNA V. ADONIS	FLAME TREE	NO. 1	18
CA 5T	CALLUNA V. ADONIS	FLAME TREE	NO. 1	18
CA 5U	CALLUNA V. ADONIS	FLAME TREE	NO. 1	18
CA 5V	CALLUNA V. ADONIS	FLAME TREE	NO. 1	18
CA 5W	CALLUNA V. ADONIS	FLAME TREE	NO. 1	18
CA 5X	CALLUNA V. ADONIS	FLAME TREE	NO. 1	18
CA 5Y	CALLUNA V. ADONIS	FLAME TREE	NO. 1	18
CA 5Z	CALLUNA V. ADONIS	FLAME TREE	NO. 1	18
CA 6A	CALLUNA V. ADONIS	FLAME TREE	NO. 1	18
CA 6B	CALLUNA V. ADONIS	FLAME TREE	NO. 1	18
CA 6C	CALLUNA V. ADONIS	FLAME TREE	NO. 1	18
CA 6D	CALLUNA V. ADONIS	FLAME TREE	NO. 1	18
CA 6E	CALLUNA V. ADONIS	FLAME TREE	NO. 1	18
CA 6F	CALLUNA V. ADONIS	FLAME TREE	NO. 1	18
CA 6G	CALLUNA V. ADONIS	FLAME TREE	NO. 1	18
CA 6H	CALLUNA V. ADONIS	FLAME TREE	NO. 1	18
CA 6I	CALLUNA V. ADONIS	FLAME TREE	NO. 1	18
CA 6J	CALLUNA V. ADONIS	FLAME TREE	NO. 1	18
CA 6K	CALLUNA V. ADONIS	FLAME TREE	NO. 1	18
CA 6L	CALLUNA V. ADONIS	FLAME TREE	NO. 1	18
CA 6M	CALLUNA V. ADONIS	FLAME TREE	NO. 1	18
CA 6N	CALLUNA V. ADONIS	FLAME TREE	NO. 1	18
CA 6O	CALLUNA V. ADONIS	FLAME TREE	NO. 1	18
CA 6P	CALLUNA V. ADONIS	FLAME TREE	NO. 1	18
CA 6Q	CALLUNA V. ADONIS	FLAME TREE	NO. 1	18
CA 6R	CALLUNA V. ADONIS	FLAME TREE	NO. 1	18
CA 6S	CALLUNA V. ADONIS	FLAME TREE	NO. 1	18
CA 6T	CALLUNA V. ADONIS	FLAME TREE	NO. 1	18
CA 6U	CALLUNA V. ADONIS	FLAME TREE	NO. 1	18
CA 6V	CALLUNA V. ADONIS	FLAME TREE	NO. 1	18
CA 6W	CALLUNA V. ADONIS	FLAME TREE	NO. 1	18
CA 6X	CALLUNA V. ADONIS	FLAME TREE	NO. 1	18
CA 6Y	CALLUNA V. ADONIS	FLAME TREE	NO. 1	18
CA 6Z	CALLUNA V. ADONIS	FLAME TREE	NO. 1	18

**SCR Solomon Cordwell Buenz**  
 www.scb.com  
 Chicago 312.896.1100  
 San Francisco 415.218.2450  
 Architecture Planning Interior Design

**NEFF ASSOCIATES**  
 1150 N. LAKE STREET  
 CHICAGO, IL 60610  
 TEL: 312.329.7000  
 FAX: 312.329.7001  
 WWW.NEFFASSOCIATES.COM

**Professional Seal:**  
 LANDSCAPE ARCHITECT  
 STATE OF OHIO  
 NO. 2012007

**Oberlin, Ohio**  
 1257 Adams Street

**OBERLIN COLLEGE GATEWAY BUILDING**

**SITE LANDSCAPE PLAN**

Drawn By: JBD  
 Checked By: DAN  
 Project Number: 2012007

**C6.0**

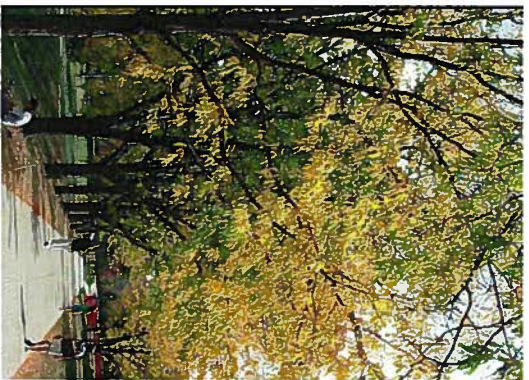

Honey Locust



River Birch



Serviceberry



Eastern Red Bud



Dwarf Fountain Grass

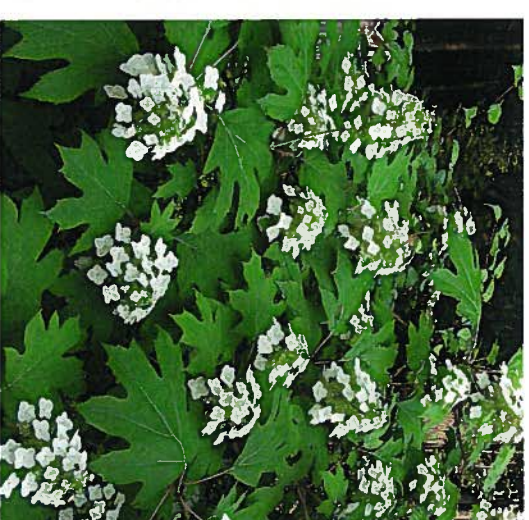

Oakleaf Hydrangea

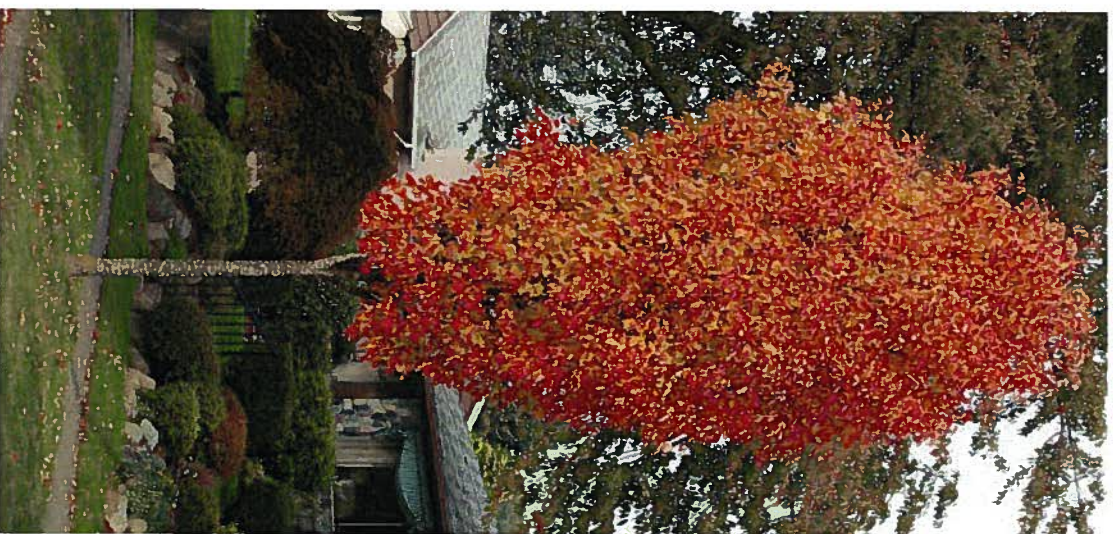

Bowhall Maple



Feather Reed Grass



Japanese Bloodgrass



Happy Returns Daylily



Norway Spruce



London Planetree



Appalachian Sedge



Creeping Lilyturf



Ginkgo Biloba

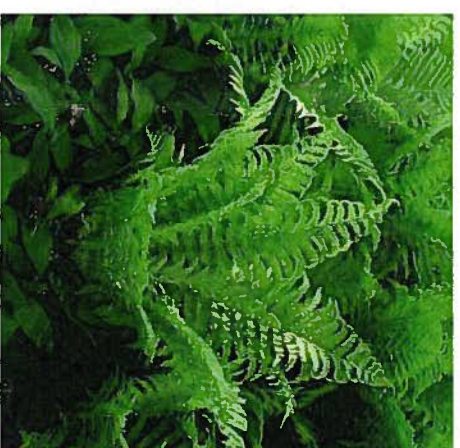

Ostrich Fern



Excelsa Arborvitae

Date: May 2014  
Project #: 13640

# Plant Material

Gateway Building - Oberlin College

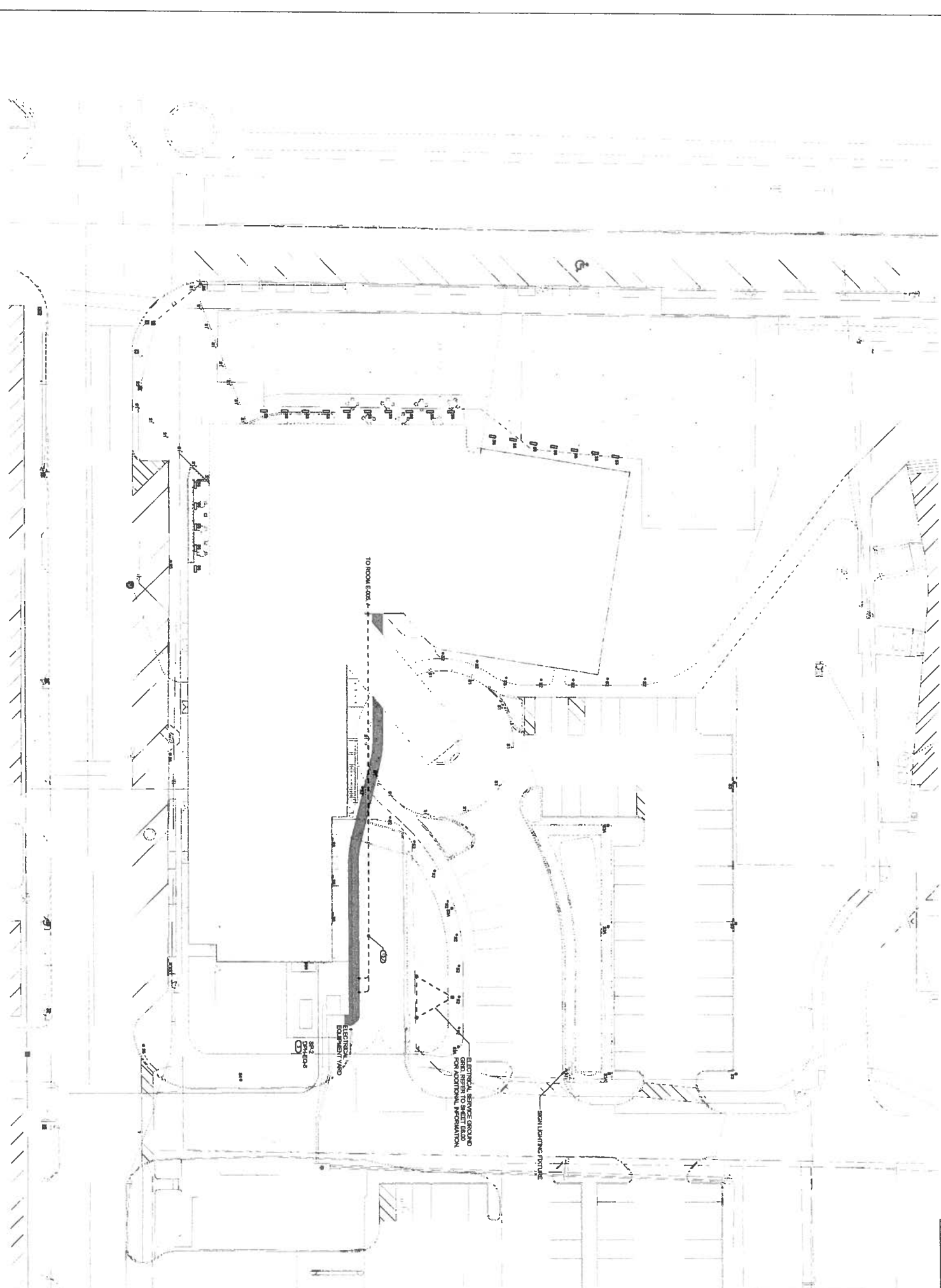

1 SITE PLAN - ELECTRICAL

- NOTES:**
1. REFER TO SHEET 2012007 ELECTRICAL GENERAL NOTES FOR GENERAL NOTES AND SPECIFICATIONS.
  2. ALL ELECTRICAL WORK SHALL BE PERFORMED IN ACCORDANCE WITH THE NATIONAL ELECTRICAL CODE (NEC) AND ALL APPLICABLE LOCAL CODES.
  3. ALL ELECTRICAL WORK SHALL BE PERFORMED BY A LICENSED ELECTRICIAN.
  4. ALL ELECTRICAL WORK SHALL BE PERFORMED IN ACCORDANCE WITH THE NATIONAL FIRE PROTECTION ASSOCIATION (NFPA) 70B PRACTICE STANDARDS FOR SAFETY IN MAINTENANCE AND REPAIR OF ELECTRICAL EQUIPMENT.

**LEGEND:**

- ES ELECTRICAL SERVICE EQUIPMENT AND CABINETS FOR ADDITIONAL INFORMATION
- SIL SIGN LIGHTING FIXTURE

**SCEF**  
Solomon  
Cordeiro  
Buenitz  
www.scef.com  
Chicago  
312.896.1100  
San Francisco  
415.218.2450  
Architectural Planning Interloc Design

**K I J**  
**ENGINEERING**  
**CONSULTANTS**  
ARCHITECTURE AND INTERIOR DESIGN  
1110 N. LAKE STREET  
CHICAGO, IL 60611  
PH: 312.321.8800  
WWW.KIJC.COM

NOT FOR CONSTRUCTION  
CONTRACT DOCUMENT  
PROGRESS SET 03.31.14

NO.	DESCRIPTION	DATE
1	ISSUED FOR PERMITTING	03/31/14
2	ISSUED FOR CONSTRUCTION	03/31/14
3	ISSUED FOR AS-BUILT	03/31/14

Oberlin, Ohio  
© 2014 Solomon Cordwell Buenitz  
**SITE PLAN -  
ELECTRICAL**

Drawn By: \_\_\_\_\_  
Checked By: \_\_\_\_\_  
Project Number: 2012007  
Sheet Number: **E1.00**

**SCP** Solomon Cordwell Buenz  
 www.scb.com  
 Chicago 312.896.1100  
 San Francisco 415.318.2450  
 Architecture Planning Interior Design

**K J** ENGINEERING CONSULTANTS  
 5050 LINDSAY DRIVE, SUITE 210  
 CHICAGO, ILLINOIS 60630  
 TEL: 312.771.7222 FAX: 312.771.7221  
 www.kjengineering.com  
 ARCHITECTS/ENGINEERS PROFESSIONAL SERVICE INCORPORATED  
 8722 LARAMIE AVE., SUITE 300  
 CHICAGO, ILLINOIS 60619  
 TEL: 312.467.8700 FAX: 312.467.8701  
 www.kj-engineering.com

**SECTIONAL MECHANICAL/ELECTRICAL**  
 THE MECHANICAL/ELECTRICAL SYSTEMS SHALL BE DESIGNED TO ACCOMMODATE ALL EQUIPMENT AND LOADS SHOWN ON THESE PLANS. THE CONTRACTOR SHALL VERIFY ALL LOADS AND CONDITIONS WITH THE MANUFACTURERS OF ALL EQUIPMENT. ALL WORK SHALL BE PERFORMED IN ACCORDANCE WITH THE NATIONAL ELECTRICAL CODE (NEC) AND THE NATIONAL MECHANICAL CODE (NMC).

**NOT FOR CONSTRUCTION  
 CONTRACT DOCUMENT  
 PROGRESS SET 03.31.14**

NO.	DATE	DESCRIPTION

OBERLIN GATEWAY BUILDING

Oberlin, Ohio  
 © 2011 Solomon Cordwell Buenz  
**SITE PHOTOMETRIC PLAN**

Drawn By: **E1.01**  
 Checked By:  
 Project Number: 2012007

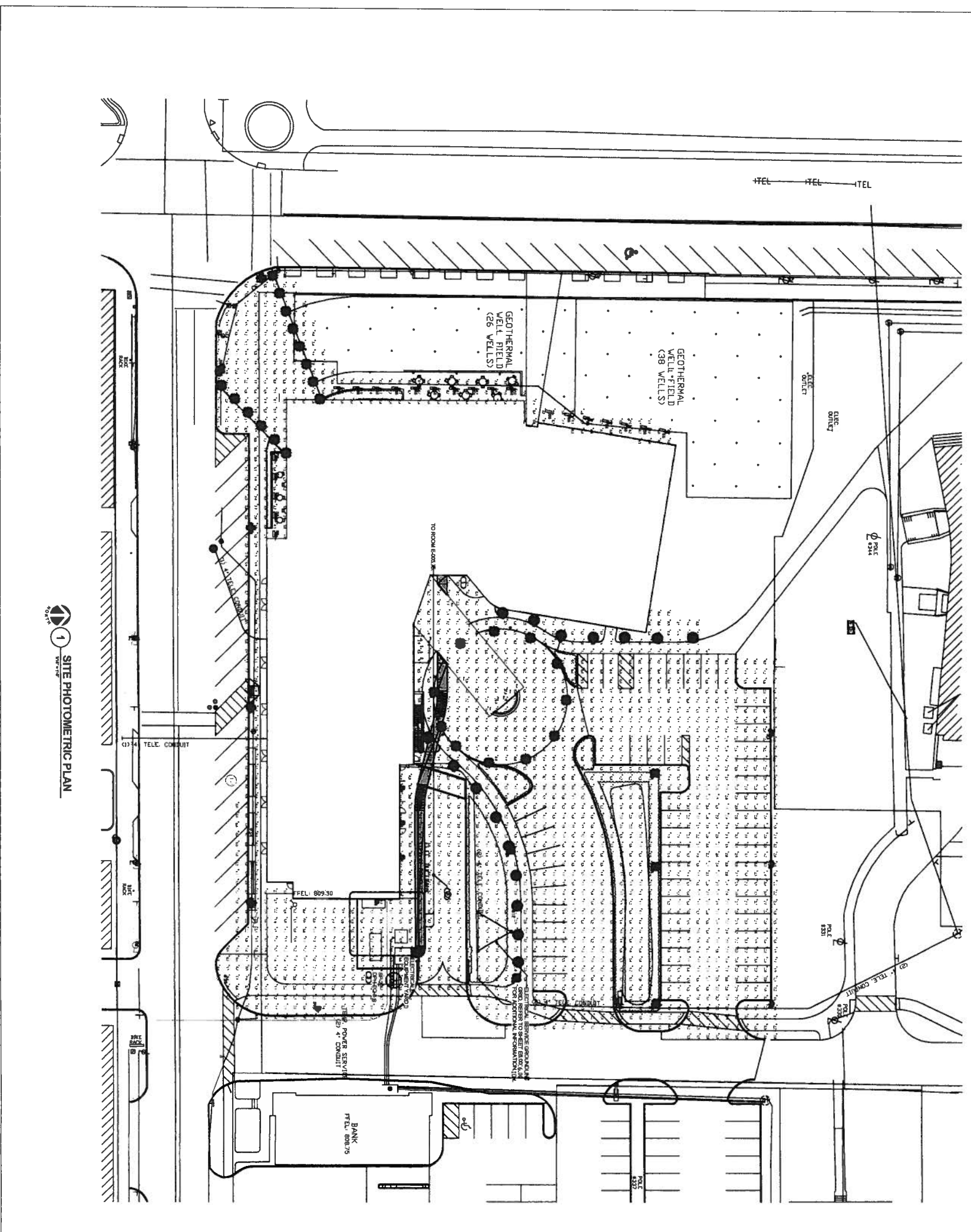

**1** SITE PHOTOMETRIC PLAN

**LEGEND**

1 - 1st FLOOR  
2 - 2nd FLOOR  
3 - 3rd FLOOR  
4 - 4th FLOOR  
5 - 5th FLOOR  
6 - 6th FLOOR  
7 - 7th FLOOR  
8 - 8th FLOOR  
9 - 9th FLOOR  
10 - 10th FLOOR  
11 - 11th FLOOR  
12 - 12th FLOOR  
13 - 13th FLOOR  
14 - 14th FLOOR  
15 - 15th FLOOR  
16 - 16th FLOOR  
17 - 17th FLOOR  
18 - 18th FLOOR  
19 - 19th FLOOR  
20 - 20th FLOOR  
21 - 21st FLOOR  
22 - 22nd FLOOR  
23 - 23rd FLOOR  
24 - 24th FLOOR  
25 - 25th FLOOR  
26 - 26th FLOOR  
27 - 27th FLOOR  
28 - 28th FLOOR  
29 - 29th FLOOR  
30 - 30th FLOOR  
31 - 31st FLOOR  
32 - 32nd FLOOR  
33 - 33rd FLOOR  
34 - 34th FLOOR  
35 - 35th FLOOR  
36 - 36th FLOOR  
37 - 37th FLOOR  
38 - 38th FLOOR  
39 - 39th FLOOR  
40 - 40th FLOOR  
41 - 41st FLOOR  
42 - 42nd FLOOR  
43 - 43rd FLOOR  
44 - 44th FLOOR  
45 - 45th FLOOR  
46 - 46th FLOOR  
47 - 47th FLOOR  
48 - 48th FLOOR  
49 - 49th FLOOR  
50 - 50th FLOOR

**LEGEND**

1 - 1st FLOOR  
2 - 2nd FLOOR  
3 - 3rd FLOOR  
4 - 4th FLOOR  
5 - 5th FLOOR  
6 - 6th FLOOR  
7 - 7th FLOOR  
8 - 8th FLOOR  
9 - 9th FLOOR  
10 - 10th FLOOR  
11 - 11th FLOOR  
12 - 12th FLOOR  
13 - 13th FLOOR  
14 - 14th FLOOR  
15 - 15th FLOOR  
16 - 16th FLOOR  
17 - 17th FLOOR  
18 - 18th FLOOR  
19 - 19th FLOOR  
20 - 20th FLOOR  
21 - 21st FLOOR  
22 - 22nd FLOOR  
23 - 23rd FLOOR  
24 - 24th FLOOR  
25 - 25th FLOOR  
26 - 26th FLOOR  
27 - 27th FLOOR  
28 - 28th FLOOR  
29 - 29th FLOOR  
30 - 30th FLOOR  
31 - 31st FLOOR  
32 - 32nd FLOOR  
33 - 33rd FLOOR  
34 - 34th FLOOR  
35 - 35th FLOOR  
36 - 36th FLOOR  
37 - 37th FLOOR  
38 - 38th FLOOR  
39 - 39th FLOOR  
40 - 40th FLOOR  
41 - 41st FLOOR  
42 - 42nd FLOOR  
43 - 43rd FLOOR  
44 - 44th FLOOR  
45 - 45th FLOOR  
46 - 46th FLOOR  
47 - 47th FLOOR  
48 - 48th FLOOR  
49 - 49th FLOOR  
50 - 50th FLOOR

NO.	DESCRIPTION	UNIT	QTY	UNIT PRICE	TOTAL PRICE	DATE	STATUS	REMARKS
1	CONCRETE WORK	1	100	100.00	100.00	2011-01-01	1	CONCRETE WORK
2	STEEL WORK	2	200	200.00	200.00	2011-01-01	2	STEEL WORK
3	MECHANICAL WORK	3	300	300.00	300.00	2011-01-01	3	MECHANICAL WORK
4	ELECTRICAL WORK	4	400	400.00	400.00	2011-01-01	4	ELECTRICAL WORK
5	PAINT WORK	5	500	500.00	500.00	2011-01-01	5	PAINT WORK
6	FINISH WORK	6	600	600.00	600.00	2011-01-01	6	FINISH WORK
7	FOUNDATION WORK	7	700	700.00	700.00	2011-01-01	7	FOUNDATION WORK
8	ROOF WORK	8	800	800.00	800.00	2011-01-01	8	ROOF WORK
9	MECHANICAL WORK	9	900	900.00	900.00	2011-01-01	9	MECHANICAL WORK
10	ELECTRICAL WORK	10	1000	1000.00	1000.00	2011-01-01	10	ELECTRICAL WORK

**DISCONNECT AND STARTER SCHEDULE**

NO.	DESCRIPTION	UNIT	QTY	UNIT PRICE	TOTAL PRICE
1	DISCONNECT	1	1	100.00	100.00
2	STARTER	2	2	200.00	400.00

**Lighting Sequence of Operation**

NO.	DESCRIPTION	UNIT	QTY	UNIT PRICE	TOTAL PRICE
1	Lighting Sequence of Operation	1	1	100.00	100.00

**TRANSFORMER SCHEDULE**

NO.	DESCRIPTION	UNIT	QTY	UNIT PRICE	TOTAL PRICE
1	TRANSFORMER	1	1	100.00	100.00

**TRANSFORMER SCHEDULE**

NO.	DESCRIPTION	UNIT	QTY	UNIT PRICE	TOTAL PRICE
1	TRANSFORMER	1	1	100.00	100.00

**VARIABLE FREQUENCY DRIVE SCHEDULE**

NO.	DESCRIPTION	UNIT	QTY	UNIT PRICE	TOTAL PRICE
1	VARIABLE FREQUENCY DRIVE	1	1	100.00	100.00

**VARIABLE FREQUENCY DRIVE SCHEDULE**

NO.	DESCRIPTION	UNIT	QTY	UNIT PRICE	TOTAL PRICE
1	VARIABLE FREQUENCY DRIVE	1	1	100.00	100.00

**TRANSFORMER SWITCH SCHEDULE**

NO.	DESCRIPTION	UNIT	QTY	UNIT PRICE	TOTAL PRICE
1	TRANSFORMER SWITCH	1	1	100.00	100.00

**TRANSFORMER SWITCH SCHEDULE**

NO.	DESCRIPTION	UNIT	QTY	UNIT PRICE	TOTAL PRICE
1	TRANSFORMER SWITCH	1	1	100.00	100.00

**TRANSFORMER SWITCH SCHEDULE**

NO.	DESCRIPTION	UNIT	QTY	UNIT PRICE	TOTAL PRICE
1	TRANSFORMER SWITCH	1	1	100.00	100.00

**TRANSFORMER SWITCH SCHEDULE**

NO.	DESCRIPTION	UNIT	QTY	UNIT PRICE	TOTAL PRICE
1	TRANSFORMER SWITCH	1	1	100.00	100.00

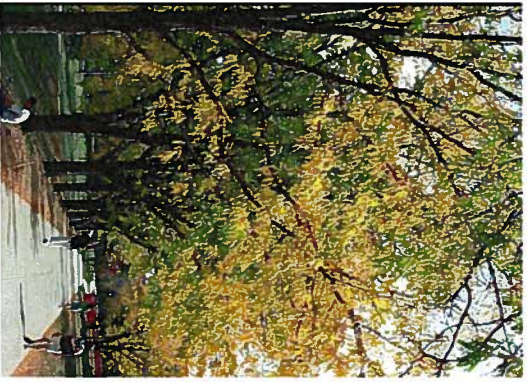

Honey Locust



River Birch

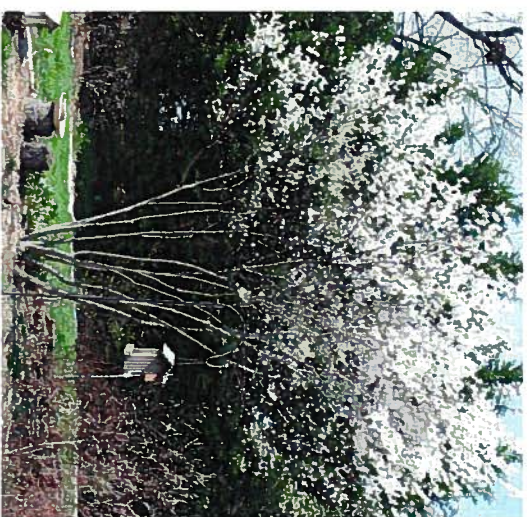

Serviceberry



Eastern Red Bud



Dwarf Fountain Grass



Oakleaf Hydrangea



Bowhall Maple



Feather Reed Grass



Japanese Bloodgrass

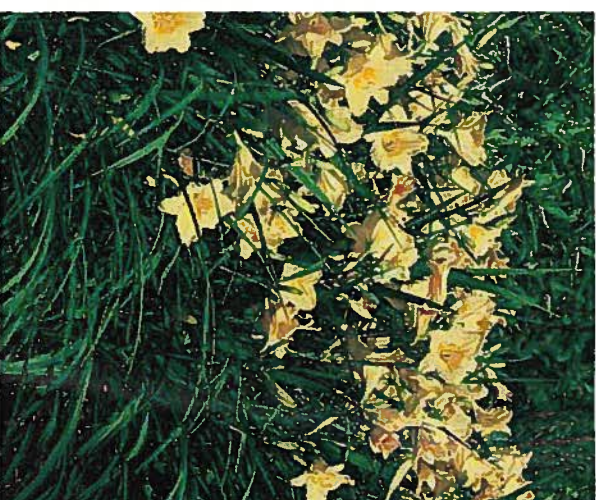

Happy Returns Daylily



Norway Spruce



London Planetree



Appalachian Sedge



Creeping Lilyturf



Ginkgo Biloba

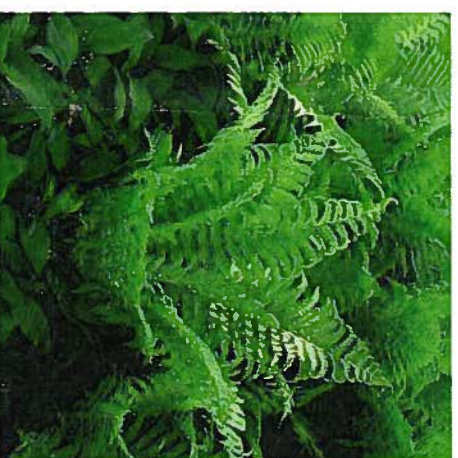

Ostrich Fern



Excelisa Arborvitae

Date: May 2014  
Project #: 13640

# Plant Material

Gateway Building - Oberlin College





**LEGEND**

[Symbol]	CONCRETE
[Symbol]	STANDARD ASPHALT PAVEMENT
[Symbol]	HEAVY DUTY ASPHALT PAVEMENT
[Symbol]	GRAVEL
[Symbol]	EXPANDED HALL AUDITORIUM LOT
[Symbol]	EXISTING PAVEMENT

**PROPOSED PARKING SPACES**

APPROVED BY P.C. (10/23/2013)	PROPOSED (6/13/2014)
ON-SITE PARKING SUMMARY	
PROPOSED OFF-STREET SPACES	50
PROPOSED OFF-STREET COMPACT SPACES	11
EAST PARKING LOT COMPACT SPACES	87
EAST PARKING LOT COMPACT SPACES	6
TOTAL ON-SITE SPACES PROVIDED	154
OFF-SITE PARKING SUMMARY	
EXPANDED HALL AUDITORIUM LOT	84
TOTAL PROPOSED SPACES (% OF OFF-STREET SPACES)	257
PERCENT COMPACT SPACES (% OF OFF-STREET SPACES)	7.1%
	16.8%

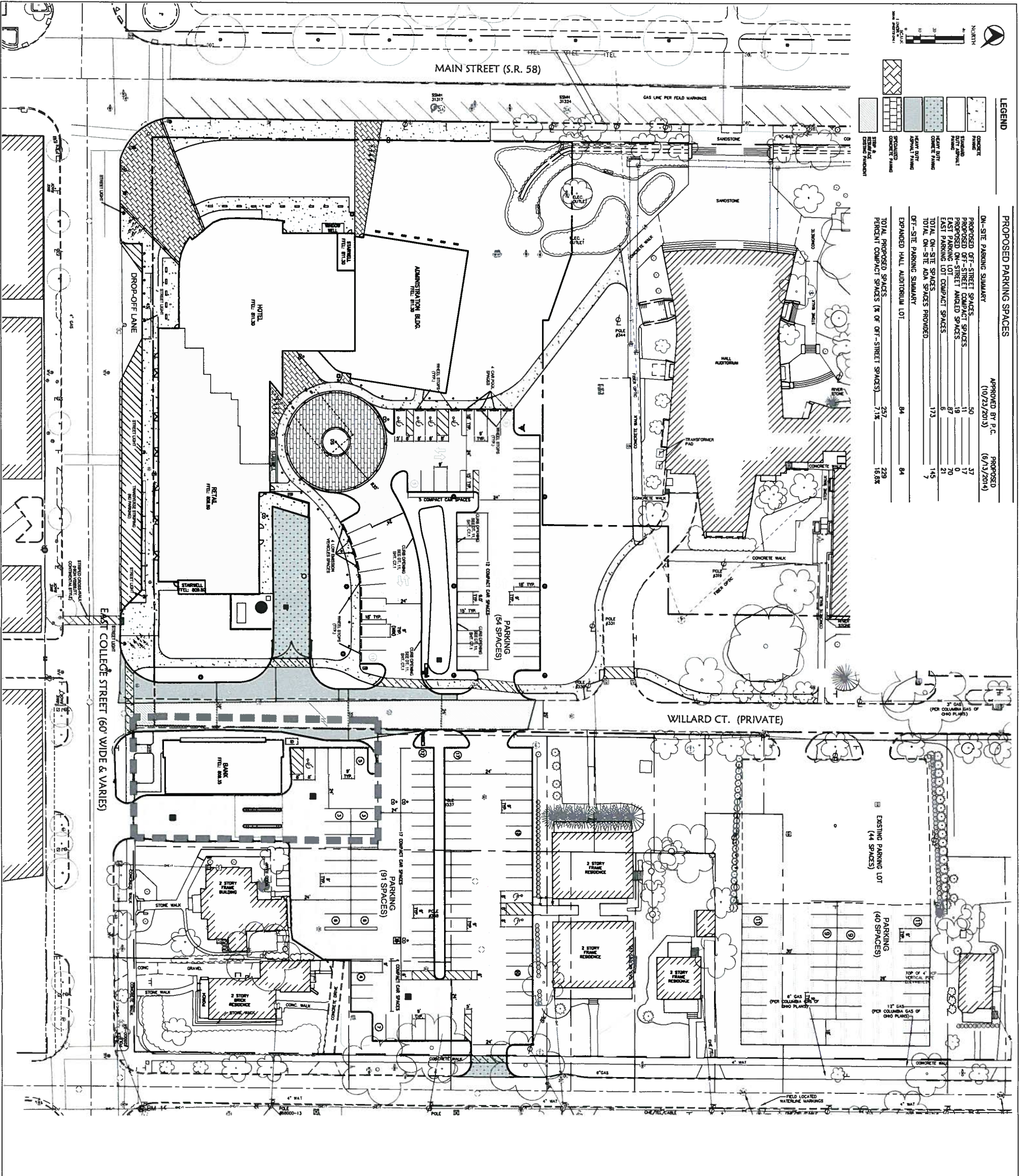

**SCP**  
Solomon  
Cordwell  
Bluntz  
www.scp.com  
Chicago 312.886.1100  
San Francisco 415.218.2450  
Architects Planning Interior Design



**REVISIONS**

NO.	DATE	DESCRIPTION
1	07/23/14	ISSUED FOR PERMITTING
2	07/23/14	ISSUED FOR PERMITTING
3	07/23/14	ISSUED FOR PERMITTING
4	07/23/14	ISSUED FOR PERMITTING
5	07/23/14	ISSUED FOR PERMITTING
6	07/23/14	ISSUED FOR PERMITTING
7	07/23/14	ISSUED FOR PERMITTING
8	07/23/14	ISSUED FOR PERMITTING
9	07/23/14	ISSUED FOR PERMITTING
10	07/23/14	ISSUED FOR PERMITTING
11	07/23/14	ISSUED FOR PERMITTING
12	07/23/14	ISSUED FOR PERMITTING
13	07/23/14	ISSUED FOR PERMITTING
14	07/23/14	ISSUED FOR PERMITTING
15	07/23/14	ISSUED FOR PERMITTING
16	07/23/14	ISSUED FOR PERMITTING
17	07/23/14	ISSUED FOR PERMITTING
18	07/23/14	ISSUED FOR PERMITTING
19	07/23/14	ISSUED FOR PERMITTING
20	07/23/14	ISSUED FOR PERMITTING

**OBERLIN COLLEGE  
GATEWAY BUILDING**

Drafting: [Name]  
Checked By: [Name]  
Project Number: 2012007

**SITE LAYOUT  
PLAN**

Sheet Number: **C5.0**