

City of Oberlin, Ohio

ORDINANCE No. 11- 60 AC CMS

AN ORDINANCE AUTHORIZING THE CITY MANAGER TO SUBMIT AN APPLICATION TO THE DISTRICT 9 PUBLIC WORKS INTEGRATING COMMITTEE FOR OHIO PUBLIC WORKS COMMISSION ISSUE II FUNDING FOR IMPROVMENTS TO THE INTERSECTION OF STATE ROUTE 58 AND STATE ROUTE 511 AND DECLARING AN EMERGENCY

BE IT ORDAINED by the Council of the City of Oberlin, County of Lorain, State of Ohio, five-sevenths (5/7ths) of all members elected thereto concurring:

SECTION 1. That the City Manager is hereby authorized and directed to prepare and file an application with the District 9 Public Works Integrating Committee for Ohio Public Works Commission Issue II Round 26 funding for the following project:

State Route 58 and State Route 511 Intersection Improvements

SECTION 2. That the City Manager is hereby authorized to accept said Issue II Round 26 funding if the application is approved.

SECTION 3. That the City of Oberlin hereby agrees that if said Issue II Round 26 project is funded, the City of Oberlin will provide local matching funds as designated in the application.

SECTION 4. It is hereby found and determined that all formal actions of this Council concerning or relating to the adoption of this ordinance were adopted in an open meeting of this Council, and that all deliberations of this Council and of any of its committees that resulted in such formal action, were in meetings open to the public in compliance with all legal requirements, including Section 121.22 of the Ohio Revised Code.

SECTION 5. That this ordinance is hereby declared to be an emergency measure necessary for the immediate preservation of the public peace, health or safety of the citizens of the City of Oberlin, Ohio, or to provide for the usual daily operation of a municipal department, to wit:

“in order to allow for the filing of an Issue II grant application in a timely manner”, and shall take effect immediately upon passage.

PASSED: 1st Reading — August 22, 2011 (S, E)
 2nd Reading —
 3rd Reading —

ATTEST:



BELINDA B. ANDERSON, CMC
CLERK OF COUNCIL

POSTED: 8/23/2011

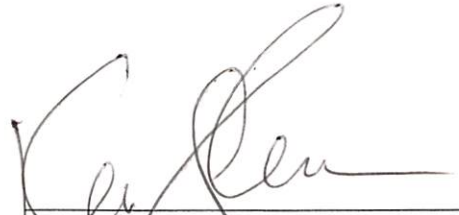

KENNETH SLOANE
PRESIDENT OF COUNCIL

EFFECTIVE DATE: 8/22/2011



SR 58 and SR 511 Intersection and Signalization Improvements



Public Works Department
85 South Main Street
Oberlin, Ohio 44074
Ph. (440) 775-7204

State of Ohio
Public Works Commission
Application for Financial Assistance

IMPORTANT: Please consult "Instructions for Financial Assistance for Capital Infrastructure Projects" for guidance in completion of this form.

Applicant

Applicant: City of Oberlin Subdivision Code: 093-57834
District Number: 9 County: Lorain Date: 08/24/2011
Contact: Jeff Baumann Phone: (440) 775-7204
(The individual who will be available during business hours and who can best answer or coordinate the response to questions)
Email: jbaumann@cityofoberlin.com FAX: (440) 775-7208

Project

Project Name: SR58 and SR511 Intersection and Signalization Improvements Zip Code: 44074
Subdivision Type (Select one) Project Type (Select single largest component by \$) Funding Request Summary (Automatically populates from page 2)
☐ 1. County ☒ 1. Road Total Project Cost: 351,899 .00
☒ 2. City ☐ 2. Bridge/Culvert 1 Grant: 84,399 .00
☐ 3. Township ☐ 3. Water Supply 2. Loan: 0 .00
☐ 4. Village ☐ 4. Wastewater 3. Loan Assistance/
☐ 5. Water (6119 Water District) ☐ 5. Solid Waste Credit Enhancement: 0 .00
☐ 6. Stormwater Funding Requested: 84,399 .00

District Recommendation (To be completed by the District Committee)

Funding Type Requested (Select one) SCIP Loan - Rate: _____ % Term: _____ Yrs Amount: _____ .00
☐ State Capital Improvement Program RLP Loan - Rate: _____ % Term: _____ Yrs Amount: _____ .00
☐ Local Transportation Improvement Program Grant: Amount: _____ .00
☐ Revolving Loan Program LTIP: Amount: _____ .00
☐ Small Government Program Loan Assistance / Credit Enhancement: Amount: _____ .00
District SG Priority: _____

For OPWC Use Only

STATUS Grant Amount: _____ .00 Loan Type: ☐ SCIP ☐ RLP
Project Number: C _____ Loan Amount: _____ .00 Date Construction End: _____
C _____ Total Funding: _____ .00 Date Maturity: _____
Release Date: _____ Local Participation: _____ % Rate: _____ %
OPWC Approval: _____ OPWC Participation: _____ % Term: _____ Yrs

1.0 Project Financial Information (All Costs Rounded to Nearest Dollar)

1.1 Project Estimated Costs

Engineering Services

Preliminary Design:	<u>5,860</u>	.00	
Final Design:	<u>23,440</u>	.00	
Construction Administration:	<u>29,300</u>	.00	
Total Engineering Services:	a.) <u>58,600</u>	.00	<u>22</u> %
Right of Way:	b.) _____	.00	
Construction:	c.) <u>266,635</u>	.00	
Materials Purchased Directly:	d.) _____	.00	
Permits, Advertising, Legal:	e.) _____	.00	
Construction Contingencies:	f.) <u>26,664</u>	.00	<u>10</u> %
Total Estimated Costs:	g.) <u>351,899</u>	.00	

1.2 Project Financial Resources

Local Resources

Local In-Kind or Force Account:	a.) _____	.00	
Local Revenues:	b.) <u>187,620</u>	.00	
Other Public Revenues:	c.) _____	.00	
ODOT / FHWA PID: <u>90937</u>	d.) <u>79,880</u>	.00	
USDA Rural Development:	e.) _____	.00	
OEPA / OWDA:	f.) _____	.00	
CDBG:	g.) _____	.00	
<input type="checkbox"/> County Entitlement or Community Dev. "Formula"			
<input type="checkbox"/> Department of Development			
Other: _____	h.) _____	.00	
Subtotal Local Resources:	i.) <u>267,500</u>	.00	<u>76</u> %

OPWC Funds (Check all requested and enter Amount)

Grant: <u>100</u> % of OPWC Funds	j.) <u>84,399</u>	.00	
Loan: <u>0</u> % of OPWC Funds	k.) _____	.00	
Loan Assistance / Credit Enhancement:	l.) <u>0</u>	.00	
Subtotal OPWC Funds:	m.) <u>84,399</u>	.00	<u>24</u> %
Total Financial Resources:	n.) <u>351,899</u>	.00	<u>100</u> %

1.3 Availability of Local Funds

Attach a statement signed by the Chief Financial Officer listed in section 5.2 certifying all local resources required for the project will be available on or before the earliest date listed in the Project Schedule section. The OPWC Agreement will not be released until the local resources are certified. Failure to meet local share may result in termination of the project. Applicant needs to provide written confirmation for funds coming from other funding sources.

2.0 Repair / Replacement or New / Expansion

2.1 Total Portion of Project Repair / Replacement:	<u>211,247 .00</u>	<u>60</u> %	A Farn and Pr en nio. le is required for any mpac to n nia
2.2 Total Portion of Project New / Expansion:	<u>140,652 .00</u>	<u>40</u> %	
2.3 Total Project:	<u>351,899 .00</u>	<u>100</u> %	

3.0 Project Schedule

3.1 Engineering / Design / Right of Way	Begin Date: <u>03/05/2012</u>	End Date: <u>06/04/2012</u>
3.2 Bid Advertisement and Award	Begin Date: <u>06/09/2012</u>	End Date: <u>07/09/2012</u>
3.3 Construction	Begin Date: <u>07/23/2012</u>	End Date: <u>12/17/2012</u>

Construction cannot begin prior to release of executed Project Agreement and issuance of Notice to Proceed.

Failure to meet project schedule may result in termination of agreement for approved projects.
Modification of dates must be requested in writing by project official of record and approved by the Commission once the Project Agreement has been executed.

4.0 Project Information

If the project is multi-jurisdictional, information must be consolidated in this section.

4.1 Useful Life / Cost Estimate / Age of Infrastructure

Project Useful Life: 20 Years Age: 1997 (Year built or year of last major improvement)

Attach Registered Professional Engineer's statement, with seal or stamp and signature confirming the project's useful life indicated above and detailed cost estimate.

4.2 User Information

Road or Bridge: Current ADT 12,592 Year 2011 Projected ADT 14,128 Year 2031

Water / Wastewater: Based on monthly usage of 4,500 gallons per household; attach current ordinances.

Residential Water Rate Current \$ _____ Proposed \$ _____

Number of households served: 0

Residential Wastewater Rate Current \$ _____ Proposed \$ _____

Number of households served: 0

Stormwater: Number of households served: 0

4.3 Project Description

- A: **SPECIFIC LOCATION** (Supply a written location description that includes the project termini; a map does not replace this requirement.) 500 character limit.

This project will take place at the intersection of state routes 58 and 511 in Oberlin. The project termini are approximately 100' north and south on SR58 and 100' east and west on SR511. (See maps).

- B: **PROJECT COMPONENTS** (Describe the specific work to be completed; the engineer's estimate does not replace this requirement) 1,000 character limit.

To improve intersection function from LOS D (estimated) to LOS C (calculated, year 2031) the project will include:

- 1) Corner radius improvements (NE, NW, SE) (SW TBD) to facilitate truck traffic movements and allow right-on-red traffic movements
- 2) Replacement of the existing diagonal pole/mast arm traffic signal system with a "box-style" system to match existing traffic signal systems at the intersections of SR58/College and SR58/Vine streets
- 3) Energy efficient LED signal heads
- 4) New traffic controller
- 5) The Opticom fire department traffic control system to provide truck-activated radio frequency control to place all 4 signals in stop (red) mode
- 6) Pedestrian walk/don't walk signs with countdown indicators and hand-activated controls. May include audio signal and diagonal pedestrian crossing movements to facilitate access to the Middle School 1/2 block to the north on SR58
- 7) Re-alignment of crosswalks/sidewalks and new ADA compliant sidewalk ramps

- C: **PHYSICAL DIMENSIONS** (Describe the physical dimensions of the existing facility and the proposed facility. Include length, width, quantity and sizes, mgd capacity, etc in detail.) 500 character limit.

SR511 is 28' wide; north leg of SR58 is 32' wide, south leg is 50' wide with diagonal parking on the east and parallel parking on the west. Turn-out radii on all 4 corners is approximately 25'. 775' of curb will be replaced and new base and paving layers will be installed to provide tapered approaches and to increase turn-out radii to about 50'. The project will extend approximately 100' north, south, east, and west from the intersection of the center-lines of the state highways.

5.0 Project Officials

Changes in Project Officials must be submitted in writing from an officer of record.

5.1 Chief Executive Officer

(Person authorized in legislation to sign project agreements)

Name: Eric P. Norenberg

Title: City Manager

Address: 85 South Main St.

City: Oberlin State: OH Zip: 44074

Phone: (440) 775-7206

FAX: (440) 775-7208

E-Mail: enorenberg@cityofoberlin.com

5.2 Chief Financial Officer

(Can not also serve as CEO)

Name: I. Salvatore Talarico

Title: Finance Director

Address: 69 South Main St.

City: Oberlin State: OH Zip: 44074

Phone: (440) 775-7210

FAX: (440) 776-2090

E-Mail: stalarico@cityofoberlin.com

5.3 Project Manager

Name: Jeff Baumann

Title: Public Works Director

Address: 85 South Main St.

City: Oberlin State: OH Zip: 44074

Phone: (440) 775-7204

FAX: (440) 775-7208

E-Mail: jbaumann@cityofoberlin.com

6.0 Attachments / Completeness review

Confirm in the boxes below that each item listed is attached (Check each box)

- ☒ A certified copy of the legislation by the governing body of the applicant authorizing a designated official to sign and submit this application and execute contracts. This individual should sign under 7.0, Applicant Certification, below.
- ☒ A certification signed by the applicant's chief financial officer stating the amount of all local share funds required for the project will be available on or before the dates listed in the Project Schedule section. If the application involves a request for loan (RLP or SCIP), a certification signed by the CFO which identifies a specific revenue source for repaying the loan also must be attached. Both certifications can be accomplished in the same letter.
- ☒ A registered professional engineer's detailed cost estimate and useful life statement, as required in 164-1-13, 164-1-14, and 164-1-16 of the Ohio Administrative Code. Estimates shall contain an engineer's seal or stamp and signature.
- ☐ A cooperative agreement (if the project involves more than one subdivision or district) which identifies the fiscal and administrative responsibilities of each participant.
- ☐ Farmland Preservation Review - The Governor's Executive Order 98-IV, "Ohio Farmland Protection Policy" requires the Commission to establish guidelines on how it will take protection of productive agricultural and grazing land into account in its funding decision making process. Please include a Farm Land Preservation statement for projects that have an impact on farmland.
- ☒ Capital Improvements Report. CIR Required by O.R.C. Chapter 164.06 on standard form.
- ☒ Supporting Documentation: Materials such as additional project description, photographs, economic impact (temporary and/or full time jobs likely to be created as a result of the project), accident reports, impact on school zones, and other information to assist your district committee in ranking your project. Be sure to include supplements which may be required by your local District Public Works Integrating Committee.

7.0 Applicant Certification

The undersigned certifies: (1) he/she is legally authorized to request and accept financial assistance from the Ohio Public Works Commission as identified in the attached legislation; (2) to the best of his/her knowledge and belief, all representations that are part of this application are true and correct; (3) all official documents and commitments of the applicant that are part of this application have been duly authorized by the governing body of the applicant; and, (4) should the requested financial assistance be provided, that in the execution of this project, the applicant will comply with all assurances required by Ohio Law, including those involving Buy Ohio and prevailing wages.

Applicant certifies that physical construction on the project as defined in the application has NOT begun, and will not begin until a Project Agreement for this project has been executed with the Ohio Public Works Commission. Action to the contrary will result in termination of the agreement and withdrawal of Ohio Public Works Commission funding from the project.

Eric P. Norenberg, City Manager

Certifying Representative (Printed form, Type or Print Name and Title)

Original Signature / Date Signed

City of Oberlin, Ohio

ORDINANCE No. 11- 60 AC CMS

AN ORDINANCE AUTHORIZING THE CITY MANAGER TO SUBMIT AN APPLICATION TO THE DISTRICT 9 PUBLIC WORKS INTEGRATING COMMITTEE FOR OHIO PUBLIC WORKS COMMISSION ISSUE II FUNDING FOR IMPROVMENTS TO THE INTERSECTION OF STATE ROUTE 58 AND STATE ROUTE 511 AND DECLARING AN EMERGENCY

BE IT ORDAINED by the Council of the City of Oberlin, County of Lorain, State of Ohio, five-sevenths (5/7ths) of all members elected thereto concurring:

SECTION 1. That the City Manager is hereby authorized and directed to prepare and file an application with the District 9 Public Works Integrating Committee for Ohio Public Works Commission Issue II Round 26 funding for the following project:

State Route 58 and State Route 511 Intersection Improvements

SECTION 2. That the City Manager is hereby authorized to accept said Issue II Round 26 funding if the application is approved.

SECTION 3. That the City of Oberlin hereby agrees that if said Issue II Round 26 project is funded, the City of Oberlin will provide local matching funds as designated in the application.

SECTION 4. It is hereby found and determined that all formal actions of this Council concerning or relating to the adoption of this ordinance were adopted in an open meeting of this Council, and that all deliberations of this Council and of any of its committees that resulted in such formal action, were in meetings open to the public in compliance with all legal requirements, including Section 121.22 of the Ohio Revised Code.

SECTION 5. That this ordinance is hereby declared to be an emergency measure necessary for the immediate preservation of the public peace, health or safety of the citizens of the City of Oberlin, Ohio, or to provide for the usual daily operation of a municipal department, to wit:

"in order to allow for the filing of an Issue II grant application in a timely manner", and shall take effect immediately upon passage.

PASSED: 1st Reading — August 22, 2011 (S, E)
 2nd Reading —
 3rd Reading —



**AUDITOR'S CERTIFICATE
(Chief Fiscal Officer)**

Relative to the City of Oberlin

State Route 58 and State Route 511 Intersection and Signalization Improvement Project

I hereby certify that the local share estimated amount of \$187,620.00 required to meet the City of Oberlin's portion of the Contract, Agreement, obligation, payment, or expenditure for the above project will be available on or before July 1, 2012 in the City's Electric Replacement Reserve Fund and/or the Income Tax Capital Improvement Fund.

Dated: August 28, 2011

I. Salvatore Talarico

Finance Director, City of Oberlin

Estimate of Probable Construction Costs
City of Oberlin, Lorain County
SR58-SR511 Intersection and Signalization Improvements

8/9/2011

ITEM NO.	ODOT SPEC. ITEM NO.	QTY		ITEM DESCRIPTION	UNIT PRICE \$	TOTAL AMOUNT \$
1	201	1	LUMP	Clearing and Grubbing	\$5,000.00	\$5,000.00
2	202	2200	Sq Ft	Walk Removed	\$2.00	\$4,400.00
3	202	600	Sq Ft	Walk Removed, As per plan	\$2.50	\$1,500.00
4	202	850	Lin. Ft	Curb Removed	\$5.00	\$4,250.00
5	203	300	Cu.Yd.	Excavation	\$20.00	\$6,000.00
6	304	110	Cu.Yd.	Aggregate Base	\$50.00	\$5,500.00
7	448	175	Cu.Yd.	Asphalt Pavement	\$200.00	\$35,000.00
8	608	2150	Sq Ft	4" Concrete Walk	\$5.00	\$10,750.00
9	608	8	Each	Curb Ramp, with Truncated Domes, as per plan	\$1,000.00	\$8,000.00
10	608	650	Sq Ft	Walkway, Misc.: Brick Pavers	\$10.00	\$6,500.00
11	608	775	Lin. Ft	Curb, Type 6	\$20.00	\$15,500.00
12	625	750	Lin. Ft.	Conduit 2", 725.05, as per plan	\$6.00	\$4,500.00
13	625	500	Lin. Ft.	Conduit 3", 725.05, as per plan	\$13.00	\$6,500.00
14	625	100	Lin. Ft.	Conduit 4", 725.05, as per plan	\$17.00	\$1,700.00
15	625	100	Lin. Ft.	4" Conduit, type E, 707.31	\$4.80	\$480.00
16	625	1200	Lin. Ft.	No. 12 AWG Pole and Bracket Cable	\$0.75	\$900.00
17	625	600	Lin. Ft.	12 Conductor UF Cable (For GFI Outlets)	\$1.00	\$600.00
18	625	8	Each	Luminaire, Decorative, as per plan	\$300.00	\$2,400.00
19	625	100	Lin. Ft.	Trench in paved area, type B, as per plan	\$35.00	\$3,500.00
20	625	800	Lin. Ft.	Trench, 30" deep	\$4.00	\$3,200.00
21	625	900	Lin. Ft.	Special - Plastic Caution Tape	\$0.30	\$270.00
22	625	10	Each	Pull Box, Misc.: 13" x 24"	\$350.00	\$3,500.00
23	625	3	Each	Pull Box, Misc.: 17" x 30"	\$450.00	\$1,350.00
24	625	7	Each	Ground Rod	\$125.00	\$875.00
25	625	1	Each	Ground Rod, as per plan	\$125.00	\$125.00
26	630	1	Each	Sign hanger assembly, mast arm, as per plan	\$200.00	\$200.00
27	630	5	Sq Ft	Sign, flat sheet	\$15.00	\$75.00

Estimate of Probable Construction Costs
City of Oberlin, Lorain County
SR58-SR511 Intersection and Signalization Improvements

8/9/2011

ITEM NO.	ODOT SPEC. ITEM NO.	QTY		ITEM DESCRIPTION	UNIT PRICE \$	TOTAL AMOUNT \$
28	632	8	Each	Vehicular signal head with LED lamp units, 3 section, 12" lens Polycarbonate - 1-Way, as per plan	\$775.00	\$6,200.00
29	632	8	Each	Ped signal head with LED lamps, Type D-2, as per plan	\$480.00	\$3,840.00
30	632	8	Each	Covering of vehicular Signal Head	\$20.00	\$160.00
31	632	8	Each	Pedestrian Pushbutton, As Per Plan	\$85.00	\$680.00
32	632	5	Each	Detector Loop	\$1,500.00	\$7,500.00
33	632	5	Each	Loop Detector Unit, 2 Channel AS Per Plan	\$250.00	\$1,250.00
34	632	800	Lin. Ft.	Signal cable, 3 conductor, No. 14 AWG	\$1.10	\$880.00
35	632	1500	Lin. Ft.	Signal cable, 7 conductor, No. 14 AWG	\$1.95	\$2,925.00
36	632	800	Lin. Ft.	Signal cable, Misc.; Preempt detector cable, as per plan	\$1.00	\$800.00
37	632	4	Each	Signal Support Foundation	\$3,000.00	\$12,000.00
38	632	4	Each	Pedestal Foundation	\$500.00	\$2,000.00
39	632	2000	Lin. Ft.	Loop Detector Lead-in Cable	\$2.00	\$4,000.00
40	632	150	Lin. Ft.	Power cable, 3 conductor, No. 6 AWG	\$4.00	\$600.00
41	632	1	Each	Conduit Riser, 2" diameter	\$330.00	\$330.00
42	632	4	Each	Signal Support, Type TC-81.20, Design 3, As Per Plan	\$10,500.00	\$42,000.00
43	632	4	Each	Pedestal, 8' Transformer base, As Per Plan	\$750.00	\$3,000.00
44	632	1	Each	Removal of Traffic Signal Installation, as per plan	\$1,500.00	\$1,500.00
45	632	1	Each	Signalization Misc.: Radio Interconnect	\$4,500.00	\$4,500.00
46	632	4	Each	Signalization misc.;Preempt Detector, Single channel, 1 direction	\$670.00	\$2,680.00
47	632	4	Each	Signalization misc.; Preempt Confirmation Light	\$230.00	\$920.00
48	632	4	Each	Signalization Misc.: Foundation Test Hole	\$200.00	\$800.00
49	633	1	Each	Controller Unit, Type TS2/A2, with Cabinet Type TS1, as per plan	\$10,000.00	\$10,000.00
50	633	1	Each	Cabinet Riser	\$510.00	\$510.00
51	633	1	Each	Controller Item Misc.: Preempt Phase Selector	\$5,500.00	\$5,500.00
52	633	1	Each	Controller Item Misc.: Battery backup system	\$3,500.00	\$3,500.00
53	633	1	Each	Cabinet Foundation	\$585.00	\$585.00

Estimate of Probable Construction Costs
City of Oberlin, Lorain County
SR58-SR511 Intersection and Signalization Improvements

8/9/2011

ITEM NO.	ODOT SPEC. ITEM NO.	QTY		ITEM DESCRIPTION	UNIT PRICE \$	TOTAL AMOUNT \$
54	633	1	Each	Controller Work Pad	\$400.00	\$400.00
55	633	1	Lump	Controller Item Misc.: Furnish Spare Controller Equipment	\$4,500.00	\$4,500.00
56	103	1	Lump	Contract Performance Bond	\$1,500.00	\$1,500.00
57	614	1	Lump	Maintaining traffic	\$5,000.00	\$5,000.00
58	623	1	Lump	Construction layout stakes	\$2,500.00	\$2,500.00
59	624	1	Lump	Mobilization	\$1,500.00	\$1,500.00
				SUBTOTAL		\$266,635.00
				Contingencies (10%)		\$26,665.00
				Estimated Construction Cost		\$293,300.00
				Design (10%)		\$29,300.00
				Bidding, Construction Engineering & Inspection (10%)		\$29,300.00
				Total Estimated Project Cost		\$351,900.00

The estimated Useful Life of the Main St. / Lorain St. Improvements is 20 years.

Prepared by:
TMS Engineers, Inc.
K.E.McCartney & Associates, Inc.



James D. Mawhor
K.E. McCARTNEY & ASSOCIATES, INC.

AUGUST 9 2011

Ohio Public Works Commission

Five Year Capital Improvement Plan/Maintenance of Effort

City of Oberlin	093-57834	Lorain	August, 2011						
Subdivision	Code	County	Date						
			2010	2011	2012	2013	2014	2015	2016
					1	2	3	4	5

Project Name/Description	Funding Codes(s)	Status (A) Active (C) Complete	Total Cost	Two Year Effort		Five Year Plan				
				Yr - 2010	Yr - 2011	Yr - 2012 Planned	Yr - 2013	Yr - 2014	Yr - 2015	Yr - 2016

Roads										
YEAR										
2010	East College St./Oberlin Rd		C	\$ 157,800						
2010	S. Pleasant St		C	\$ 68,300						
2010	S Prospect (Issue 2)		C	\$ 298,700						
2010	Bike Path Crack Filling		C	\$ 7,800						
2010	Crack Seal Various Streets		C	\$ 24,300						
2010	Resurface Smith, King, Cedar, and Oak St.		A	\$ 274,700						
2011	N. Professor St		A	\$ 666,000						
2011	Artino St		A	\$ 272,000						
2011	Stem St		A	\$ 2,300						
2011	Pavement Maintenance		A	\$ 60,000						
2011	Sumner		A	\$ 84,820						
2012	Elm St			\$ 72,000						
2012	Prospect St			\$ 599,700						
2012	Prospect St			\$ 232,900						
2012	Prospect St			\$ 224,200						
2012	Robin Park Lane			\$ 42,900						
2012	Robin Park Lane			\$ 34,100						
2012	Robin Park Lane			\$ 24,900						
2012	Vine St			\$ 169,100						
2012	SR58/SR511 Intersection Improvement			\$ 351,899						
2012	Parkwood			\$ 40,200						
2012	Parkwood			\$ 40,200						
2012	Pavement Maintenance			\$ 90,000						
2013	S. Professor St.			\$ 163,200						
2013	S. Professor St.			\$ 122,800						
2013	S. Professor St.			\$ 72,200						
2013	S. Professor St.			\$ 124,900						
2013	S. Professor St.			\$ 92,400						
2013	S. Professor St.			\$ 49,900						

Ohio Public Works Commission

Five Year Capital Improvement Plan/Maintenance of Effort

City of Oberlin	093-57834	Lorain	August, 2011
Subdivision	Code	County	Date
		2010	2011
		2012	2013
		2014	2015
		2016	2017

Project Name/Description	Funding Codes(s)	Status (A) Active (C) Complete	Total Cost	Two Year Effort		Five Year Plan				
				Yr - 2010	Yr - 2011	Yr - 2012 Planned	Yr - 2013	Yr - 2014	Yr - 2015	Yr - 2016
2013 S. Professor St.			\$ 99,200				\$99,200			
2013 S. Professor St.			\$ 94,400				\$94,400			
2013 Pavement Maintenance			\$ 90,000				\$90,000			
2014 East College St.			\$ 156,600					\$156,600		
2014 East College St.			\$ 73,800					\$73,800		
2014 Edgemere Place			\$ 11,900					\$11,900		
2014 Edgemere Place			\$ 70,200					\$70,200		
2014 Groveland St.			\$ 165,700					\$165,700		
2014 Groveland St.			\$ 124,400					\$124,400		
2014 Groveland St.			\$ 151,900					\$151,900		
2014 N. Pleasant St.			\$ 128,700					\$128,700		
2014 West College St. (Split Segment)			\$ 201,200					\$201,200		
2014 Pavement Maintenance			\$ 90,000					\$90,000		
2015 RT 58			\$ 593,000						\$593,000	
2015 SR 511			\$ 2,489,400						\$2,489,400	
2015 Pavement Maintenance			\$ 90,000						\$90,000	
2016 East College St.			\$ 173,900							\$173,900
2016 East College St.			\$ 249,600							\$249,600
2016 East College St.			\$ 86,700							\$86,700
2016 East College St.			\$ 217,100							\$217,100
2016 East College St.			\$ 195,000							\$195,000
2016 East College St.			\$ 277,500							\$277,500
Roads - Subtotals			\$ 10,295,419	\$ 832,600	\$ 1,085,120	\$ 1,922,099	\$ 909,000	\$ 1,174,400	\$ 3,172,400	\$ 1,199,800
Roads - Repairs/Needs Amounts - (as currently projected)						\$ 8,377,699				

Ohio Public Works Commission

Five Year Capital Improvement Plan/Maintenance of Effort

City of Oberlin
Subdivision

093-57834
Code

Lorain
County

August, 2011
Date

2010	2011	2012	2013	2014	2015	2016
		1	2	3	4	5

Project Name/Description	Funding Codes(s)	Status (A) Active (C) Complete	Total Cost	Two Year Effort		Five Year Plan				
				Yr - 2010	Yr - 2011	Yr - 2012 Planned	Yr - 2013	Yr - 2014	Yr - 2015	Yr - 2016

Bridges

YEAR										
2012	Park Street Bridge Repl. Constr.		\$ 444,800			\$444,800				
2012	Oberlin Rd Bridge Repl.		\$ 380,000			\$380,000				
2014	Pyle S. Amherst Bridge Repl.		\$ 390,000					\$390,000		
	Bridges - Subtotals		\$ 1,214,800	\$ -	\$ -	\$ 824,800	\$ -	\$ 390,000	\$ -	\$ -
	Bridges - Repairs/Needs Amounts - (as currently projected)					\$ 1,214,800				

Culverts

YEAR										
2015	Evans Ditch @ S. Main		\$ 86,000						\$86,000	
	Culverts - Subtotals		\$ 86,000	\$ -	\$ -	\$ -	\$ -	\$ -	\$ 86,000	\$ -
	Culverts - Repairs/Needs Amounts - (as currently projected)					\$ 86,000				

Water Supply Systems

YEAR										
2010	Distribution Bldg Improvements Design	C	\$ 8,300							
2011	Distribution Bldg Rehab	A	\$ 99,415		\$99,415					
2012	Aeration and Mixing Equipment for Elevated Towers		\$ 121,400			\$121,400				
2013	Generator Upgrades		\$ 35,000				\$35,000			
2013	South Elevated Tank Construction - Debt		\$ 125,000				\$125,000			
2014	Southern Elevated Tank Design		\$ 95,000					\$95,000		
2015	Southern Elevated Tank Construction Payment		\$ 95,000							
2016	Southern Elevated Tank Construction Payment		\$ 95,000							\$95,000
	Water Supply Systems - Subtotals		\$ 674,115	\$ 8,300	\$ 99,415	\$ 121,400	\$ 160,000	\$ 95,000	\$ 95,000	\$ 95,000
	Water Supply Systems - Repairs/Needs Amounts - 10 Year (as currently projected)					\$ 566,400				

Ohio Public Works Commission

Five Year Capital Improvement Plan/Maintenance of Effort

City of Oberlin	093-57834	Lorain	August, 2011
Subdivision	Code	County	Date
		2010	2011
		2012	2013
		2014	2015
		2016	2017

Project Name/Description	Funding Codes(s)	Status (A) Active (C) Complete	Total Cost	Two Year Effort		Five Year Plan				
				Yr - 2010	Yr - 2011	Yr - 2012 Planned	Yr - 2013	Yr - 2014	Yr - 2015	Yr - 2016

Water Distribution Systems										
2010	East College St.	C	\$ 192,821	\$ 192,821						
2010	Meter Replacements	A	\$ 60,000	\$ 60,000						
2011	Woodland Ave.	A	\$ 157,810		\$ 157,810					
2011	S. Main St.	A	\$ 79,315		\$ 79,315					
2011	Meter Replacements	A	\$ 30,000		\$ 30,000					
2012	S. Main St. PH 3	A	\$ 165,000							
2012	Oberlin Rd Bridge		\$ 35,000			\$ 165,000				
2012	Meter Replacements		\$ 30,000			\$ 35,000				
2013	S. Professor St.		\$ 30,000			\$ 30,000				
2013	Meter Replacements		\$ 35,000			TBD				
2014	Forest St.		\$ 125,900			\$ 125,900				
2015	SR511 select replacements		\$ 167,694			\$ 167,694				
2016	South Loop Phase 1		\$ 66,500					\$ 350,000		
2016	South Loop Phase 2		\$ -					\$ 66,500		
			\$ -					TBD		
	Water Distribution Systems - Subtotals		\$ 1,495,040	\$ 252,821	\$ 267,125	\$ 230,000	\$ 35,000	\$ 293,594	\$ 350,000	\$ 66,500
	Water Distribution - Repairs/Needs Amounts - 10 Year (as currently projected)			\$ 975,094						

Wastewater Systems										
2010	Perforated Plate Screen	C	\$ 198,000	\$ 198,000						
2011	Influent Channel Improvements	A	\$ 140,000		\$ 140,000					
2011	Waste Heat Recovery Study	A	\$ 25,000		\$ 25,000					
2012	Belt Press Improvements		\$ 35,000			\$ 35,000				
2012	Roof Repairs		\$ 35,000			\$ 35,000				
2012	Phosphorus Study		\$ 25,000			\$ 25,000				
2012	Standby Generator		\$ 125,000			\$ 125,000				
2013	Digester Rehabilitation		\$ 175,000			\$ 175,000				
2014	New Influent Channel Screen		\$ 210,000			\$ 210,000				
2015	Additional Sand Filter Beds		\$ 790,000			\$ 790,000				
2016	Blower Replacement		\$ 175,000					\$ 175,000		
	Wastewater Systems - Subtotal		\$ 1,933,000	\$ 198,000	\$ 165,000	\$ 220,000	\$ 175,000	\$ 210,000	\$ 790,000	\$ 175,000
	Wastewater Collection - Repairs/Needs Amounts - 5 Year (as currently projected)			\$ 1,570,000						

Ohio Public Works Commission

Five Year Capital Improvement Plan/Maintenance of Effort

City of Oberlin	093-57834	Lorain	August, 2011
Subdivision	Code	County	Date
		2010	2011
		2012	2013
		2014	2015
		2016	2017

YEAR	Project Name/Description	Funding Codes(s)	Status (A) Active (C) Complete	Total Cost	Two Year Effort		Five Year Plan				
					Yr - 2010	Yr - 2011	Yr - 2012 Planned	Yr - 2013	Yr - 2014	Yr - 2015	Yr - 2016
Wastewater Collection											
2010	Prospect St		C	\$ 96,074	\$96,074						
2011	Artino St. Lift Station Rehab			\$ 100,000		\$100,000					
2011	S Main		C	\$ 88,100		\$88,100					
2012	I&I Study			\$ 35,000			\$35,000				
2012	Vin/South Professor/Morgan Trunk			\$ 300,000			\$300,000				
2013	S. Professor St			\$ 204,000			\$204,000				
2013	S. Professor St			\$ 141,600			\$141,600				
2013	S. Professor St			\$ 66,800			\$66,800				
2013	S. Professor St			\$ 83,100			\$83,100				
2013	S. Main St			\$ 60,000			\$60,000				
2014	Groveland St			\$ 98,900				\$99,900			
2014	Groveland St			\$ 98,800				\$98,800			
2014	Morgan St			\$ 137,200				\$137,200			
2014	Morgan St			\$ 187,300				\$187,300			
2014	West College St. (Split Segment)			\$ 68,300				\$68,300			
2015	Select Improvements SR511/SR58			\$ 350,000							
2016	Select Improvements phased with Street Projects			\$ 350,000						\$350,000	
											\$350,000
Wastewater Collection Systems - Subtotal					\$ 2,563,774	\$ 193,674	\$ 188,100	\$ 335,000	\$ 555,500	\$ 591,500	\$ 350,000
Wastewater Collection - Repairs/Needs Amounts - 5 Year (as currently projected)								\$ 2,182,000			

Ohio Public Works Commission

Five Year Capital Improvement Plan/Maintenance of Effort

City of Oberlin
Subdivision

093-57834
Code

Lorain
County

August, 2011
Date

2010	2011	2012	2013	2014	2015	2016
1	2	3	4	5		

Project Name/Description	Funding Codes(s)	Status (A) Active (C) Complete	Total Cost	Two Year Effort		Five Year Plan				
				Yr - 2010	Yr - 2011	Yr - 2012 Planned	Yr - 2013	Yr - 2014	Yr - 2015	Yr - 2016

Stormwater Collection										
2010	East College St	C	\$ 10,000	\$10,000						
2010	East College St	C	\$ 10,000	\$10,000						
2010	Park St	C	\$ 113,100	\$113,100						
2011	N. Professor St	A	\$ 21,100	\$21,100						
2011	Union St	A	\$ 5,500	\$5,500						
2011	Woodland Ave.	A	\$ 5,200	\$5,200						
2012	Parkwood	A	\$ 18,300	\$18,300						
2012	Parkwood		\$ 34,900	\$34,900						
2012	Robin Park Lane		\$ 26,200	\$26,200						
2012	Lincoln Phase 2		\$ 12,600	\$12,600						
2013	S. Professor St		\$ 105,000	\$105,000						
2013	S. Professor St		\$ 8,600	\$8,600						
2013	S. Professor St		\$ 8,600	\$8,600						
2013	S. Professor St		\$ 8,600	\$8,600						
2013	S. Professor St		\$ 8,600	\$8,600						
2013	S. Professor St		\$ 8,600	\$8,600						
2013	S. Professor St		\$ 5,800	\$5,800						
2014	Edgemere Place		\$ 4,600	\$4,600						
2014	Groveland St		\$ 10,400	\$10,400						
2014	Groveland St		\$ 16,200	\$16,200						
2014	Groveland St		\$ 55,100	\$55,100						
2014	N. Pleasant St		\$ 87,400	\$87,400						
2014	West College St. (Split Segment)		\$ 46,000	\$46,000						
2014	Lincoln Phase 3		\$ 180,000	\$180,000						
2015	East Lorain St		\$ 20,100	\$20,100						
2015	East Lorain St		\$ 131,400	\$131,400						
2015	East Lorain St		\$ 22,700	\$22,700						
2015	East Lorain St		\$ 29,000	\$29,000						
2015	East Lorain St		\$ 25,300	\$25,300						
2015	East Lorain St		\$ 20,400	\$20,400						
2015	East Lorain St		\$ 5,500	\$5,500						
2015	East Lorain St		\$ 25,800	\$25,800						
2015	East Lorain St		\$ 51,500	\$51,500						
2015	East Lorain St		\$ 24,600	\$24,600						
2015	N. Main St		\$ 71,300	\$71,300						
2015	N. Main St		\$ 16,800	\$16,800						
2015	N. Main St		\$ 32,600	\$32,600						

Ohio Public Works Commission

093-57834

August 2014

Augu	Date
------	------

Year	Date				
	2010	2011	2012	2013	2014
2015			1	2	3
2016					4
2017					5

Project Name/Description		Funding Codes(s)	Status (A) Active (C) Complete	Total Cost	Two Year Effort		Five Year Plan						
					Yr - 2010	Yr - 2011	Yr - 2012 Planned	Yr - 2013	Yr - 2014	Yr - 2015	Yr - 2016		
2015	S. Main St.			\$ 58,700									
2016	East College St.			\$ 69,400								\$58,700	
2016	East College St.			\$ 63,000									\$69,400
2016	East College St.			\$ 21,300									\$63,000
2016	East College St.			\$ 55,400									\$21,300
2016	East College St.			\$ 46,800									\$55,400
2016	East College St.			\$ 78,700									\$46,800
2016	East College St.			\$ 10,800									\$78,700
Stormwater Collection Systems - Subtotal				\$ 1,735,000	\$ 133,100	\$ 50,100	\$ 213,600	\$ 57,400	\$ 399,700	\$ 535,700	\$	\$ 345,400	
Stormwater Collection - Repairs/Needs Amounts - 5 Year (as currently projected)							\$ 1,551,800						

Ditches

Ditches										
YEAR										
2016	Evans Ditch - Parsons Rd. to Plum Creek			\$	37,000					
2016	Evans Ditch - S. Main St. to Parsons Rd.			\$	58,000					\$37,000
2016	East Hamilton Outfall to Evans Ditch			\$	25,000					\$58,000
	Ditches - Subtotals			\$	120,000	\$	-	\$	-	\$25,000
	Ditches - Clean (Trim & Excavate), Seed, & Selectively add Geotextile & Riprap Protect					\$	-	\$	-	\$120,000

Solid Waste Disposal

[illegible]

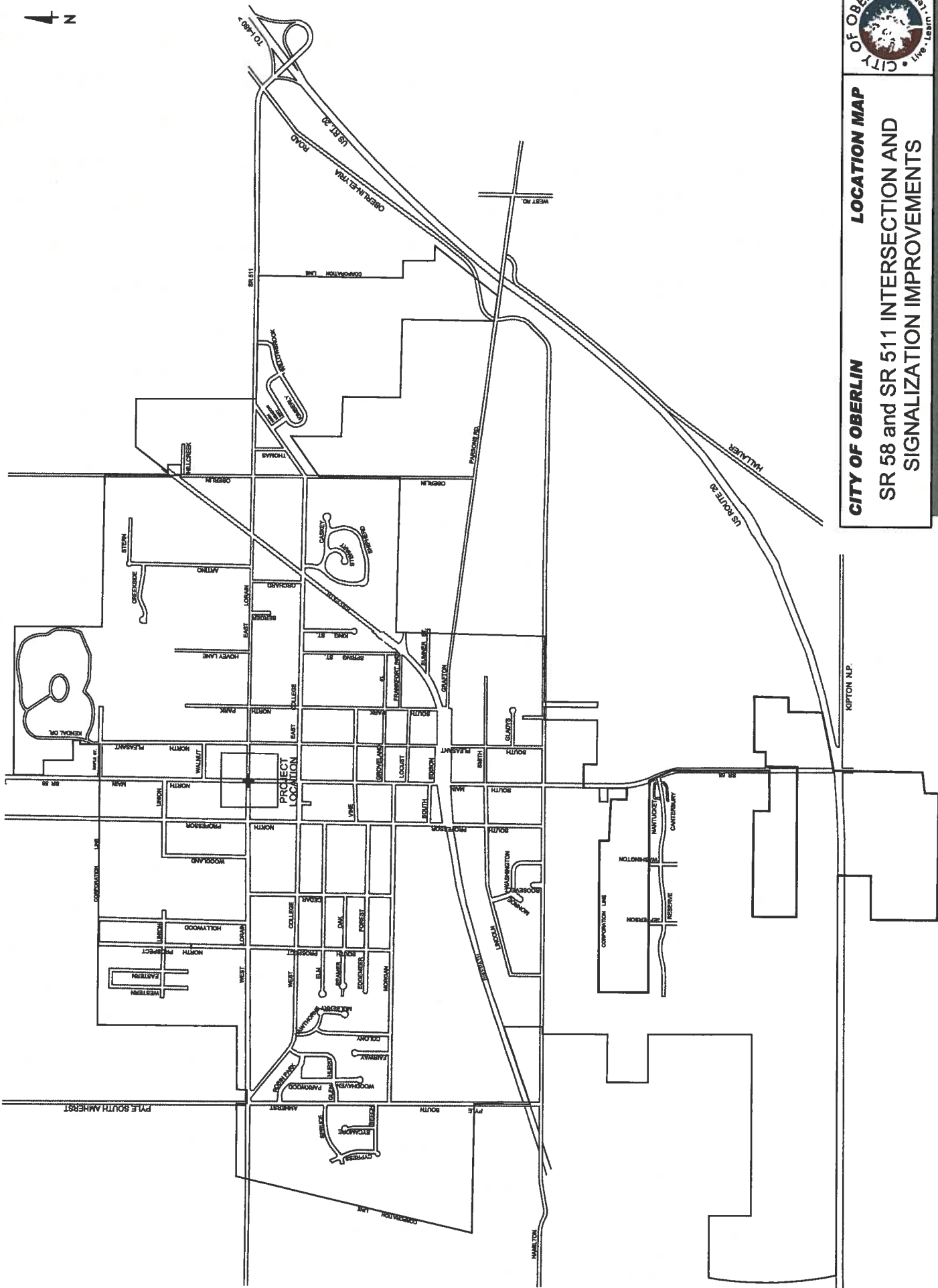

CITY OF OBERLIN **LOCATION MAP**
SR 58 and SR 511 INTERSECTION AND
SIGNALIZATION IMPROVEMENTS



TRAFFIC SIGNALS – EXISTING



TRAFFIC SIGNALS – PROPOSED

VEHICULAR TRAFFIC COUNT SUMMARY

Municipality: Oberlin At Intersection of: Main Street (SR 58) and Lorain Street (SR 511)
 Date: 3/1/2011 Day: Tue. Comments: _____
 Weather: Clear Recorder(s): CEL Date entry by: JJD Date entered: Mar. 2, 2011 Project: 11-023
 Main St. # Lorain St. 020111

TIME BEGINS	Main St. (SR 58) FROM NORTH						Main St. (SR 58) FROM SOUTH						TOTAL NORTH SOUTH	Lorain St. (SR 511) FROM EAST						Lorain St. (SR 511) FROM WEST						TOTAL EAST WEST	TOTAL ALL DIREC.	PEAK HOUR FACTOR			
	Right		Total		Trk	Bus	Right		Total		Trk	Bus		Right		Total		Trk	Bus	Right		Total		Trk	Bus			North	South	East	West
	Thru	Left	Thru	Left	Thru	Left	Thru	Left	Thru	Left	Thru	Left		Thru	Left	Thru	Left	Thru	Left	Thru	Left	Thru									
06:00																															
07:00	22	147	20	189	7	2	22	189	40	251	11	6	440	21	78	23	122	6	3	45	84	8	137	4	2	259	699	0.875	0.765	0.610	0.659
08:00	20	154	40	214	6	0	48	184	51	283	10	7	497	31	167	22	220	5	1	50	119	30	198	2	0	419	916	0.922	0.896	0.743	0.672
09:00	26	164	28	218	8	2	37	199	33	269	15	3	487	48	93	23	164	12	0	32	66	21	119	2	1	283	770	0.893	0.921	0.911	0.783
10:00																															
11:00	24	190	27	241	19	0	32	192	43	267	17	0	508	52	78	32	162	13	1	26	74	24	124	0	0	286	794	0.927	0.940	0.900	0.838
12:00	31	223	38	292	11	0	38	193	35	266	13	1	558	52	99	17	168	15	0	33	67	46	146	4	0	314	872	0.880	0.899	0.824	0.890
1:00	27	143	29	199	7	0	38	173	41	252	9	1	451	48	69	22	139	8	1	33	80	19	132	6	0	271	722	0.790	0.829	0.755	0.702
2:00																															
3:00	29	226	43	298	11	0	30	214	50	294	5	0	592	59	149	53	261	7	8	39	100	31	170	1	3	431	1023	0.768	0.855	0.932	0.904
4:00	34	269	37	340	7	0	36	259	44	339	9	5	679	60	124	51	235	9	0	67	87	44	198	7	0	433	1112	0.867	0.856	0.816	0.868
5:00	55	282	29	366	8	0	38	228	35	301	7	0	667	52	136	35	223	5	0	54	92	22	168	0	0	391	1058	0.887	0.919	0.961	0.792
6:00																															
7:00																															
8:00																															
9:00																															
TOTALS	268	1798	291	2357	84	4	319	1831	372	2522	96	23	4879	423	993	278	1694	80	14	379	769	245	1393	26	6	3087	7966				
ADT	424	2842	460	3726	3.7%		504	2894	588	3986	4.7%		7712	669	1570	439	2678	5.5%		599	1216	387	2202	2.3%		4880	12592				

HOURLY FACTOR: 1.68 MONTHLY FACTOR: 0.94 COMBINED FACTOR: 1.58

TMS ENGINEERS, INC.

4547 Hudson Drive
 Stow, Ohio 44224
 (330) 686-6402 FAX: (330) 686-6417

YEAR	VOLUME
1980	8080
1984	6770
1988	6050
1992	7610
2000	8000
2002	8040
2005	8680
2008	7550
2011	7712

Average Daily Traffic - SR 58

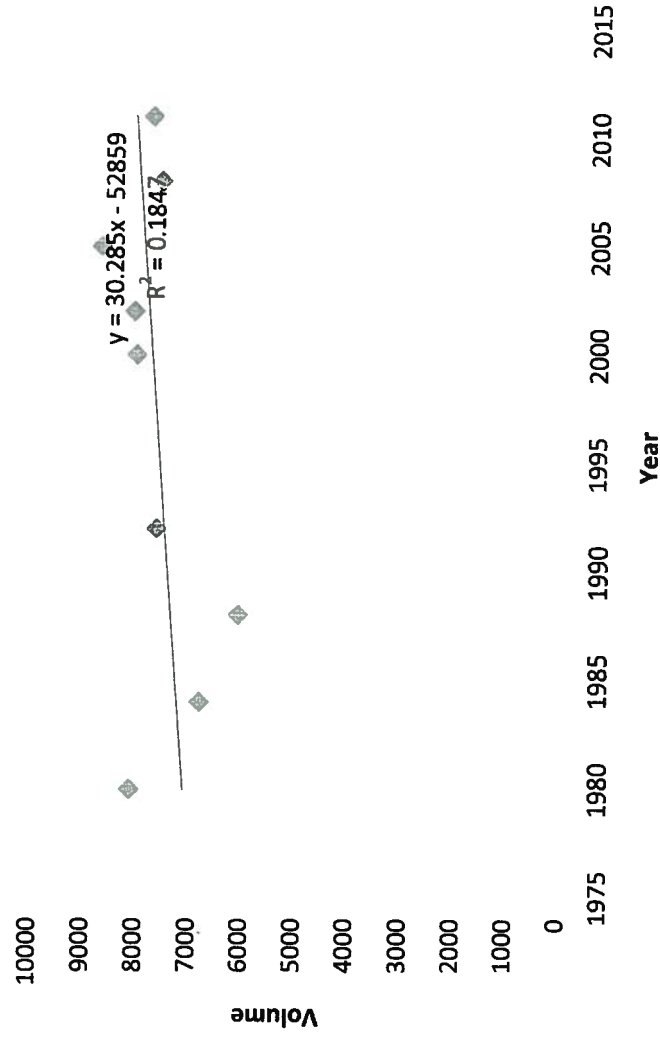

Average Growth Rate = 0.61%
Volume Data for Years 1980 to 2008 from ODOT Website

NORTH

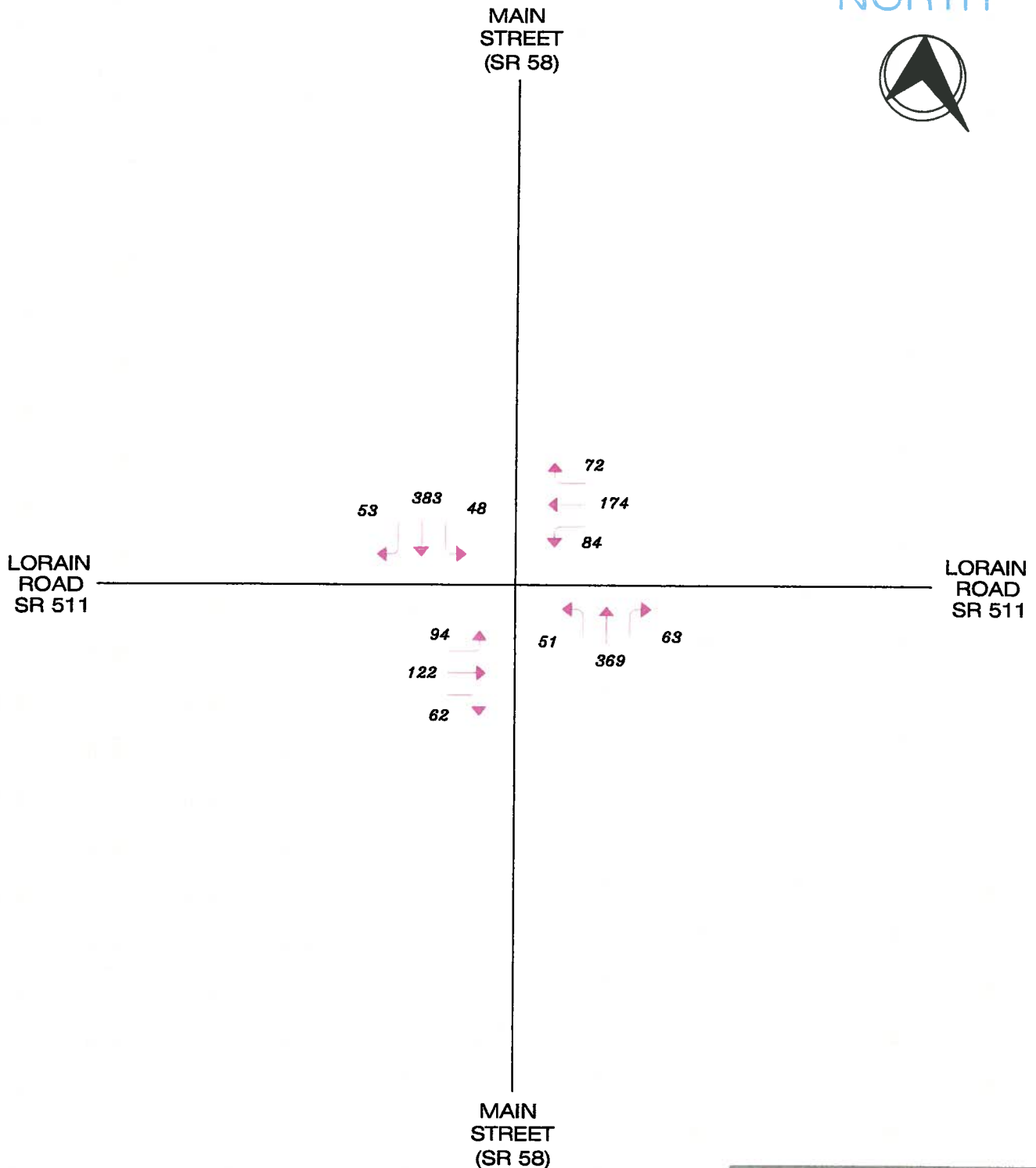

DESIGN HOUR VOLUME DETERMINED BY MULTIPLYING PK HR SAMPLE BY GROWTH FACTOR OF 0.61% PER YEAR AND DESIGN HOUR FACTOR OF 1.27 FOR SR 58 AND 1.25 FOR SR 511.

LEGEND

XX - DESIGN HOUR TRAFFIC



TMS Engineers, Inc.

Transportation Management Services
4547 Hudson Drive, Ste 1300, 44224
www.TMSEngineers.com

SR 58 & Lorain Road
Oberlin, Ohio
Intersection Analysis

2031 TWENTY YEAR
TRAFFIC VOLUMES

FIG. NO.:

-

PAGE NO.:

-

FULL REPORT

General Information

Analyst **MWS**
 Agency or Co. **TMS Engineerins, Inc.**
 Date Performed **3/29/11**
 Time Period **Design Hour**

Site Information

Intersection **Main St & Lorain St**
 Area Type **All other areas**
 Jurisdiction **Oberlin, Ohio**
 Analysis Year **2031**

Intersection Geometry

Grade = 0

0 1 0

Grade = 0

Grade = 0

Grade = 0

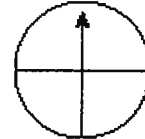

Show North Arrow

= T

= R

= L

= TR

= LT

= LR

= LTR

Volume and Timing Input

			EB			WB			NB			SB			
			LT	TH	RT	LT	TH	RT	LT	TH	RT	LT	TH	RT	
Volume (vph)			94	122	62	84	174	72	51	369	63	48	383	53	
% Heavy Veh			2	2	2	6	6	6	5	5	5	4	4	4	
PHF			0.90	0.90	0.90	0.90	0.90	0.90	0.90	0.90	0.90	0.90	0.90	0.90	
Actuated (P/A)			A	A	A	A	A	A	P	P	P	P	P	P	
Startup Lost Time				2.0			2.0			2.0			2.0		
Extension of Effective Green				2.0			2.0			2.0			2.0		
Arrival Type				3			3			3			3		
Unit Extension				3.0			3.0			3.0			3.0		
Ped/Bike/RTOR Volume <i>Right turn on red</i>			0	0	0	0	0	0	0	0	0	0	0	0	
Lane Width				12.0			12.0			12.0			12.0		
Parking (Y or N)			N		N	N		N	N		N	N		N	
Parking/Hour															
Bus Stops/Hour				0			0			0			0		
Pedestrian Timing			3.2			3.2			3.2			3.2			
	EW Perm	02	03		04		NS Perm		06		07		08		
Timing	G = 31.6	G =	G =		G =		G = 37.9		G =		G =		G =		
	Y = 5	Y =	Y =		Y =		Y = 5.5		Y =		Y =		Y =		
Duration of Analysis (hrs) = 0.25										Cycle Length C = 80.0					

VOLUME ADJUSTMENT AND SATURATION FLOW RATE WORKSHEET

General Information

Project Description *Optimized Signal Timings*

Volume Adjustment

	EB			WB			NB			SB		
	LT	TH	RT	LT	TH	RT	LT	TH	RT	LT	TH	RT
Volume	94	122	62	84	174	72	51	369	63	48	383	53
PHF	0.90	0.90	0.90	0.90	0.90	0.90	0.90	0.90	0.90	0.90	0.90	0.90
Adjusted Flow Rate	104	136	69	93	193	80	57	410	70	53	426	59
Lane Group		LTR			LTR			LTR			LTR	
Adjusted Flow Rate		309			366			537			538	
Proportion of LT or RT	0.337	--	0.223	0.254	--	0.219	0.106	--	0.130	0.099	--	0.110

Saturation Flow Rate

Base Satflow		1900			1900			1900			1900	
Number of Lanes	0	1	0	0	1	0	0	1	0	0	1	0
f_W		1.000			1.000			1.000			1.000	
f_{HV}		0.980			0.943			0.952			0.962	
f_g		1.000			1.000			1.000			1.000	
f_p		1.000			1.000			1.000			1.000	
f_{bb}		1.000			1.000			1.000			1.000	
f_a		1.000			1.000			1.000			1.000	
f_{LU}		1.000			1.000			1.000			1.000	
f_{LT}		0.747	--		0.835	--		0.907	--		0.915	--
Secondary f_{LT}			--			--			--			--
f_{RT}	--	0.970		--	0.970		--	0.982		--	0.985	
f_{Lpb}		1.000	--		1.000	--		1.000	--		1.000	--
f_{Rpb}	--	1.000		--	1.000		--	1.000		--	1.000	
Adjusted Satflow		1349			1453			1613			1647	
Secondary Adjusted Satflow			--			--			--			--

CAPACITY AND LOS WORKSHEET

General Information

Project Description *Optimized Signal Timings*

Capacity Analysis

	EB		WB		NB		SB	
Lane Group		LTR		LTR		LTR		LTR
Adjusted Flow Rate		309		366		537		538
Satflow Rate		1349		1453		1613		1647
Lost Time		2.0		2.0		2.0		2.0
Green Ratio		0.40		0.40		0.47		0.47
Lane Group Capacity		533		574		764		780
v/c Ratio		0.58		0.64		0.70		0.69
Flow Ratio		0.23		0.25		0.33		0.33
Critical Lane Group		N		Y		Y		N
Sum Flow Ratios	0.58							
Lost Time/Cycle	10.50							
Critical v/c Ratio	0.67							

Lane Group Capacity, Control Delay, and LOS Determination

	EB			WB			NB			SB		
Lane Group		LTR			LTR			LTR			LTR	
Adjusted Flow Rate		309			366			537			538	
Lane Group Capacity		533			574			764			780	
v/c Ratio		0.58			0.64			0.70			0.69	
Green Ratio		0.40			0.40			0.47			0.47	
Uniform Delay d_1		19.0			19.6			16.6			16.5	
Delay Factor k		0.17			0.22			0.50			0.50	
Incremental Delay d_2		1.6			2.4			5.4			5.0	
PF Factor		1.000			1.000			1.000			1.000	
Control Delay		20.6			21.9			22.0			21.4	
Lane Group LOS		C			C			C			C	
Approach Delay	20.6			21.9			22.0			21.4		
Approach LOS	C			C			C			C		
Intersection Delay	21.5			Intersection LOS						C		



OHIO DEPARTMENT OF TRANSPORTATION

CENTRAL OFFICE • 1980 WEST BROAD STREET • COLUMBUS, OH 43223
JOHN R. KASICH, GOVERNOR • JERRY WRAY, DIRECTOR

March 31, 2011

Jeff Baumann
Public Works Director
80 Spring Street
Oberlin, Ohio 44074

Dear Mr. Baumann,

The Ohio Department of Transportation (ODOT) is pleased to inform you that the City of Oberlin Pedestrian countdown devices, school zone flashers, sidewalk improvements, curb ramps, crosswalk and signal improvement project has been approved for Safe Routes to School (SRTS) funding. The amount of funding awarded is \$445,581.

SRTS Project Award Details:

Environmental: _____ \$ 13,654
Design: _____ \$ 37,303
Construction: _____ \$ 376,127
Construction Engineering: _____ \$ 18,497
Sale Date: April 2012

This selection is pending approval of a final project scope with ODOT representatives. The project scope is necessary to establish final cost estimates and program milestone dates to guide project development. Upon completion of the project scope, ODOT will verify the amount of funding and when funds will be available.

Please contact Julie Cichello, in the ODOT District 3 office at 419-207-7168, or by email at julie.cichello@dot.state.oh.us to schedule a scope meeting and start the process of developing your project. It is very important to establish solid commitment dates for your project because failure to meet the commitment dates could result in funding being withdrawn.

If you have any questions, please feel free to contact Julie Walcoff at 614-466-3049 or by email at julie.walcoff@dot.state.oh.us. We look forward to working with you as you continue to develop your SRTS program.

Respectfully,

A handwritten signature in blue ink, reading "Julie Walcoff", is positioned below the "Respectfully," text.

Julie Walcoff, SRTS Program Manager
Ohio Department of Transportation

cc: Julie Cichello, D03

Project Priority No. 1

SR511/SR58 Traffic Signal Improvements



Project Description:

Install pedestrian signals with countdown indicators on all legs of SR 511/SR 58 Intersection.