

## **City of Oberlin, Ohio**

### **ORDINANCE No. 16 -30 AC CMS**

AN ORDINANCE AUTHORIZING THE INTERIM CITY MANAGER TO ENTER INTO A COOPERATION AGREEMENT AND TO FILE A JOINT APPLICATION WITH THE LORAIN COUNTY COMMISSIONERS TO THE DISTRICT 9 PUBLIC WORKS INTEGRATING COMMITTEE FOR OHIO PUBLIC WORKS COMMISSION ISSUE I FUNDING FOR THE OBERLIN ROAD, CR-39 RESURFACING PROJECT AND DECLARING AN EMERGENCY

BE IT ORDAINED by the Council of the City of Oberlin, County of Lorain, State of Ohio, five-sevenths (5/7ths) of all members elected thereto concurring:

SECTION 1. That the Interim City Manager is hereby authorized and directed to file a joint application with the Lorain County Commissioners to the District 9 Public Works Integrating Committee for Ohio Public Works Commission (OPWC) Issue I Round 31 funding for the following project:

#### **Oberlin Road, CR-39 Resurfacing (East College Street to Russia Road)**

SECTION 2. That Lorain County shall be designated "Lead Agency" for the purposes of this OPWC Issue I Round 31 project.

SECTION 3. That the Interim City Manager is hereby authorized and directed to enter into a Co-operation Agreement with the Lorain County Commissioners for the purpose of administering this Issue I Round 31 project in the form attached hereto as Exhibit A.

SECTION 4. That if said Issue I Round 31 project is funded, the City Manager or the Interim City Manager as the case may be is hereby authorized to commit local matching funds as designated in the grant application.

SECTION 5. It is hereby found and determined that all formal actions of this Council concerning or relating to the adoption of this ordinance were adopted in an open meeting of this Council, and that all deliberations of this Council and of any of its committees that resulted in such formal action, were in meetings open to the public in compliance with all legal requirements, including Section 121.22 of the Ohio Revised Code.

SECTION 6. That this ordinance is hereby declared to be an emergency measure necessary for the immediate preservation of the public peace, health or safety of the citizens of the City of Oberlin, Ohio, or to provide for the usual daily operation of a municipal department, to wit: "in order to allow for the filing of an Issue I grant application in a timely manner", and shall take effect immediately upon passage.

PASSED: 1<sup>st</sup> Reading: September 6, 2016 (E)

2<sup>nd</sup> Reading: \_\_\_\_\_

3<sup>rd</sup> Reading: \_\_\_\_\_

ATTEST:

  
\_\_\_\_\_  
BELINDA B. ANDERSON, MMC  
CLERK OF COUNCIL

  
\_\_\_\_\_  
RONNIE J. RIMBERT  
PRESIDENT OF COUNCIL

POSTED: 09/07/2016

EFFECTIVE DATE: 09/06/2016



State of Ohio  
**Public Works Commission**  
*Application for Financial Assistance*

**IMPORTANT:** Please consult "Instructions for Financial Assistance for Capital Infrastructure Projects" for guidance in completion of this form.

**Applicant**

Applicant: Lorain County Engineers Office Subdivision Code: 093-00093  
 District Number: 9 County: Lorain Date: 09/02/2016  
 Contact: Robert Klaiber Phone: (440) 329-5586  
(The individual who will be available during business hours and who can best answer or coordinate the response to questions)  
 Email: rklaiber@loraincounty.us FAX: (440) 329-5587

**Project**

Project Name: Oberlin Road Resurfacing Zip Code: 44035

Subdivision Type <small>(Select one)</small>	Project Type <small>(Select single largest component by \$)</small>	Funding Request Summary <small>(Automatically populates from page 2)</small>
<input checked="" type="checkbox"/> 1. County	<input checked="" type="checkbox"/> 1. Road	Total Project Cost: <u>1,144,299.00</u>
<input type="checkbox"/> 2. City	<input type="checkbox"/> 2. Bridge/Culvert	1. Grant: <u>843,426.00</u>
<input type="checkbox"/> 3. Township	<input type="checkbox"/> 3. Water Supply	2. Loan: <u>175,000.00</u>
<input type="checkbox"/> 4. Village	<input type="checkbox"/> 4. Wastewater	3. Loan Assistance/ Credit Enhancement: <u>0.00</u>
<input type="checkbox"/> 5. Water (6119 Water District)	<input type="checkbox"/> 5. Solid Waste	
	<input type="checkbox"/> 6. Stormwater	Funding Requested: <u>1,018,426.00</u>

**District Recommendation** (To be completed by the District Committee)

Funding Type Requested <small>(Select one)</small>	SCIP Loan - Rate: _____ % Term: _____ Yrs	Amount: _____ .00
<input type="checkbox"/> State Capital Improvement Program	RLP Loan - Rate: _____ % Term: _____ Yrs	Amount: _____ .00
<input type="checkbox"/> Local Transportation Improvement Program	Grant:	Amount: _____ .00
<input type="checkbox"/> Revolving Loan Program	LTIP:	Amount: _____ .00
<input type="checkbox"/> Small Government Program	Loan Assistance / Credit Enhancement:	Amount: _____ .00
District SG Priority: _____		

**For OPWC Use Only**

STATUS: _____	Grant Amount: _____ .00	Loan Type: <input type="checkbox"/> SCIP <input type="checkbox"/> RLP
Project Number: _____	Loan Amount: _____ .00	Date Construction End: _____
	Total Funding: _____ .00	Date Maturity: _____
Release Date: _____	Local Participation: _____ %	Rate: _____ %
OPWC Approval: _____	OPWC Participation: _____ %	Term: _____ Yrs

## 1.0 Project Financial Information (All Costs Rounded to Nearest Dollar)

### 1.1 Project Estimated Costs

#### Engineering Services

Preliminary Design: \_\_\_\_\_ .00

Final Design: \_\_\_\_\_ 10,000 .00

Construction Administration: \_\_\_\_\_ 10,000 .00

Total Engineering Services: a.) \_\_\_\_\_ 20,000 .00 \_\_\_\_\_ 2 %

Right of Way: b.) \_\_\_\_\_ .00

Construction: c.) \_\_\_\_\_ 1,070,732 .00

Materials Purchased Directly: d.) \_\_\_\_\_ .00

Permits, Advertising, Legal: e.) \_\_\_\_\_ .00

Construction Contingencies: f.) \_\_\_\_\_ 53,567 .00 \_\_\_\_\_ 5 %

Total Estimated Costs: g.) \_\_\_\_\_ 1,144,299 .00

### 1.2 Project Financial Resources

#### Local Resources

Local In-Kind or Force Account: a.) \_\_\_\_\_ 20,000 .00

Local Revenues: b.) \_\_\_\_\_ 105,873 .00

Other Public Revenues: c.) \_\_\_\_\_ .00

ODOT / FHWA PID: \_\_\_\_\_ d.) \_\_\_\_\_ .00

USDA Rural Development: e.) \_\_\_\_\_ .00

OEPA / OWDA: f.) \_\_\_\_\_ .00

CDBG: g.) \_\_\_\_\_ .00

☐ County Entitlement or Community Dev. "Formula"

☐ Department of Development

Other: \_\_\_\_\_ h.) \_\_\_\_\_ .00

Subtotal Local Resources: i.) \_\_\_\_\_ 125,873 .00 \_\_\_\_\_ 11 %

#### OPWC Funds (Check all requested and enter Amount)

Grant: \_\_\_\_\_ 83 % of OPWC Funds j.) \_\_\_\_\_ 843,426 .00

Loan: \_\_\_\_\_ 17 % of OPWC Funds k.) \_\_\_\_\_ 175,000 .00

Loan Assistance / Credit Enhancement: l.) \_\_\_\_\_ 0 .00

Subtotal OPWC Funds: m.) \_\_\_\_\_ 1,018,426 .00 \_\_\_\_\_ 89 %

Total Financial Resources: n.) \_\_\_\_\_ 1,144,299 .00 \_\_\_\_\_ 100 %

### 1.3 Availability of Local Funds

Attach a statement signed by the Chief Financial Officer listed in section 5.2 certifying all local resources required for the project will be available on or before the earliest date listed in the Project Schedule section. The OPWC Agreement will not be released until the local resources are certified. Failure to meet local share may result in termination of the project. Applicant needs to provide written confirmation for funds coming from other funding sources.

### 2.0 Repair / Replacement or New / Expansion

2.1 Total Portion of Project Repair / Replacement:	<u>1,144,299</u> .00	<u>100</u> %
2.2 Total Portion of Project New / Expansion:	<u>0</u> .00	<u>0</u> %
2.3 Total Project:	<u>1,144,299</u> .00	<u>100</u> %

A Farmland  
Preservation letter is  
required for any  
impact to farmland

### 3.0 Project Schedule

3.1 Engineering / Design / Right of Way	Begin Date: <u>01/02/2017</u>	End Date: <u>03/03/2017</u>
3.2 Bid Advertisement and Award	Begin Date: <u>05/05/2017</u>	End Date: <u>06/07/2017</u>
3.3 Construction	Begin Date: <u>07/10/2017</u>	End Date: <u>10/27/2017</u>

Construction cannot begin prior to release of executed Project Agreement and Issuance of Notice to Proceed.

Failure to meet project schedule may result in termination of agreement for approved projects.  
Modification of dates must be requested in writing by project official of record and approved by the Commission once the Project Agreement has been executed.

### 4.0 Project Information

If the project is multi-jurisdictional, information must be consolidated in this section.

#### 4.1 Useful Life / Cost Estimate / Age of Infrastructure

Project Useful Life: 12 Years      Age: 2000 (Year built or year of last major improvement)

*Attach Registered Professional Engineer's statement, with seal or stamp and signature confirming the project's useful life indicated above and detailed cost estimate.*

#### 4.2 User Information

Road or Bridge:      Current ADT 3,100      Year 2012      Projected ADT 3,978      Year 2032

Water / Wastewater: Based on monthly usage of 4,500 gallons per household; attach current ordinances.

Residential Water Rate      Current \$ \_\_\_\_\_      Proposed \$ \_\_\_\_\_

Number of households served: \_\_\_\_\_

Residential Wastewater Rate      Current \$ \_\_\_\_\_      Proposed \$ \_\_\_\_\_

Number of households served: \_\_\_\_\_

Stormwater: Number of households served: \_\_\_\_\_

### 4.3 Project Description

- A: SPECIFIC LOCATION** (Supply a written location description that includes the project termini; a map does not replace this requirement.) 500 character limit.

The project begins at the intersection of Oberlin Road (CR39) and College Street in the City of Oberlin and continues northerly approximately 19,113 feet to the intersection of Russia and Oberlin Roads in New Russia Township.

- B: PROJECT COMPONENTS** (Describe the specific work to be completed; the engineer's estimate does not replace this requirement) 1,000 character limit.

The project includes the repair and resurfacing of approximately 119,113 linear feet of Oberlin Road (CR 39) in New Russia Township and the City of Oberlin. Specific work types include milling 3" of the existing asphalt surface, repairing failed base pavement, resurfacing with 1-3/4" asphalt intermediate course and 1-1/4" asphalt surface course, aggregate berm reconstruction and pavement markings.

- C: PHYSICAL DIMENSIONS** (Describe the physical dimensions of the existing facility and the proposed facility. Include length, width, quantity and sizes, mgd capacity, etc. in detail.) 500 character limit.

Oberlin Road (CR 39) is approximately 28 feet wide and includes two-11 foot driving lanes with a three foot wide paved shoulder on each side. An 11 foot left turn lane is provided at SR 511. The final product will maintain the two-11 foot driving lanes and three foot wide paved shoulder as well as the left hand turn lanes at SR 511.

## 5.0 Project Officials

Changes in Project Officials must be submitted in writing from an officer of record.

### 5.1 Chief Executive Officer

(Person authorized in legislation to sign project agreements)

Name: Ken Carney

Title: Lorain County Engineer

Address: 247 Hadaway Street

City: Elyria State: OH Zip: 44035

Phone: (440) 329-5586

FAX: (440) 329-5587

E-Mail: kcarney@loraincountyengineer.com

### 5.2 Chief Financial Officer

(Can not also serve as CEO)

Name: Shelley Marrero

Title: Business Administrator

Address: 247 Hadaway Street

City: Elyria State: OH Zip: 44035

Phone: (440) 329-5586

FAX: (440) 329-5587

E-Mail: smarrero@loraincounty.us

### 5.3 Project Manager

Name: Robert Klaiber

Title: Assistant County Engineer

Address: 247 Hadaway Street

City: Elyria State: OH Zip: 44035

Phone: (440) 329-5586

FAX: (440) 329-5587

E-Mail: rklaiber@loraincounty.us

## 6.0 Attachments / Completeness review

Confirm in the boxes below that each item listed is attached (Check each box)

- ☒ A certified copy of the legislation by the governing body of the applicant authorizing a designated official to sign and submit this application and execute contracts. This individual should sign under 7.0, Applicant Certification, below.
- ☒ A certification signed by the applicant's chief financial officer stating the amount of all local share funds required for the project will be available on or before the dates listed in the Project Schedule section. If the application involves a request for loan (RLP or SCIP), a certification signed by the CFO which identifies a specific revenue source for repaying the loan also must be attached. Both certifications can be accomplished in the same letter.
- ☒ A registered professional engineer's detailed cost estimate and useful life statement, as required in 164-1-13, 164-1-14, and 164-1-16 of the Ohio Administrative Code. Estimates shall contain an engineer's seal or stamp and signature.
- ☒ A cooperative agreement (if the project involves more than one subdivision or district) which identifies the fiscal and administrative responsibilities of each participant.
- ☐ Farmland Preservation Review - The Governor's Executive Order 98-11V, "Ohio Farmland Protection Policy" requires the Commission to establish guidelines on how it will take protection of productive agricultural and grazing land into account in its funding decision making process. Please include a Farm Land Preservation statement for projects that have an impact on farmland.
- ☐ Capital Improvements Report. CIR Required by O.R.C. Chapter 164.06 on standard form.
- ☒ Supporting Documentation: Materials such as additional project description, photographs, economic impact (temporary and/or full time jobs likely to be created as a result of the project), accident reports, impact on school zones, and other information to assist your district committee in ranking your project. Be sure to include supplements which may be required by your local District Public Works Integrating Committee.

## 7.0 Applicant Certification

The undersigned certifies: (1) he/she is legally authorized to request and accept financial assistance from the Ohio Public Works Commission as identified in the attached legislation; (2) to the best of his/her knowledge and belief, all representations that are part of this application are true and correct; (3) all official documents and commitments of the applicant that are part of this application have been duly authorized by the governing body of the applicant; and, (4) should the requested financial assistance be provided, that in the execution of this project, the applicant will comply with all assurances required by Ohio Law, including those involving Buy Ohio and prevailing wages.

**Applicant certifies that physical construction on the project as defined in the application has NOT begun, and will not begin until a Project Agreement for this project has been executed with the Ohio Public Works Commission. Action to the contrary will result in termination of the agreement and withdrawal of Ohio Public Works Commission funding from the project.**

Ken Carney, Lorain County Engineer

Certifying Representative (Printed form, Type or Print Name and Title)

*Ken Carney P.E.* 8/30/16  
Original Signature / Date Signed





# LORAIN COUNTY ENGINEER

**KEN CARNEY, P.E., P.S.**

## Preliminary Estimate of Cost (Entire Project)

**Oberlin Road Road, CR-39 Resurfacing (East College Street to Russia Road)**

**New Russia Township & City of Oberlin**

August 8, 2016

**Oberlin City Section 1:** East College St to S.R. 511 (22.8'-32.9' Variable Width) Area = 2,484 Sq. Yd.

**Oberlin City Section 2:** S.R. 511 to Northerly Corp. Line (36.2' Avg Width) Area = 4,887 Sq. Yd.

**County Section:** Northerly Corp. Line to Pvmnt seam at Russia Road (24' Avg. Width) Area = 45,878 Sq. Yd.

<u>Item</u>	<u>Description</u>	<u>Quantity</u>	<u>Unit</u>	<u>Cost</u>	<u>Total</u>
253	Pavement Repair, Bituminous 6" depth, as directed by the Engineer	1068	Sq. Yd.	\$45.00	\$48,060.00
254	Pavement Planing, Asphalt Concrete (3" Depth Max.) Incl. Butt Joints	53249	Sq. Yd.	\$2.50	\$133,122.50
407	Tack Coat, 0.10 gal per Sq. Yd.	5325	Gal.	\$2.50	\$13,312.50
407	Tack Coat, 0.05 gal per Sq. Yd. (Intermediate)	2663	Gal.	\$2.50	\$6,657.50
411	Stabilized Crushed Aggregate (1' wide Berm), as directed by the Engineer	180	Cu. Yd.	\$60.00	\$10,800.00
441	1 1/4" Asphalt Concrete Surface Course, Type 1 PG64-22	1851	Cu. Yd.	\$185.00	\$342,435.00
441	1 3/4" Asphalt Concrete Intermediate Course, Type 2 PG64-22	2589	Cu. Yd.	\$160.00	\$414,240.00
441	Asphalt Concrete Surface Course, Type 1 PG64-22 (Drive Aprons), as per plan	100	Cu. Yd.	\$250.00	\$25,000.00
611	Catch Basin Adjusted to Grade	1	Ea.	\$400.00	\$400.00
611	Manhole Adjusted to Grade	3	Ea.	\$400.00	\$1,200.00
611	Curb Inlet, Reconstruct as per plan	4	Ea.	\$600.00	\$2,400.00
614	Maintaining Traffic	1	Lump	\$20,000.00	\$20,000.00
614	Temporary Centerline, Class II (642 Paint)	6.42	Mi.	\$1,000.00	\$6,420.00
614	Work Zone marking Sign	16	Ea.	\$50.00	\$800.00
623	Construction Layout Stakes & Surveying	1	Lump	\$3,000.00	\$3,000.00
623	Monument Assembly	4	Each	\$400.00	\$1,600.00
642	4" Edgeline, Type 1, White	6.42	Mi.	\$1,000.00	\$6,420.00
642	Centerline, Type 1	3.62	Mi.	\$2,000.00	\$7,240.00
642	Channelizing Line	185	Ft.	\$5.00	\$925.00
642	Transverse / Diagonal Line	250	Ft.	\$5.00	\$1,250.00
642	Island Marking	100	Sq. Ft.	\$6.00	\$600.00

644	Stop Line, Type 1	140	Ft.	\$15.00	\$2,100.00
644	Lane Arrow	15	Each	\$150.00	\$2,250.00
644	Word on Pavement 48" 'ONLY'	2	Each	\$250.00	\$500.00
624	Mobilization		Lump		\$10,000.00
103.05	Premium Contract Bond		Lump		\$10,000.00
				Subtotal	\$1,070,732.50
Spec.	Contingencies				\$53,567.50
				<b>Total</b>	<b>\$1,124,300.00</b>

I hereby certify the above estimate to be accurate and the useful life, with proper maintenance, to be 12 years.



*Robert C. Klaiber* 8/26/2016  
 Robert C. Klaiber  
 Assistant County Engineer

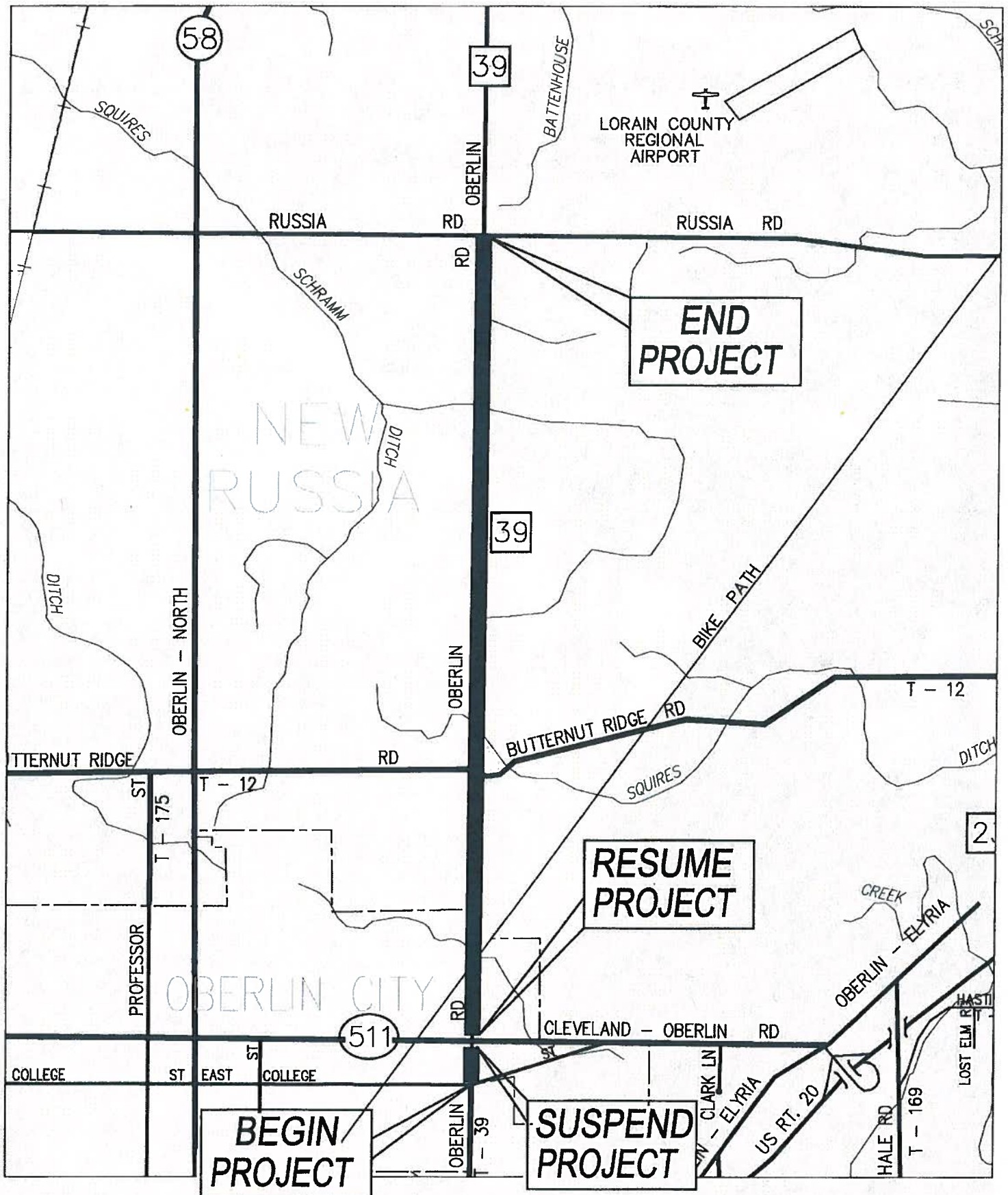

**OBERLIN ROAD C.R.-39  
ROADWAY RESURFACING PROJECT  
NEW RUSSIA TWP. AND CITY OF OBERLIN**





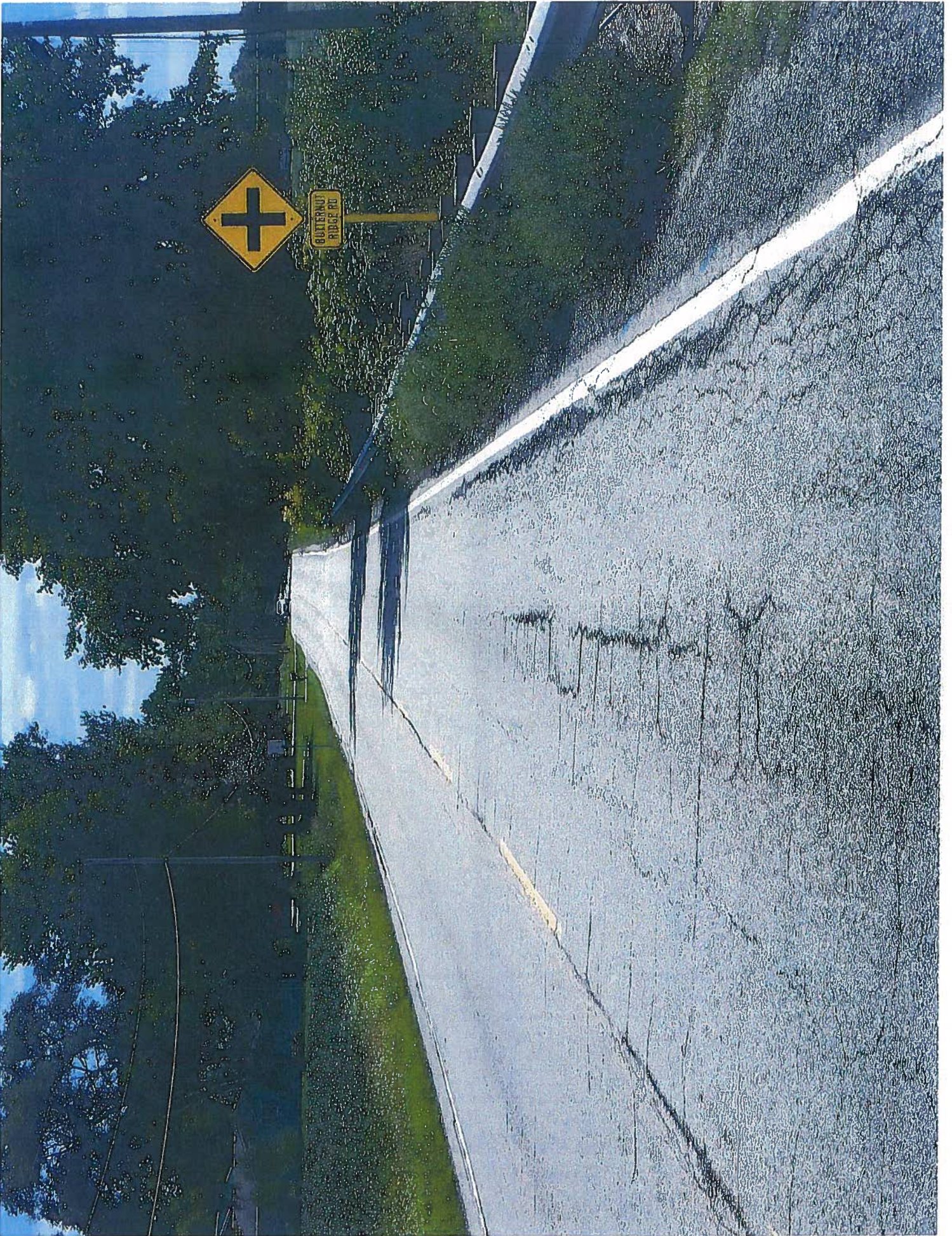



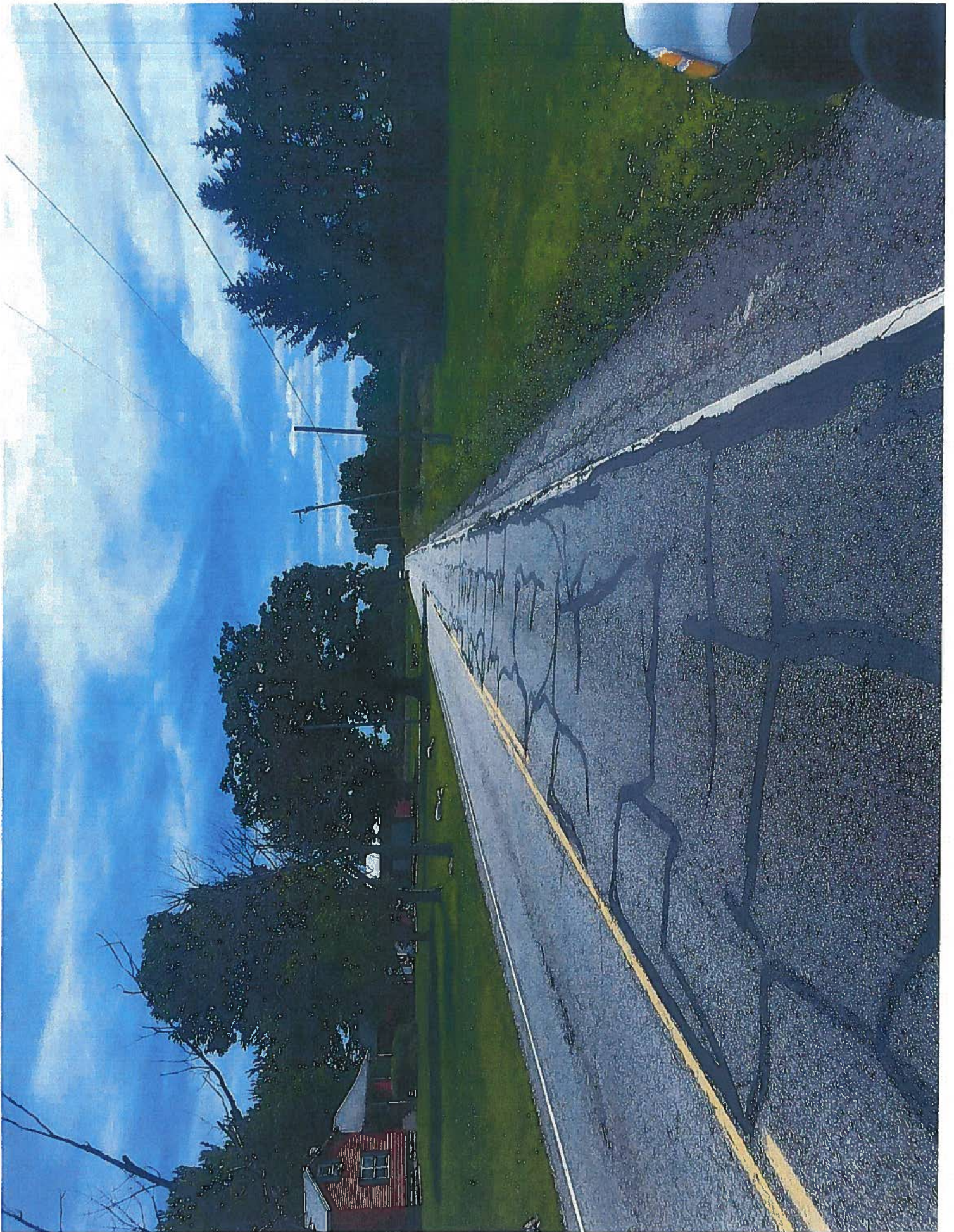







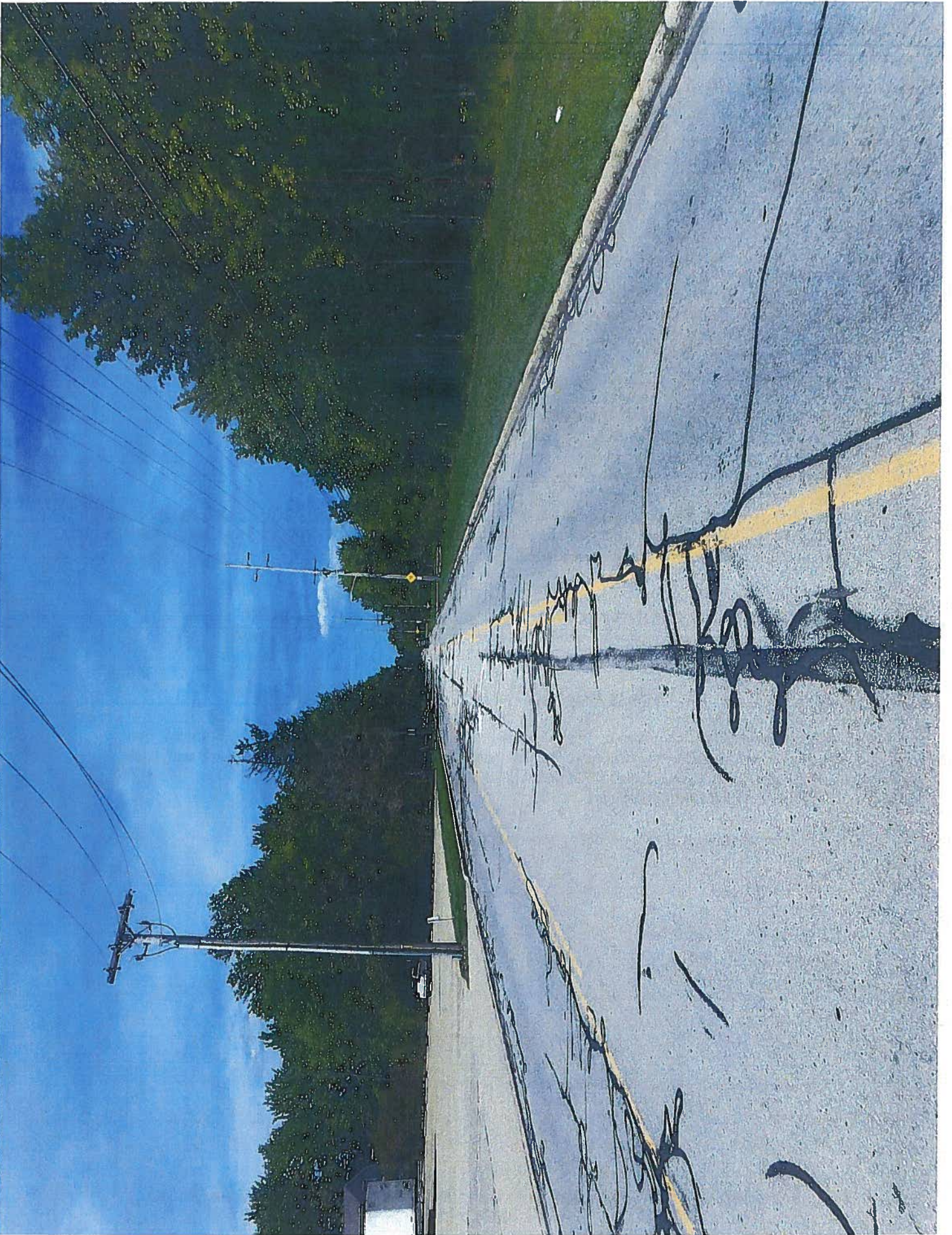





# LORAIN COUNTY ENGINEER

**KEN CARNEY, P.E., P.S.**

September 2, 2016

Ms. Abbey DeHart, District Representative  
Ohio Public Works Commission  
65 E. State Street, Suite 312  
Columbus, Ohio 43215

Re: Application for Financial Assistance  
Oberlin Road Resurfacing

Dear Ms. DeHart:

The Lorain County Engineer in cooperation with the City of Oberlin is applying for funding through the Ohio Public Works Commission, District 9, for the Oberlin Road Resurfacing Project. The preliminary estimate of cost and funding request is as follows:

Oberlin Road Resurfacing	
Preliminary Construction Cost Estimate	\$1,144,299.00
Ohio Public Works Commission Funding Request	\$1,018,426.00
Lorain County Engineer's Office and City of Oberlin	\$ 125,873.00

The County Commissioners, by Resolution No. 16-552, approved this application.

The purpose of this letter is to certify the availability of funds for the local share of the project. Funds will be made available from the motor vehicle gas fund for force account costs associated with labor, equipment and material. Local Revenues will be made available from Account 2580-0000-300-300-04-6100-6105 (Engineering Projects).

If any further information is needed, please contact this office.

Sincerely,

Handwritten signature of Shelley Marrero in blue ink.

Shelley Marrero  
Business Administrator

RCK/SM/rfb  
cc: File

Z:\Word Data\2016\Shelley\9-02-16 OPWC-Abbey DeHart re - Local Share Certification Oberlin Road Resurfacing.doc





# LORAIN COUNTY

## Board of Commissioners

Matt Lundy      Ted Kalo      Lori Kokoski

cc  
KC  
RK  
MB  
SM  
file

County Administrator  
James R. Cordes  
440-329-5760

Clerk of Board of Commissioners  
Theresa Upton  
440-329-5103

Animal Control Officer  
Timothy Pihlblad  
440-326-5997

Budget Director  
Lisa Hobart  
440-329-5201

Charles Berry Bridge  
Superintendent  
Al Zocchi  
440-244-2137

Children & Family Council  
Director  
Melissa Stefano  
440-284-4467

Community Development  
Director  
Don Romancak  
440-328-2323

E-9-1-1 Director  
Tracy Shagle  
440-329-5444

Emergency Management &  
Homeland Security Director  
Thomas Kelley  
440-329-5117

Facilities Management Director  
Karen Davis  
440-329-5102

Human Resources Department  
440-329-5150

IT Director  
Ernie Smith  
440-329-5786

Lorain County Crime/Drug Lab  
Director  
Emmanuel de Leon  
440-329-5636

Lorain County Transit  
440-329-5525

Office of Sustainability  
Coordinator  
Michael Challenger  
440-328-2361

Purchasing  
440-329-5240

Records Center Supervisor  
Denise Lindak  
440-326-4866

Solid Waste Director  
Keith Bailey  
440-329-5442

Workforce Development Director  
Mike Longo  
440-284-1834

August 31, 2016

Ken Carney  
LC Engineer  
247 Hadaway Street  
Elyria, Ohio 44035

Dear Mr. Carney:

Enclosed is Resolution No. 16-552, adopted by the Lorain County Board of Commissioners on August 24, 2016 authorizing various applications to OPWC for the Lorain County Engineer's Department for various projects in Lorain County, Ohio.

This is being forwarded for your information and files.

Sincerely,

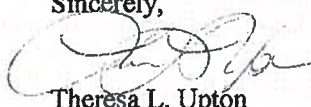
  
Theresa L. Upton  
Clerk

tlu  
Enclosure

cc.      File

RECEIVED  
2016 SEP - 1 PM 2:10  
KEN CARNEY  
LORAIN COUNTY ENGINEER

b.17

RESOLUTION NO. 16-552

In the matter of authorizing various applications to )  
OPWC for the Lorain County Engineer's Department)  
for various projects in Lorain County, Ohio. )

August 31, 2016

WHEREAS, Ken Carney Lorain County Engineer by letter dated August 23, 2016 submitted the following:

"The Ohio Public Works Commission District 9 Integrating Committee has announced that preliminary funding applications are due on September 2, 2016. The Office of the Lorain County Engineer has reviewed its capital improvement program and is recommending that the following projects be submitted for funding assistance:

1. Oberlin Road Resurfacing  
Estimated Project Cost \$1,144,299.00  
OPWC Funding Request \$1,018,426.00  
Funding will be made available from the MVGT Account Engineering Projects and the City of Oberlin for the local share.
2. Jones Road Bridge #0223 & #0275 Replacement  
Estimated Project Cost \$198,400.00  
OPWC Funding Request \$145,000.00  
Funding will be made available from the MVGT Account Engineering Projects for the local share.
3. Kipton Nickle Plate Bridge #0184 Replacement  
Estimated Project Cost \$350,000.00  
OPWC Funding Request \$311,500.00  
Funding will be made available from the MVGT Account Engineering Projects for the local share.

At this time, the Lorain County Engineering is requesting authority to prepare, sign and submit funding applications for the above listed projects. Thank you for your cooperation in this matter and please feel free to contact this office if you should have any questions or comments.";

NOW THEREFORE, BE IT RESOLVED by the Lorain County Board of Commissioners that based upon the letter dated August 23, 2016 from Ken Carney, Lorain County Engineer we hereby authorize various applications to OPWC for the Lorain County Engineer's Department for various projects in Lorain County as stated above.

BE IT FURTHER RESOLVED, we hereby authorize the County Engineer to execute on behalf of the Board and the local share and loan repayments will be made as stated above.

Motion by Lundy, seconded by Kalo to adopt Resolution. Upon roll call the vote taken thereon, resulted as: Ayes: all.

Motion carried.

I, Theresa L. Upton, Clerk to the Lorain County Board of Commissioners do hereby certify that the above Resolution No. 16-552 is a true copy as it appears in Journal No. 16 on date of August 31, 2016.

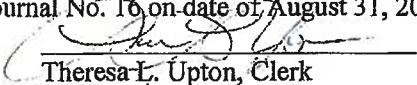
  
Theresa L. Upton, Clerk